

ALLDAY
& MILLER



Oakleigh Road, Uxbridge, UB10 9EL
£340,000





Oakleigh Road, Uxbridge, UB10 9EL

£340,000

- First Floor Maisonette
- Good Condition Throughout
- Large Private Rear Garden
- Catchment Area for Highly Regarded Local Schools
- 160 Year Lease
- Two Bedroom
- Allocated Parking
- Sought After Oak Farm Location
- No Service Charge or Ground Rent
- Short Walk to Hillingdon Underground Station & Amenities

Description

This delightful house offers a perfect blend of comfort and modern living. Upon entering, you are welcomed into a bright and airy reception/dining room, a modern fitted kitchen, two spacious bedrooms and a family bathroom.

Outside, the property boasts a front drive that provides convenient parking for residents, a valuable feature in this area. The rear garden is a true highlight, mainly laid to lawn, offering the perfect space for outdoor dining and entertainment.

Situation

Oakleigh Road is a sought after road within the ever popular Oak Farm estate which is renowned for its easy access to highly regarded schools including St. Bernadettes, Oak Farm and Ryefield primary schools and Oakwood and Swakeleys secondary schools. The property is within easy reach of local shops, bus links, the A40 and Hillingdon Tube station, which both provide a direct route into central London along with the Elephant Park and nature reserve. Uxbridge town centre with its wide range of shopping facilities is just a short trip away by bus or car.



Floor Plans

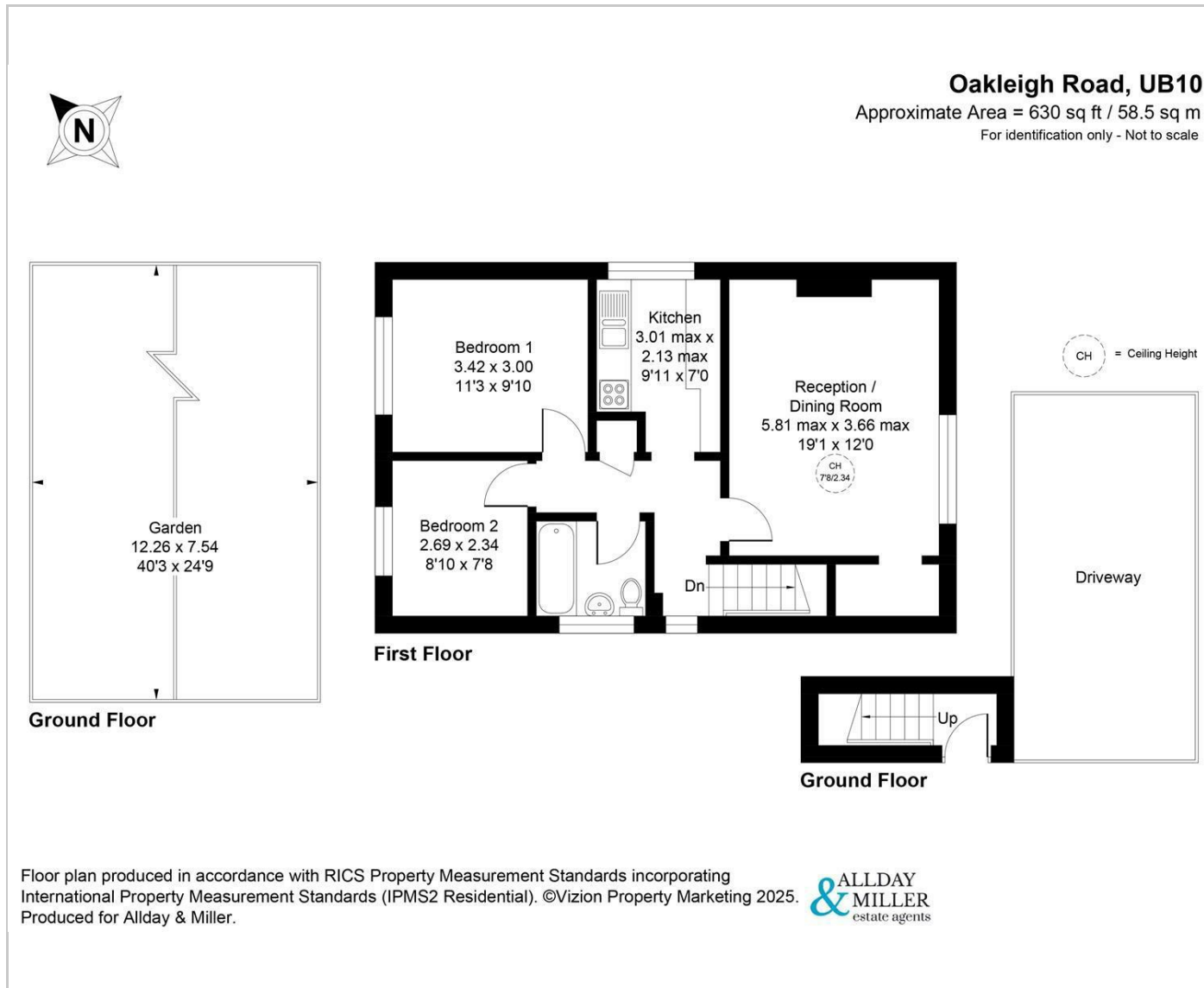

Area Map

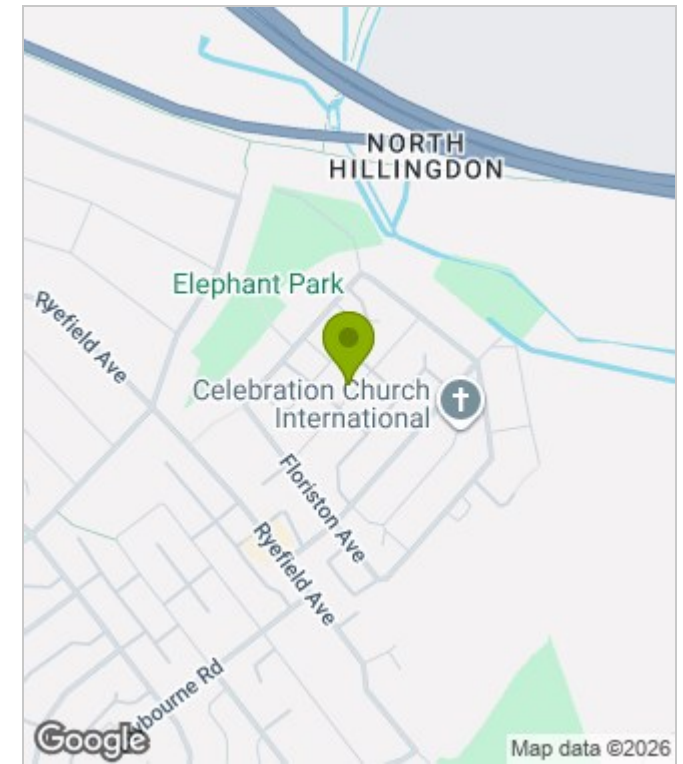

Energy Performance Graph

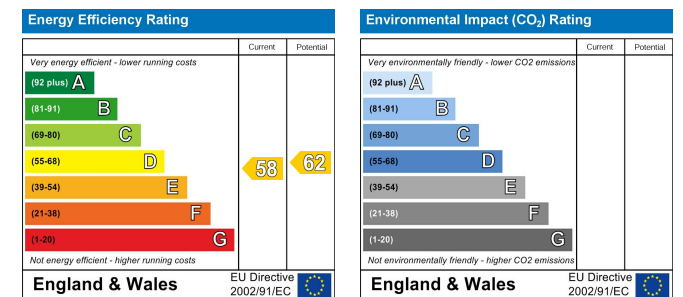

These particulars, whilst believed to be accurate are set out as a general outline only for guidance and do not constitute any part of an offer or contract. Intending purchasers should not rely on them as statements of representation of fact, but must satisfy themselves by inspection or otherwise as to their accuracy. No person in this firm's employment has the authority to make or give any representation or warranty in respect of the property.