

ALLDAY
& MILLER

Sedley Grove, Uxbridge, UB9 6JB
£250,000





Sedley Grove, Uxbridge, UB9 6JB

£250,000

- Ground Floor Maisonette
- Share of Freehold
- Private Rear Garden
- Side Access to Garden
- Walking Distance To Local Amenities
- One Double Bedroom
- Modern Bathroom
- Good Condition Throughout
- Parking
- Close to Transport Links

Description

This delightful home offers a perfect blend of comfort and modern living. The property features a well appointed reception and dining space, providing an inviting space for relaxation and entertaining, the sleek fitted kitchen is designed with both style and functionality in mind, a spacious double bedroom and a modern bathroom.

To the rear boasts a private secluded garden mainly laid to lawn with a patio area, perfect for outside dining and entertainment.

Situation

Sedley Grove situated close to Harefield Village and its shops and amenities. Harefield is surrounded by some beautiful countryside along the Grand Union Canal and it is well placed for an abundance of activities such as walking/hiking, fishing, horse riding, football, cricket and golf. For the commuter, there is access into London on the Chiltern Line at Denham and Rickmansworth and the underground stations at Uxbridge, Rickmansworth, Ruislip and Northwood. Bus routes also towards Uxbridge, Rickmansworth, Ruislip and Northwood. Easy motorist access to the A/M40 and M25. There are a number of highly regarded schools in the local area including Harefield Junior school and Harefield Academy.



Floor Plans

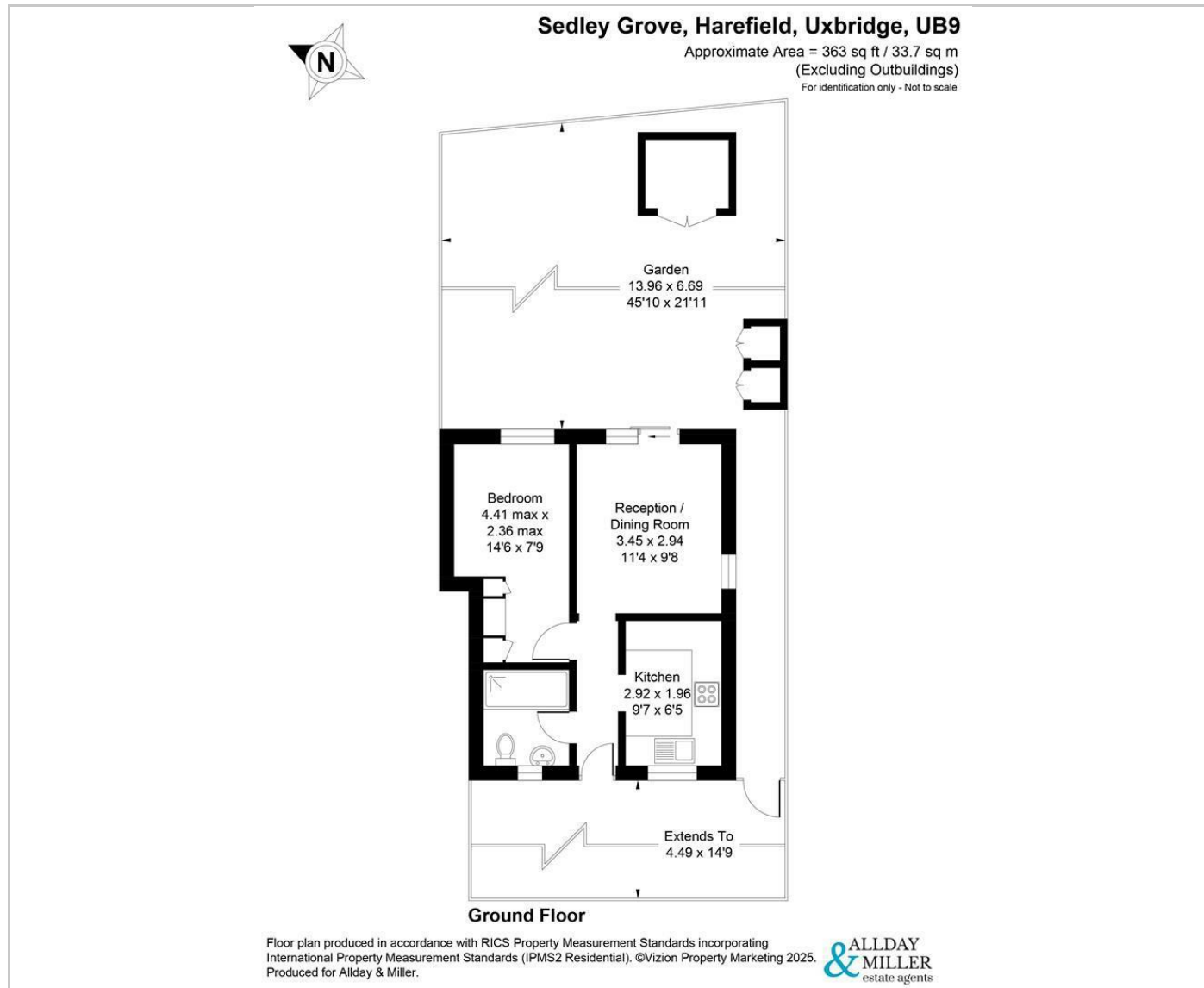

Area Map



Energy Performance Graph

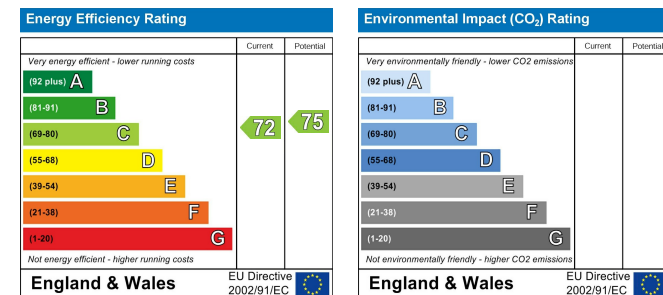

These particulars, whilst believed to be accurate are set out as a general outline only for guidance and do not constitute any part of an offer or contract. Intending purchasers should not rely on them as statements of representation of fact, but must satisfy themselves by inspection or otherwise as to their accuracy. No person in this firm's employment has the authority to make or give any representation or warranty in respect of the property.