

ALLDAY
& MILLER

Braybourne Close, Uxbridge, UB8 1UJ
£500,000

4 2 2 D



Braybourne Close, Uxbridge, UB8 1UJ

£500,000

- Four Bedrooms
- Stunning River Views
- No Onwards Chain
- Permit Parking
- Walking Distance to Uxbridge Station
- Townhouse
- Two Reception Rooms
- Open Plan Kitchen/Diner
- Uxbridge Town Centre
- EPC Rating - D

Description

This charming family home offers a perfect blend of comfort and modern living. The property boasts a well-designed layout, featuring a spacious reception room on the lower ground floor, ideal for family gatherings or entertaining guests.

As you ascend to the raised ground floor you will find a bedroom, a convenient downstairs WC, and a fitted kitchen with a reception/dining room.

The first floor is dedicated to rest and relaxation, comprising three well-proportioned bedrooms that offer ample space for family members or guests. A modern bathroom completes this level.

To the rear of the property is a private garden providing an excellent outdoor space for dining and entertainment.

Situation

Braybourne Close is conveniently positioned in Uxbridge Town centre with its multitude of shops, restaurants, bars and cafes along with the Metropolitan/Piccadilly Line Station giving easy links to central London . For the commuters the A40 and M25 are also nearby, as well as Heathrow Airport, Brunel University and Hillingdon Hospital. A number of high regarded schools in the local area including Hermitage Primary school and Uxbridge High secondary schools.

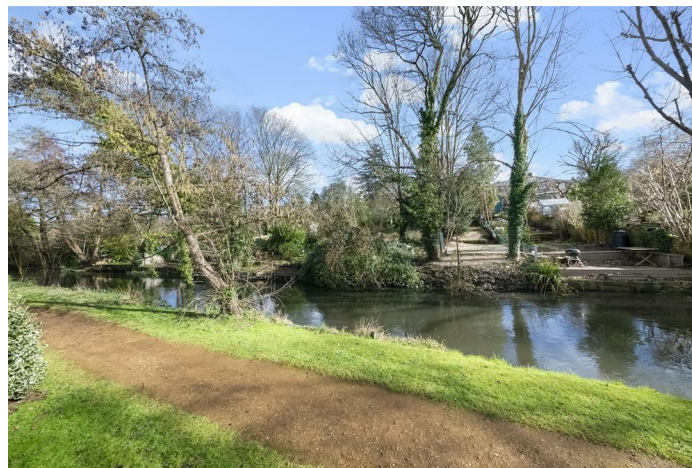

Floor Plans

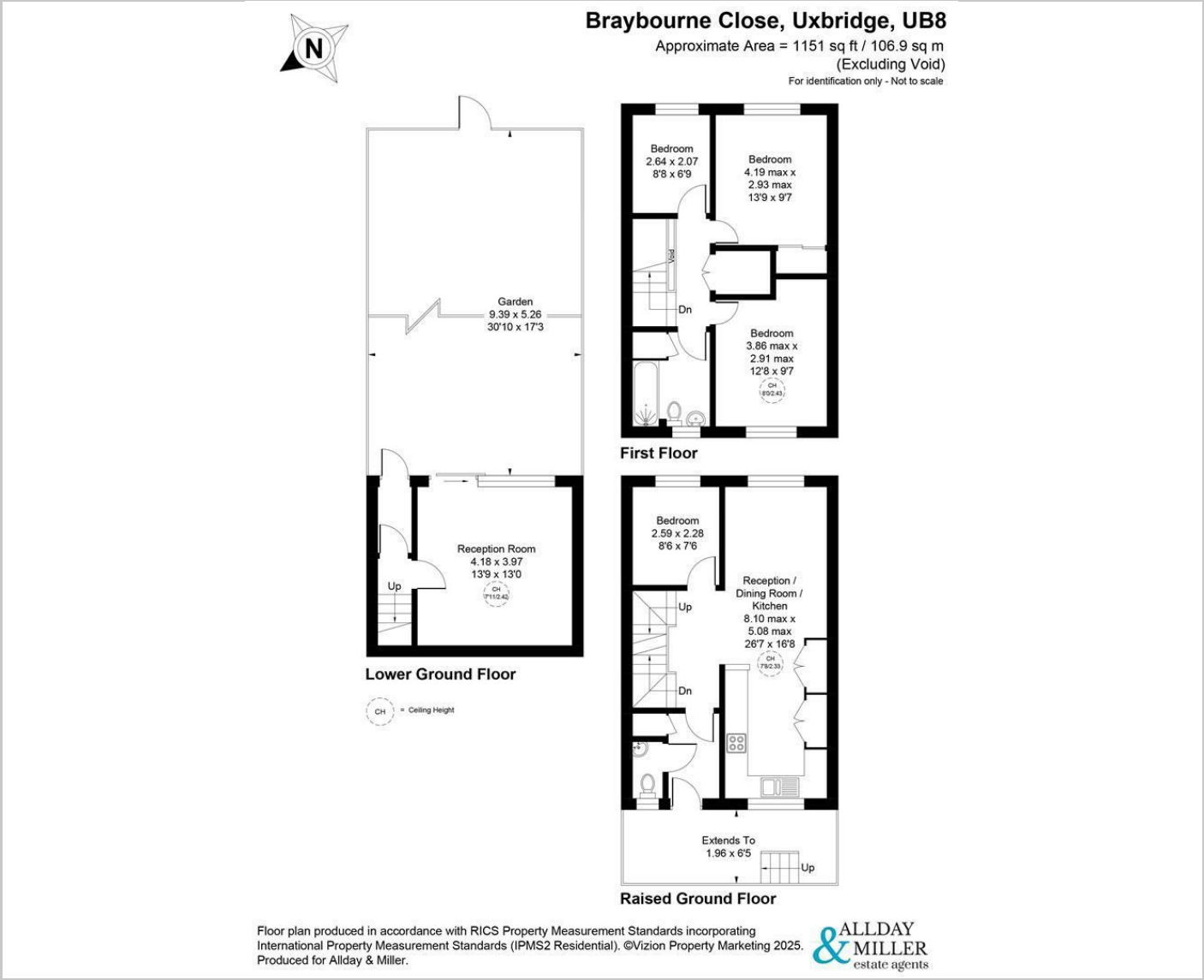

Area Map

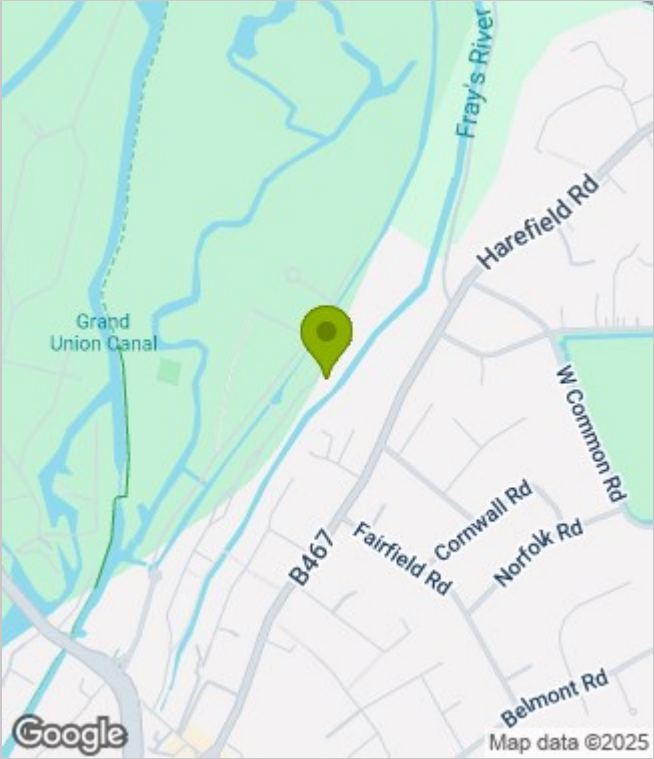

Energy Performance Graph

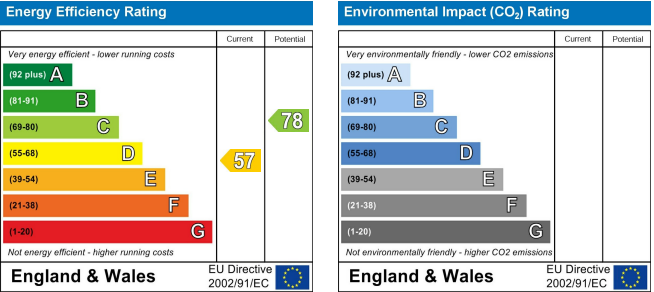

These particulars, whilst believed to be accurate are set out as a general outline only for guidance and do not constitute any part of an offer or contract. Intending purchasers should not rely on them as statements of representation of fact, but must satisfy themselves by inspection or otherwise as to their accuracy. No person in this firms employment has the authority to make or give any representation or warranty in respect of the property.