

ALLDAY
& MILLER



Denham Way, Denham, UB9 5AX
£950,000

4 3 2 C



Denham Way, Denham, UB9 5AX

£950,000

- Four Bedroom Semi Detached
- Off Street Parking for Multiple Vehicle's
- Fully Equipped Office
- Nearby to Highly Regarded Schools
- Outhouse/ Bar/ Pub to Rear
- Three Stylish Bathrooms
- Master Bedroom with En Suite
- Walking Distance to Denham Village
- Quiet Residential Road
- Extended Open Plan Kitchen Diner with Underfloor Heating

Description

Nestled in the charming area of Denham Way, this exquisite four-bedroom semi-detached home offers a perfect blend of modern living and traditional comfort. The property boasts two spacious reception rooms, providing ample space for both relaxation and entertaining guests. The heart of the home is undoubtedly the extended open-plan kitchen, which is designed to cater to the needs of contemporary family life, making it an ideal space for cooking and socialising.

With three well-appointed bathrooms, this residence ensures convenience and privacy for all family members and guests. Each bedroom is generously sized, allowing for comfortable living and personal space. The property is presented in stunning condition, reflecting a meticulous attention to detail and a commitment to quality.

Outside, the garden features a unique bar or pub area, perfect for hosting summer gatherings or enjoying a quiet evening under the stars. Additionally, the property offers parking for up to three vehicles, a valuable asset in this desirable location.

This semi-detached home on Denham Way is not just a place to live; it is a lifestyle choice that combines elegance, functionality, and a welcoming atmosphere. Whether you are a growing family or looking for a spacious retreat, this property is sure to impress. Do not miss the opportunity to make this stunning house your new home.

Situation

Situated within walking distance is Denham Village's vast array of country pubs and stunning walks through Denham Country park, offering easy access of Denham Green's local shops and mainline station (fast train to Marylebone). For the motorist the A40/M40/M25 motorway is situated only a few moments away giving easy access to London and the Home counties. The property is also well positioned giving excellent access to a range of outstanding primary and secondary schools. The larger centres of Gerrard's Cross and Uxbridge and their excellent array of shops and transport links are also within easy access by car or public transport.

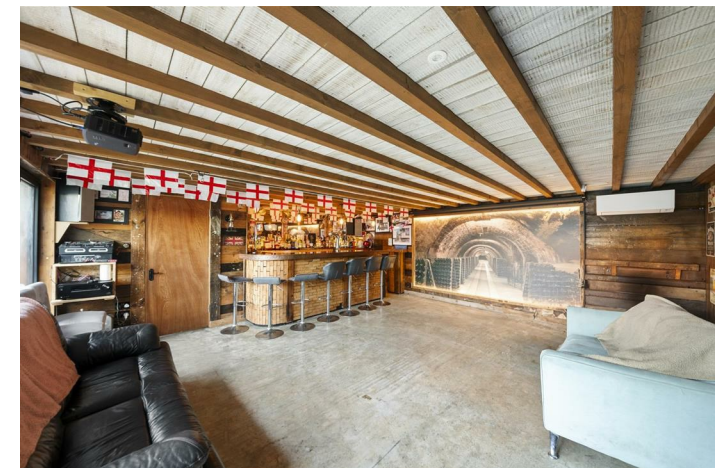

Floor Plans

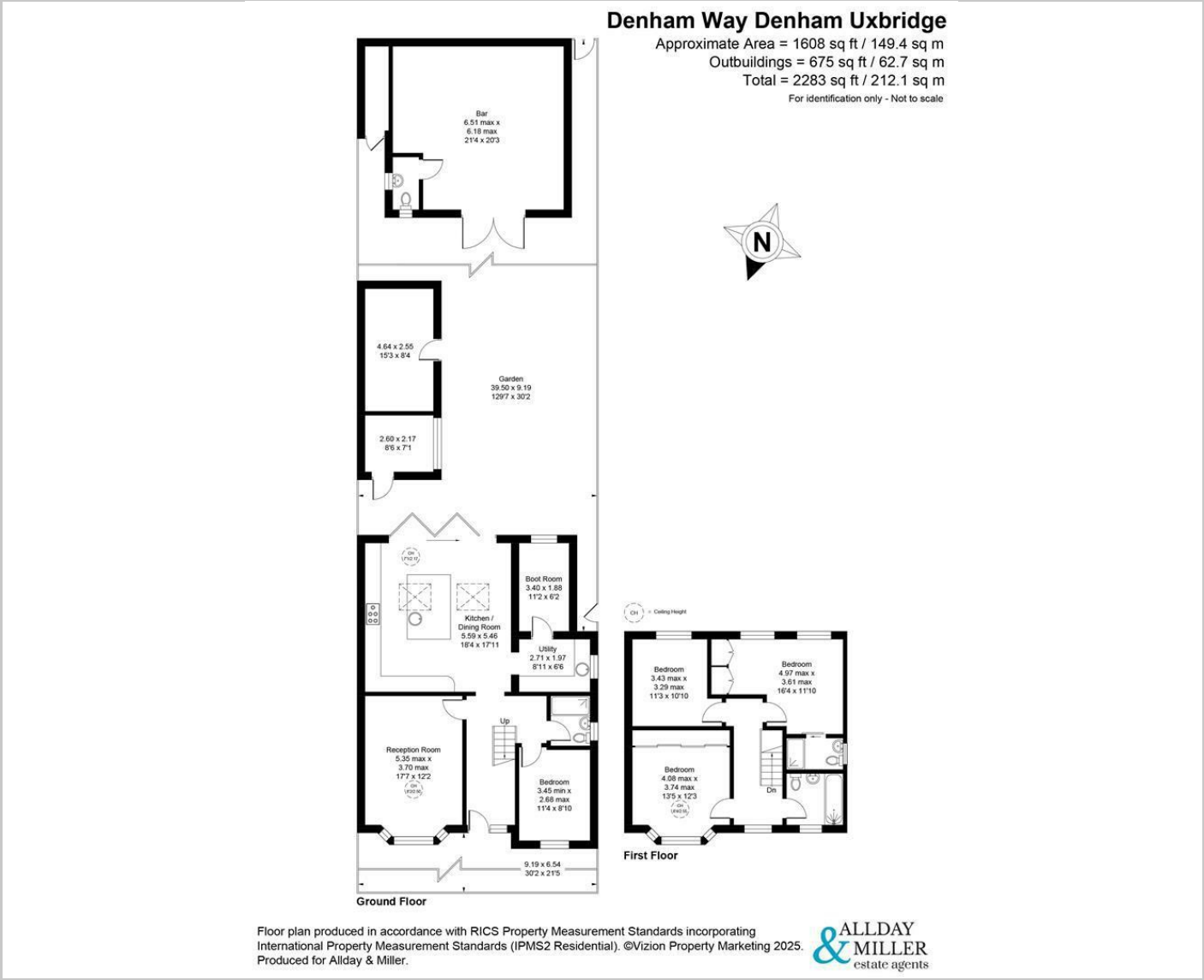

Area Map

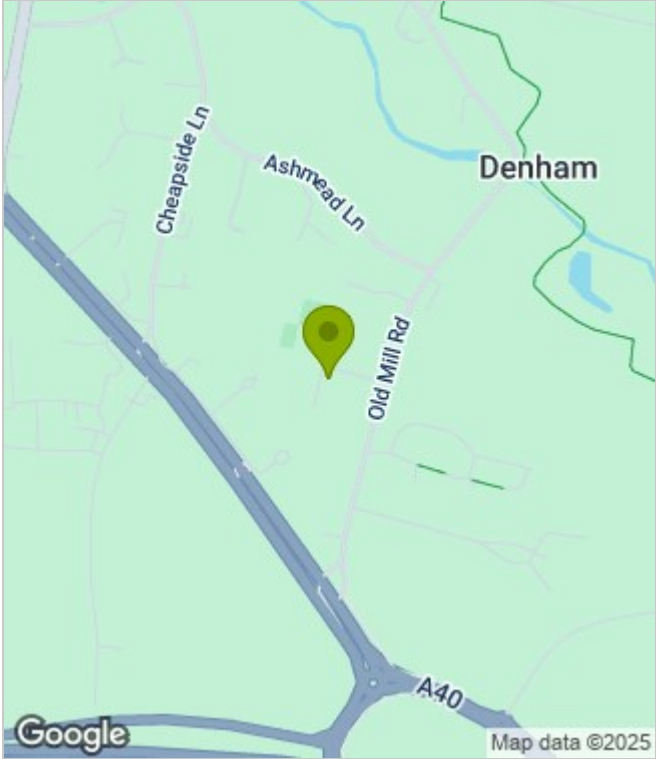

Energy Performance Graph

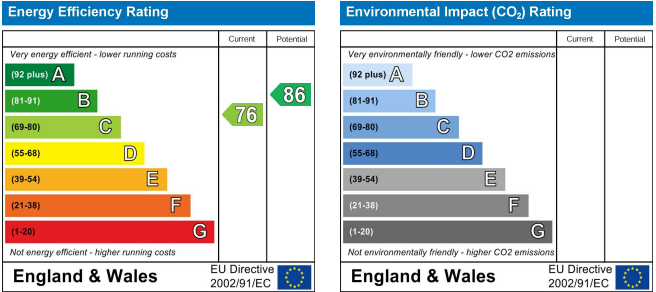

These particulars, whilst believed to be accurate are set out as a general outline only for guidance and do not constitute any part of an offer or contract. Intending purchasers should not rely on them as statements of representation of fact, but must satisfy themselves by inspection or otherwise as to their accuracy. No person in this firm's employment has the authority to make or give any representation or warranty in respect of the property.