

ALLDAY
& MILLER



Nine Stiles Close, Uxbridge, UB9 4BA
£450,000

2 1 1 D



Nine Stiles Close, Uxbridge, UB9 4BA

£450,000

- Two Bedrooms
- Quiet Cul De Sac
- Scope for Further Extension (STPP)
- Good Condition Throughout
- Easy Access To M40 & M25
- One Bathroom
- No Upper Chain
- Close To Uxbridge Town Centre
- Semi Detached
- Off Street Parking

Description

Versatile and spacious this family home comprises of a welcoming entrance porch, a light filled reception/ dining room, a modern fitted kitchen with patio doors giving access to the garden.

To the first floor enjoys two bedrooms (master with fitted wardrobes and ample of storage space).

Externally there is a front driveway with space for off street parking. To the rear enjoys a private garden mainly laid to lawn with a patio area, perfect for outside dining and entertainment.

Situation

Nine Stlies Close is a small cul-de-sac nestled away just off the Oxford Road in New Denham. The property is positioned just a short stroll from Uxbridge Town Centre and all it's amenities, including multiple shopping facilities, restaurants, bars, coffee shops, gyms and a cinema. Also the Metropolitan/Piccadilly line tube station making the journey into central London a breeze. The A40/M40 and M25 are within easy reach along with Hillingdon Hospital, Brunel University, Stockley Business Park and Heathrow airport. The area is served by a number of highly regarded schools including St Marys Catholic Primary school and Uxbridge High school.



Floor Plans

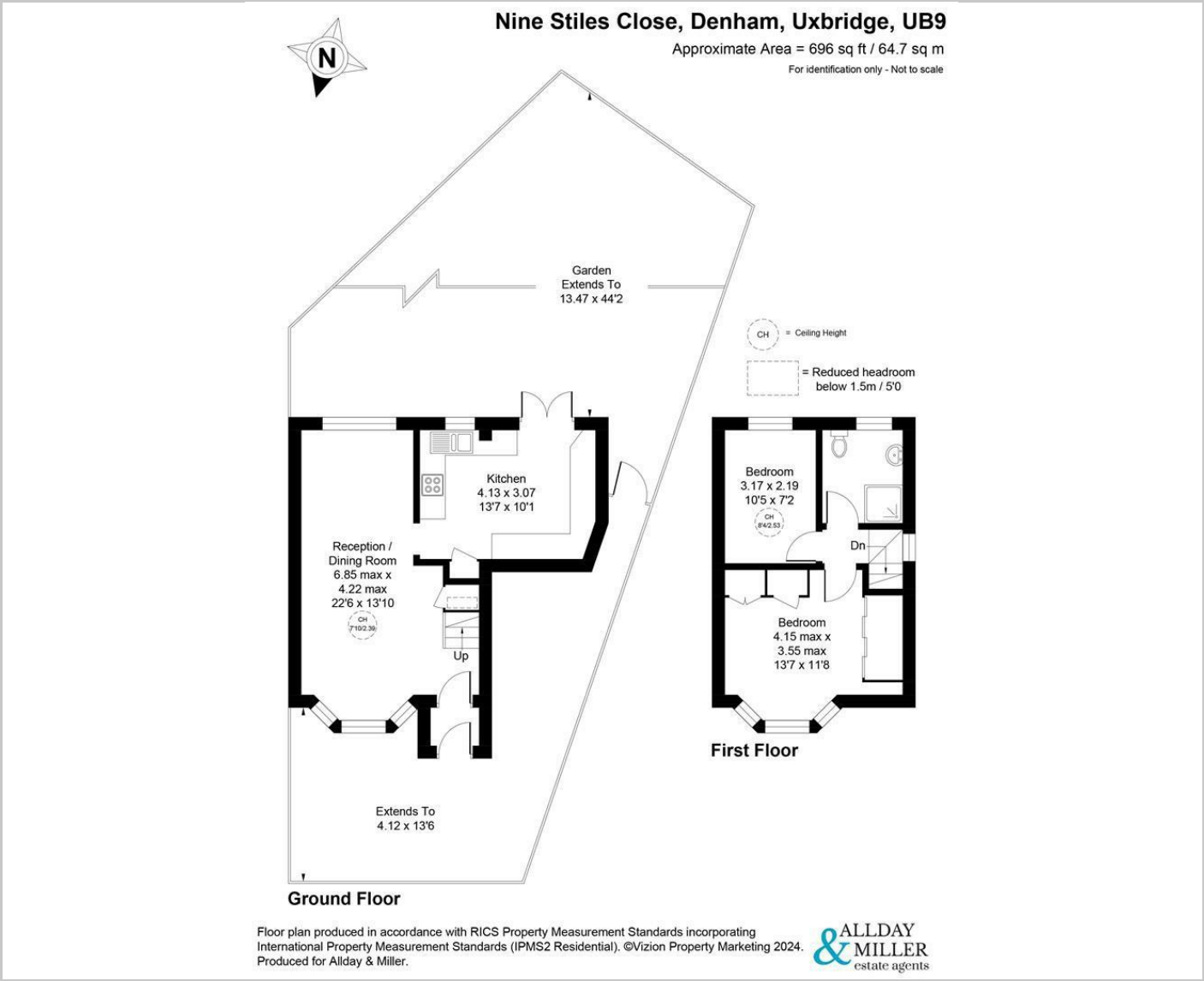

Area Map

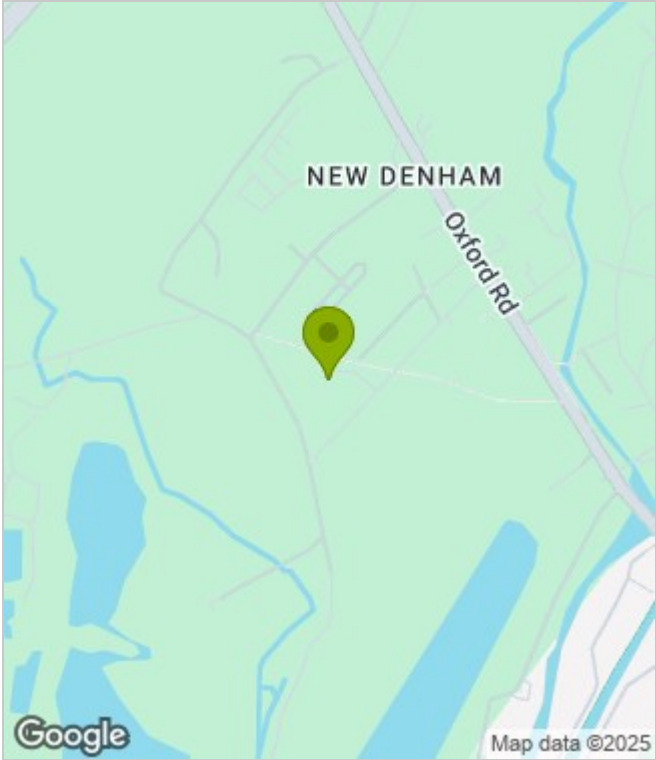

Energy Performance Graph

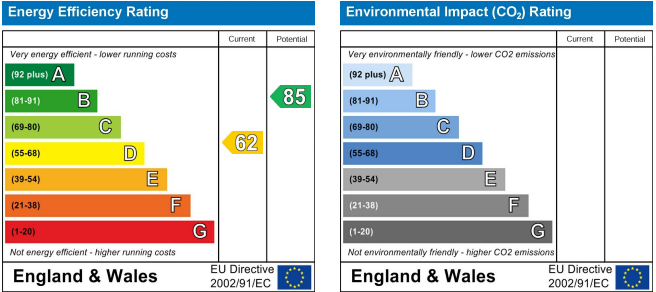

These particulars, whilst believed to be accurate are set out as a general outline only for guidance and do not constitute any part of an offer or contract. Intending purchasers should not rely on them as statements of representation of fact, but must satisfy themselves by inspection or otherwise as to their accuracy. No person in this firms employment has the authority to make or give any representation or warranty in respect of the property.