

ALLDAY
& MILLER

Maylands Drive, Uxbridge, UB8 1BH
£995,000

3 3 2 C



Maylands Drive, Uxbridge, UB8 1BH

£995,000

- Three Bedrooms
- Three Bathrooms
- Stunning Rear Garden
- Large Plot with Huge Potential
- Swimming Pool House in Garden with Shower & Toilet
- Planning Approved for Double Storey Extension - 19822/APP/2020/373
- Garage Via Own Driveway with EV Charger Fitted
- Walking Distance to Uxbridge Town Centre & Station
- Desirable Road In North Uxbridge
- 2800+ Sq Ft

Description

This stunning property brought to the market comprises of a welcoming entrance hall, spacious reception room, fitted kitchen/dining room, a conservatory, study/ guest room and a downstairs bathroom.

The first floor boasts three bedrooms and a family bathroom.

A large front drive way benefitting from off street parking for multiple vehicles , also gives access to the garage. To the rear enjoys a large private garden mainly laid to lawn, with an outbuilding a heated swimming pool, shower room and WC.

Situation

Maylands Drive is situated on the North side of Uxbridge, a short walk to the High Street that offers two shopping mall's, numerous restaurants, cocktail bar's, gyms and a cinema. For the commuters Uxbridge Tube Station offers Metropolitan and Piccadilly line services into Central London. Other amenities close by include Brunel University, Hillingdon Hospital and Stockley Business Park. The area is served by many highly regarded schools including Vyners secondary school and Hermitage primary school.



Floor Plans

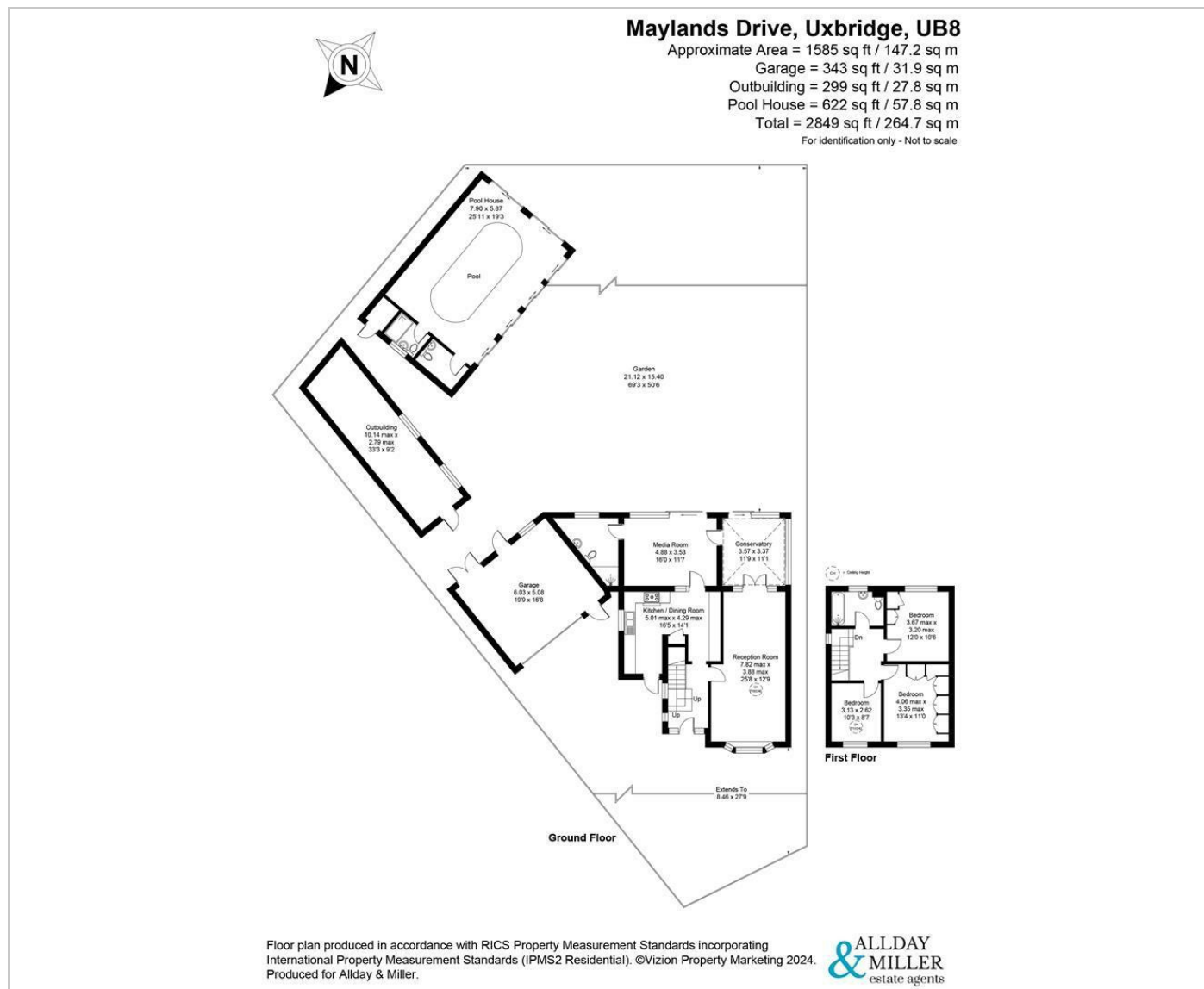

Area Map

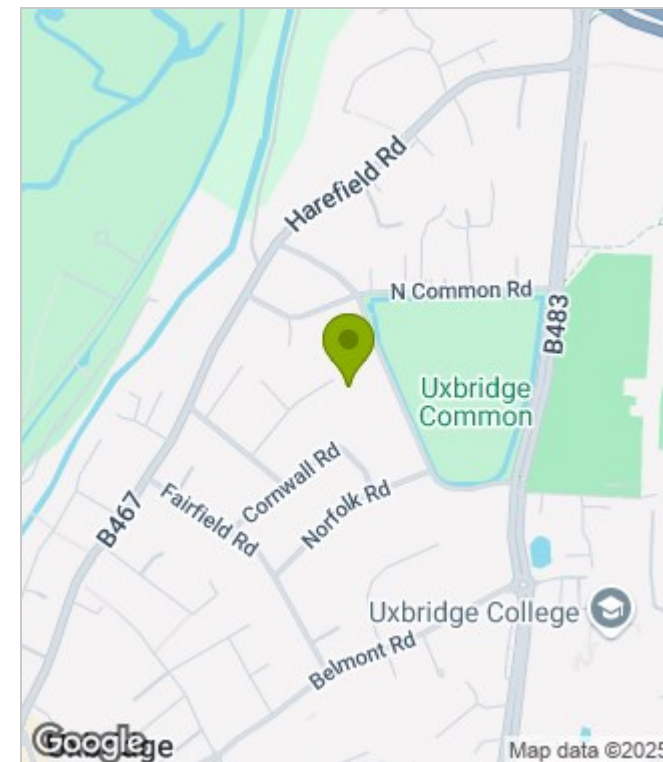

Energy Performance Graph

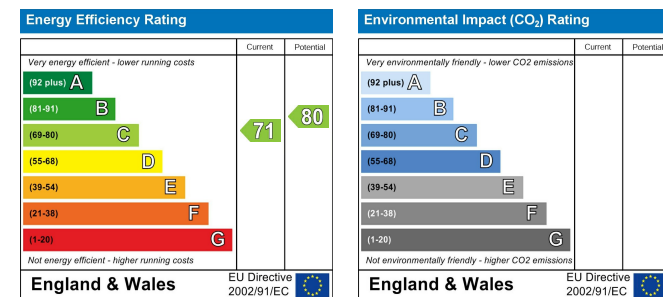

These particulars, whilst believed to be accurate are set out as a general outline only for guidance and do not constitute any part of an offer or contract. Intending purchasers should not rely on them as statements of representation of fact, but must satisfy themselves by inspection or otherwise as to their accuracy. No person in this firm's employment has the authority to make or give any representation or warranty in respect of the property.