

ALLDAY
& MILLER



Milton Road, Ickenham, UB10 8NU
£200,000





Milton Road, Ickenham, UB10 8NU

£200,000

- One Bedroom Apartment
- Sought After Road
- Communal Gardens
- Easy Access to A40/M25
- Allocated Parking
- Period Conversion
- Remaining Lease of 55 Years
- Ideal First Time Buy or Investment
- Walking Distance to Ickenham Village
- No Upper Chain

Description

This one bedroom apartment is nestled on Milton Road in the heart of Ickenham village in the highly sought after Heath House conversion.

The apartment is an ideal first time buyers or investment and the accommodation on offer comprises of a welcoming entrance hall, spacious reception/ dining room with a private balcony overlooking views of the communal gardens, a bathroom, kitchen and a double bedroom.

The property is surrounded by scenic communal gardens, ideal for outside entertainment. Also the added benefit of an allocated parking space.

The lease remaining on this flat is 55 years.

Situation

Milton Road is a peaceful tree lined residential road in Ickenham. Located in close proximity to Ickenham High Street which offers a superb range of fashionable shops, cafes and restaurants whilst pleasant open parkland space is only a short stroll away. Ickenham station (Metropolitan / Piccadilly lines) is a short walk away providing reliable links into the City and West End. Alternatively West Ruislip station is serviced by both tube (Central line) and train lines into Marylebone Station in just 25 minutes, with regular trains every 15 minutes. For the motorist the A40 is a short drive away providing access to Central London and the Home Counties. For families, there are a number of highly regarded schools that cater for children of all ages within close proximity including Breakspear and Vyners Senior School, along with a number of leisure facilities including Uxbridge Golf Club, Ruislip Bowls Club and Riverside Health and Raquets Club.



Floor Plans

Heath House, Milton Road, Uxbridge, UB10

Approximate Area = 428 sq ft / 39.8 sq m

For identification only - Not to scale

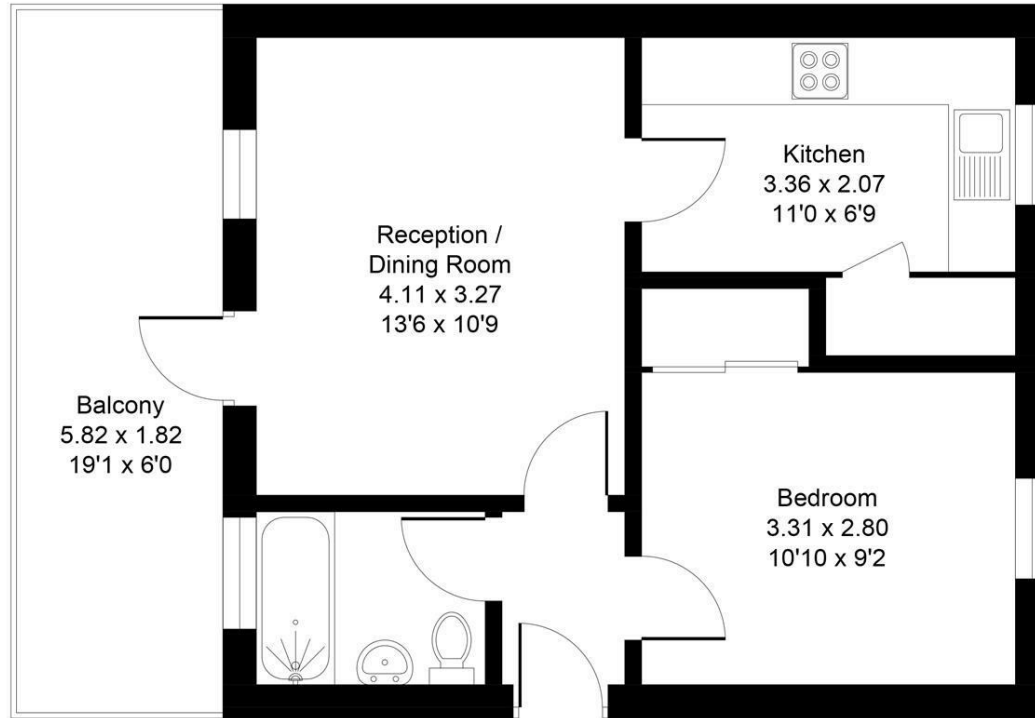

First Floor

Floor plan produced in accordance with RICS Property Measurement Standards incorporating International Property Measurement Standards (IPMS2 Residential). ©Vizion Property Marketing 2024. Produced for Allday & Miller.

ALLDAY & MILLER
estate agents

Area Map

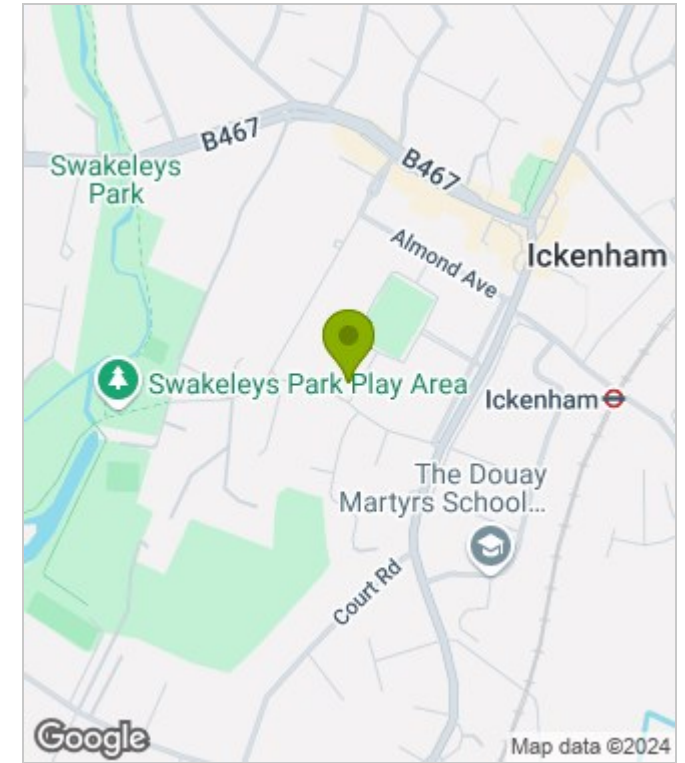

Energy Performance Graph

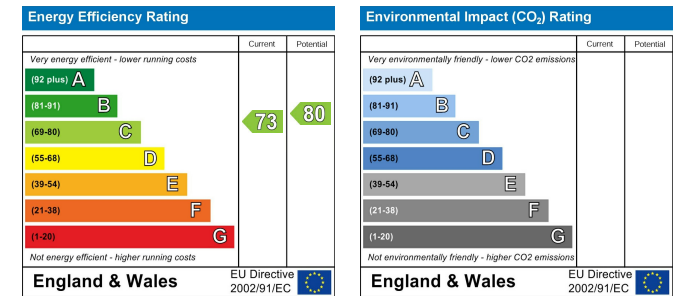

These particulars, whilst believed to be accurate are set out as a general outline only for guidance and do not constitute any part of an offer or contract. Intending purchasers should not rely on them as statements of representation of fact, but must satisfy themselves by inspection or otherwise as to their accuracy. No person in this firm's employment has the authority to make or give any representation or warranty in respect of the property.

www.alldayandmiller.co.uk

192 High Street, Uxbridge, Middlesex, UB8 1LB

T: 01895 641 000 | E: sales@alldayandmiller.co.uk
T: 01895 379 549 | E: lettings@alldayandmiller.co.uk