

ALLDAY
& MILLER



Curran Close, Uxbridge, UB8 2JU
£255,000

 1  1  1  C



Curran Close, Uxbridge, UB8 2JU

£255,000

- One Bedroom
- Allocated Parking Space
- Extended Lease - 144 Years
- Ideal First Home or Investment
- Close to Uxbridge & West Drayton
- First Floor
- 596 sq ft
- Quiet Cul De Sac Location
- Good Condition Throughout
- EPC Rating - C

Description

Ideal for investment or first time buyers this property presented in clean and tidy condition throughout comprises of stairs leading to the first floor, spacious reception room with ample of natural lighting, double bedroom with fitted wardrobes, modern fitted kitchen and to complete with a family bathroom suite.

Other benefits include an allocated parking space, low maintenance communal gardens, close to Uxbridge town centre and EPC rating C.

Situation

Curran Close is situated just off Iver Lane and is close to a number of local amenities including Hillingdon Hospital, Brunel University and Stockley business park. There are a number of bus/road links close by creating easy access to Heathrow Airport, the M4 and M25 and Uxbridge town centre with its multitude of shops, restaurants, bars and Piccadilly/Metropolitan line train station.



Floor Plans

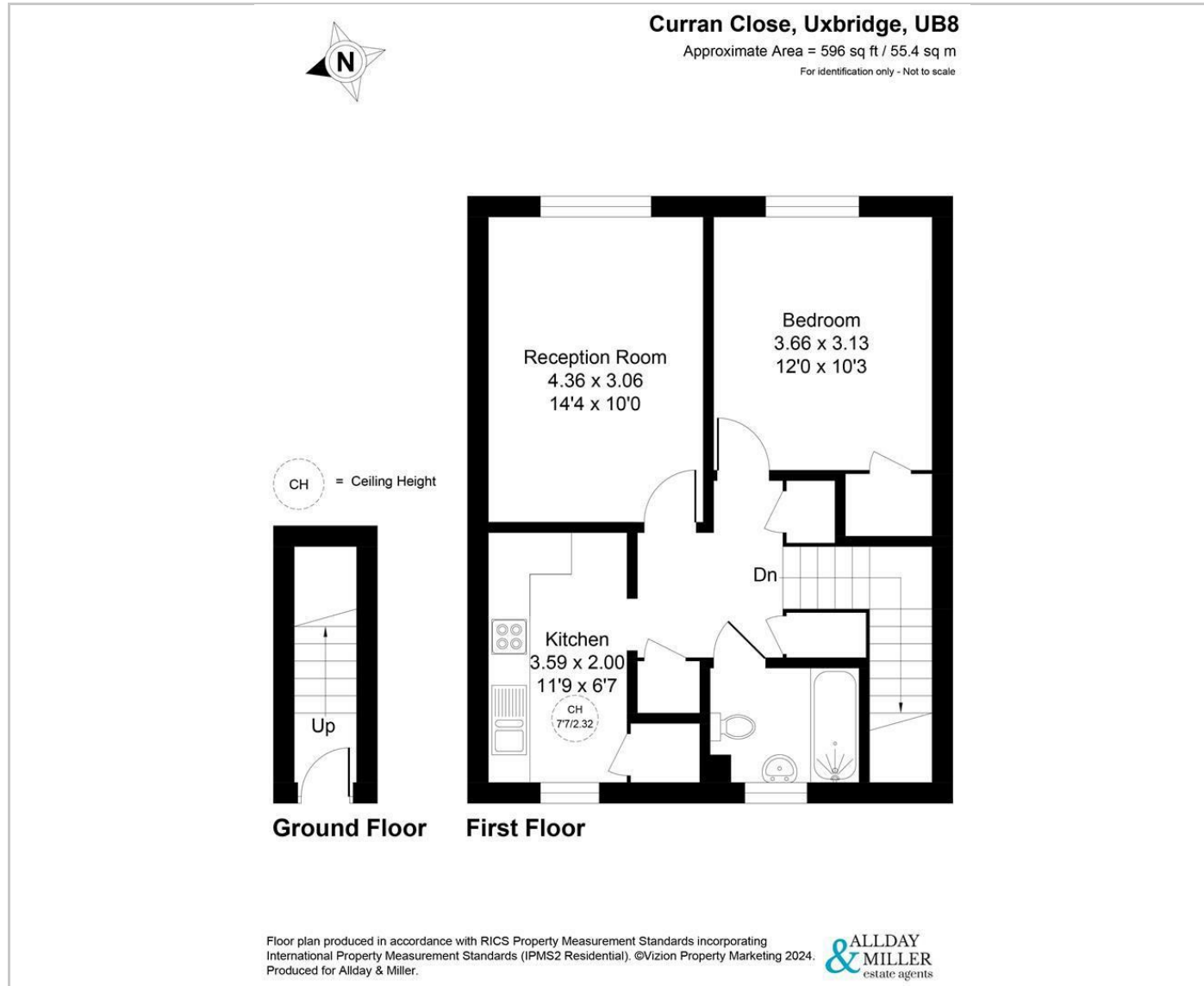

Area Map

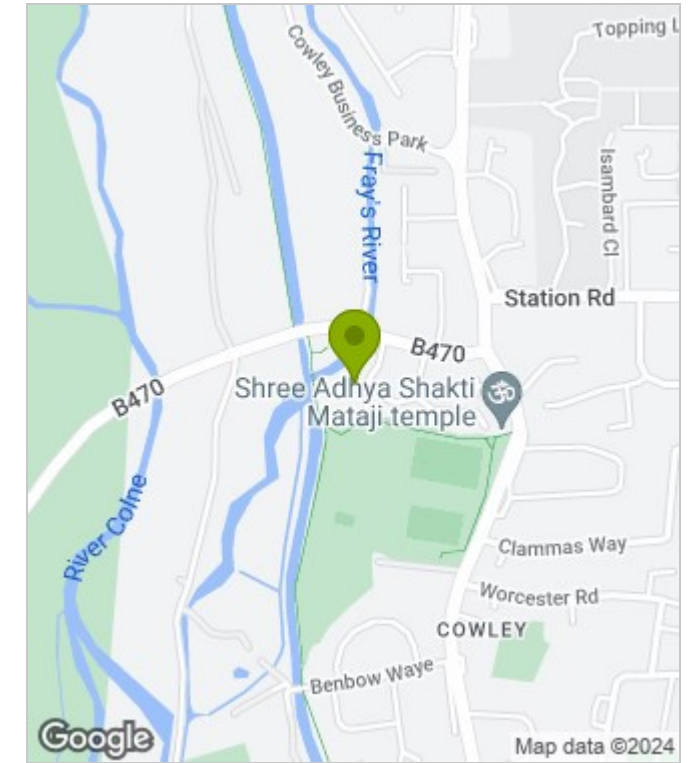

Energy Performance Graph

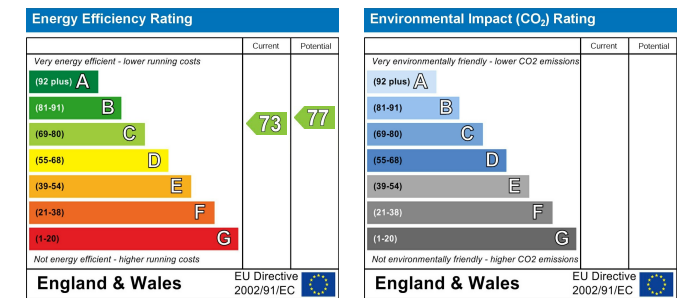

These particulars, whilst believed to be accurate are set out as a general outline only for guidance and do not constitute any part of an offer or contract. Intending purchasers should not rely on them as statements of representation of fact, but must satisfy themselves by inspection or otherwise as to their accuracy. No person in this firm's employment has the authority to make or give any representation or warranty in respect of the property.

www.alldayandmiller.co.uk

192 High Street, Uxbridge, Middlesex, UB8 1LB

T: 01895 641 000 | E: sales@alldayandmiller.co.uk
 T: 01895 379 549 | E: lettings@alldayandmiller.co.uk