

ALLDAY
& MILLER



Edwards Avenue, Ruislip, HA4 6UP
£585,000

3 1 2 D



Edwards Avenue, Ruislip, HA4 6UP

£585,000

- Three Bedrooms
- Walking Distance to South Ruislip Station
- Two Reception Rooms
- Short Drive TO M40/ M25/ M4
- Nearby to Highly Regarded Schools
- Semi Detached
- Off Street Parking for Multiple Vechiles
- Private Rear Garden
- Potential for Extensions (Subject to Planning)
- No Upper Chain

Description

This well presented property on offers provides versatile family living space which comprises of a welcoming entrance, spacious reception room filled with an abundance of natural light, fully fitted kitchen, a dining room with perfect views over the private rear garden.

The first floor boasts a spacious landing with doors to three generously sized bedrooms and a family bathroom suite.

To the front a paved driveway creating space for off street parking. The rear has a large garden that has been mainly laid to lawn with a patio area perfect for outside dining and entertaining with a shed, ideal for extra storage space.

Situation

Edwards Avenue is a quiet residential road enjoying its setting close to parks and amenities at South Ruislip, Ruislip Manor and Eastcote. Local transport links are available from nearby South Ruislip train station offering the Central Line into London along with the National Rail service into London Marylebone. South Ruislip station is a short walk away and is useful for the Metropolitan/Piccadilly line providing reliable links into the City and West End. For the motorist the A40/M25 is nearby whilst for families, there are a number of highly regarded schools that cater for children of all ages within close proximity including St Swithun Wells, Ruislip High, Deanesfield Primary School and Queensmead Secondary school. There is a new development in South Ruislip which has both shops, restaurants and a cinema which is fantastic for families and couples alike.



Floor Plans

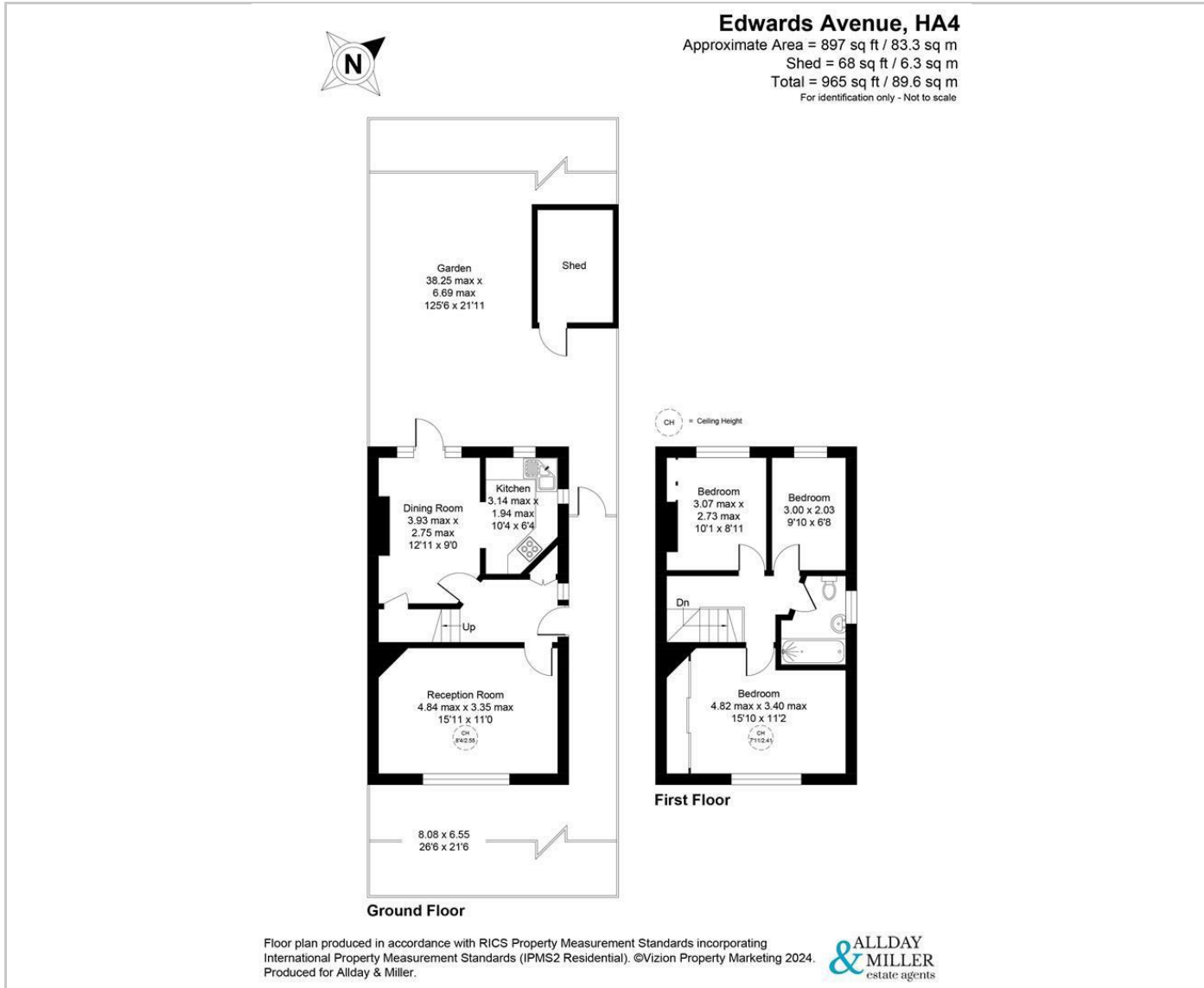

Area Map

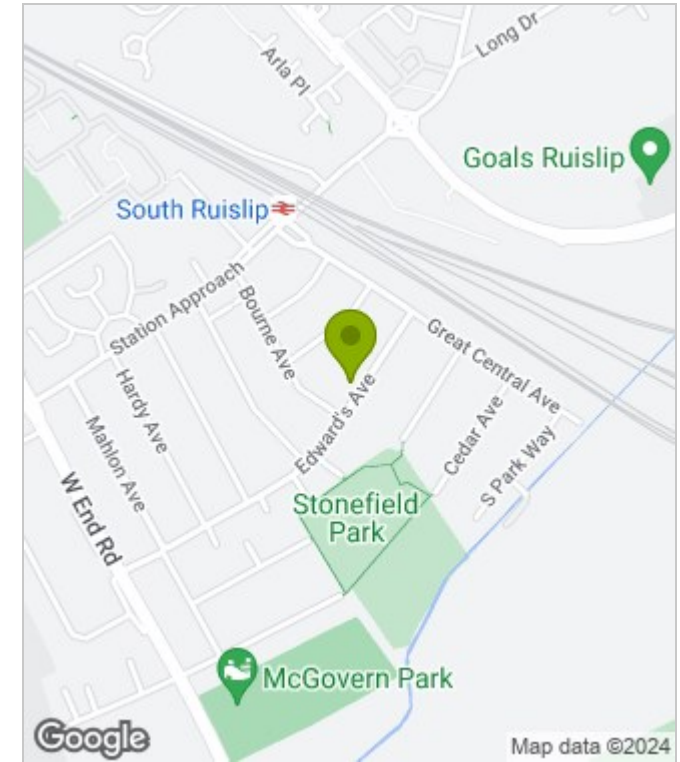

Energy Performance Graph

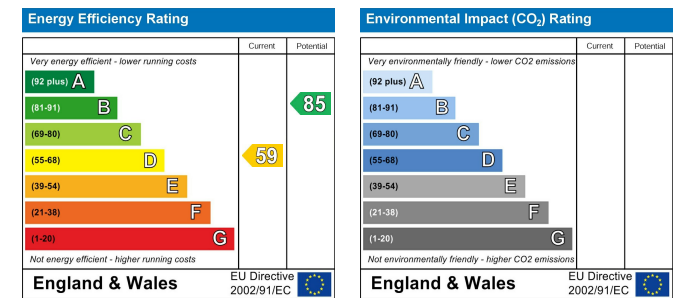

These particulars, whilst believed to be accurate are set out as a general outline only for guidance and do not constitute any part of an offer or contract. Intending purchasers should not rely on them as statements of representation of fact, but must satisfy themselves by inspection or otherwise as to their accuracy. No person in this firm's employment has the authority to make or give any representation or warranty in respect of the property.

www.alldayandmiller.co.uk

192 High Street, Uxbridge, Middlesex, UB8 1LB

T: 01895 641 000 | E: sales@alldayandmiller.co.uk
 T: 01895 379 549 | E: lettings@alldayandmiller.co.uk