

THE Longs PUB

High St, Steeple Ashton, BA14 6EU



PROMINENT GRADE II LISTED Public House IN STEEPLE ASHTON

savills



Longs Arms

THE LONGS ARMS STEEPLE ASHTON

HIGHLIGHTS INCLUDE:



Situated in a scenic village, 12 miles southeast of Bath.



Recently extended and refurbished public house with modern facilities

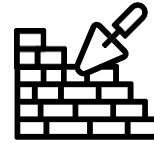

Potential to convert unused barn and bring additional space into owners/letting accommodation

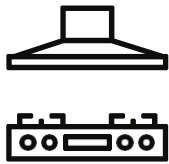

Large fully fitted commercial kitchen

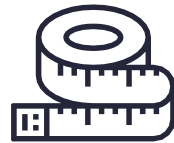

The area of the site is 0.45 acres (0.182ha)



Grade II Listed character property

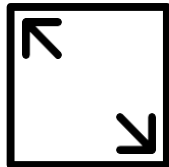

Additional external facilities include a prep kitchen and potential development space.



Central bar area featuring 65 covers and additional bar stools.



Benefit of an external trading area to the rear



THE LONGS PUB, High St, Steeple Ashton, BA14 6EU

LOCATION

Steeple Ashton is a village in Wiltshire, located approximately 12 miles southeast of Bath. The Longs Pub is situated in the centre of the village on the High Street.

Transport links include local roads with connections to major routes such as the A350 and A361. The closest major train station is in Trowbridge, approximately 4 miles away, offering services to Bath, Bristol, and London.

The Longs Pub is located centrally on High Street, the main thoroughfare in Steeple Ashton. The area consists of residential properties and a selection of local businesses. Key local landmarks include St. Mary's Church and various traditional shops and tea rooms.

Description

The Longs Pub is a three-storey Grade II listed establishment, distinct with its stone elevations and classic clay tiled roof. It includes a modern extension that harmonises with the historical architecture. This blend of traditional charm and contemporary adaptation makes the pub a significant and attractive landmark in the local landscape.

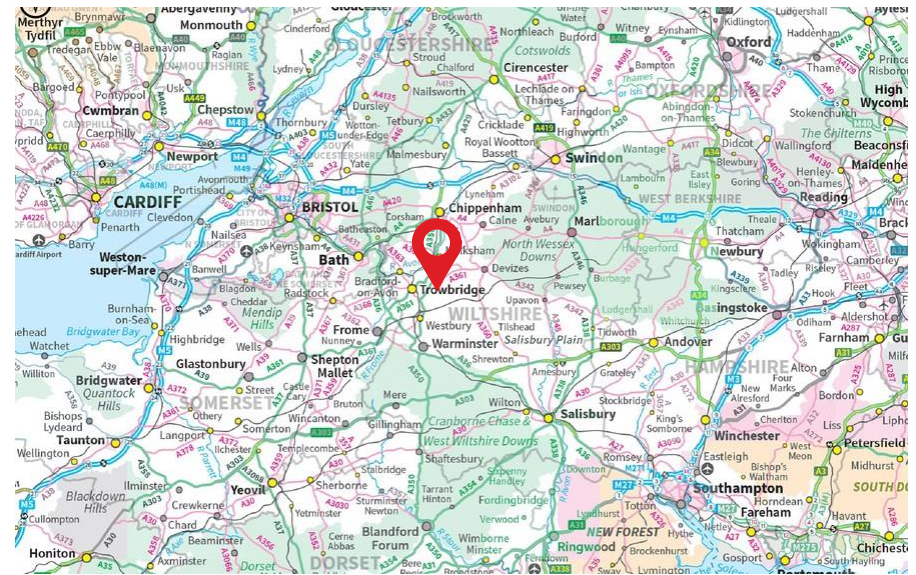
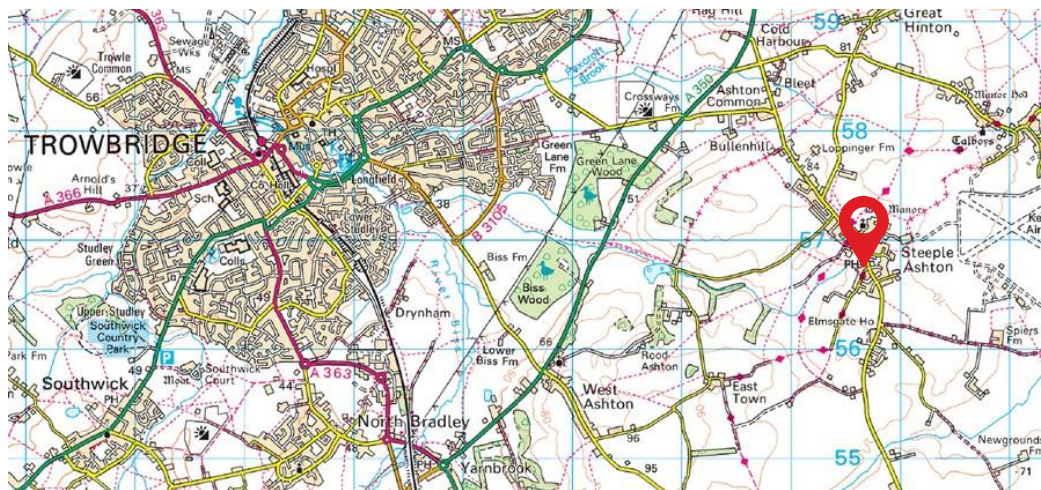

ACCOMMODATION

The Longs Pub is spread over the ground and two upper floors, each distinctively designed for specific functions.

Ground Floor

The pub presents a welcoming bar and restaurant area on the ground floor, accommodating approximately 65 covers and additional bar stools centred around a characterful log burner. This central area is complemented by a series of essential facilities, including male and female, and disabled toilets located at the rear, ensuring accessibility for all guests. The ground floor also features a notable ceiling height of 3 meters, adding to the spacious atmosphere. Operational areas on this level include a new cellar adjacent to the dining room, a fully equipped kitchen, a pot wash area, and two offices. The staff accommodation is accessible via a staircase behind the pot wash area.

First Floor

The first floor has been recently refurbished to provide comfortable staff accommodation, consisting of two bedrooms, a bathroom, and a kitchen/living area, all fitted with new carpeting. The design and layout of this floor have been thoughtfully updated to offer a modern living space.

Second Floor

The second floor is currently utilised as a storage area. Despite its lower ceiling, it holds the potential for further conversion into additional bedrooms and a small lounge area, offering flexibility for future use.

External

Externally, the pub features outdoor seating, adding to the establishment's curb appeal. At the rear, there is a large trade garden area which includes a substantial function room, ideal for hosting events. Additionally, the property encompasses a derelict but dilapidated barn building which has conversion potential and a barn which has been converted into a prep kitchen, further enhancing the pub's operational capabilities.

FLOOR AREAS

The property has the following approximate gross internal floor areas:

| Floor | Sq M | Sq Ft |
|--------------|------|-------|
| Ground Floor | 271 | 2,917 |
| First Floor | TBC | TBC |
| Second Floor | TBC | TBC |
| Total | TBC | TBC |



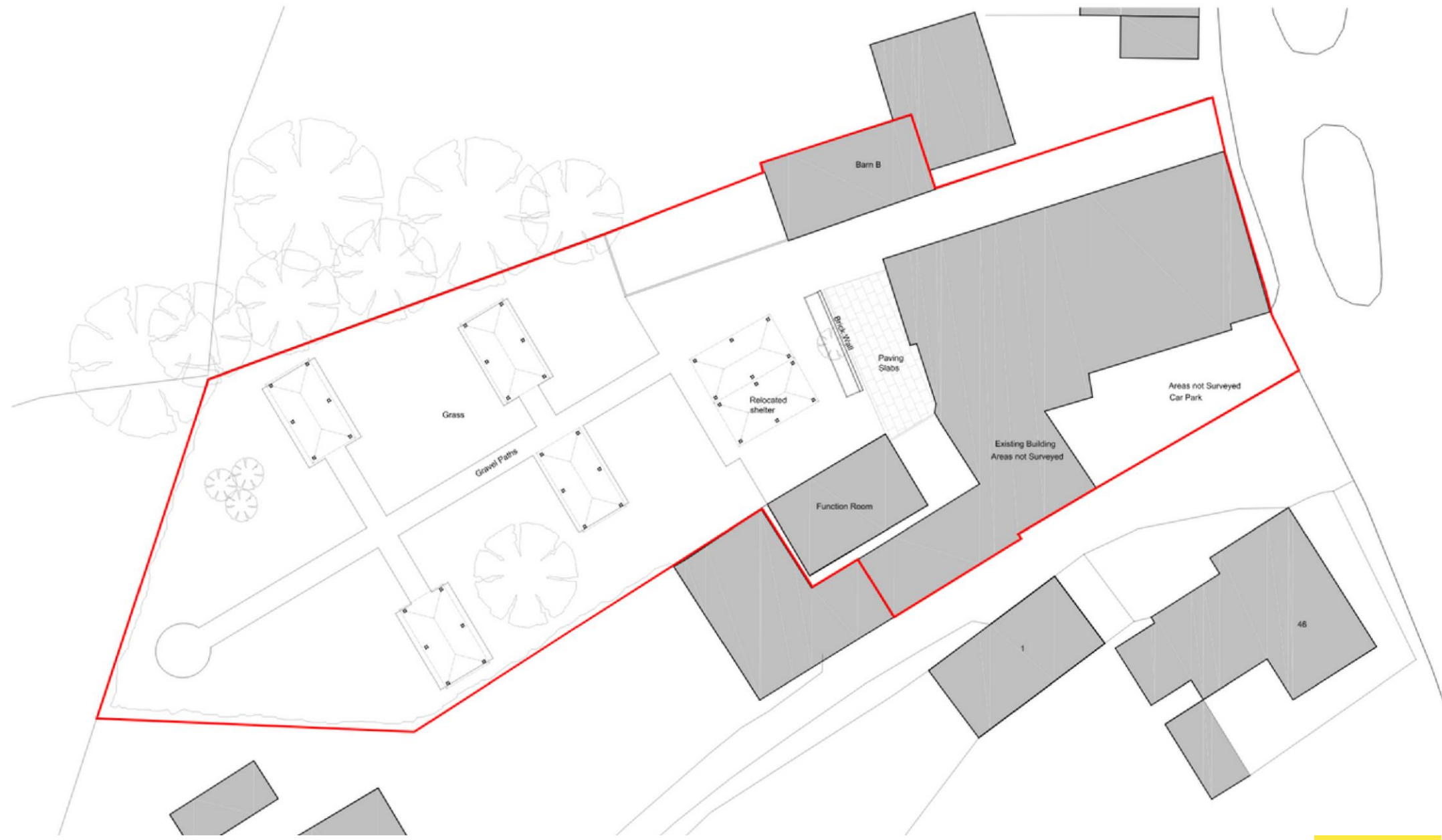

PLANNING

The property is Grade II Listed but is not situated within a conservation area. The Long Arms site at High Street, Steeple Ashton, Wiltshire, BA14 6EU, was involved in two planning applications. The first, Application Reference PL/2023/02642, sought listed building consent to replace a derelict, curtilage-listed former stables building with a timber-clad storage barn, but this was withdrawn by the applicant on 09/06/2023. The second application, Reference 19/04447/FUL, which was granted full planning permission on 31 July 2019, involved the extension of the public house and alteration works to form letting bedrooms.

EPC

In the course of preparation.

PREMISES LICENCE

The property has the benefit of a Premises Licence in accordance with the Licensing Act 2003. The premises are permitted to sell alcohol at the following times:

Monday to Sunday - 11:00-01:00

RATEABLE VALUE

2023 Rateable Value - £13,000

Tenure

The property is held freehold (Title Number WT83742 and WT305765).

Guide Price

Offers are invited for the freehold interest.

VAT

VAT is applicable however it is anticipated that the sale will be treated as a TOGC and therefore VAT will be waived.



THE LONGS PUB, High St, Steeple Ashton, BA14 6EU



Viewings

External viewings are advised in the first instance. A more formal viewing can be arranged by appointment with Savills.

Money Laundering

Money Laundering Regulations require Savills to conduct checks upon all purchasers/tenants. Prospective purchasers/tenants will need to provide proof of identity and residence.



Adam Bullas

Tel: 07812 965395
abullas@savills.com

Harry Heffer

Tel: 07929 085103
harry.heffer@savills.com

