

FREEHOLD



Bungalow

15 WALFORD DRIVE, SOLIHULL, B92 9DW

Asking price

£260,000

FEATURES

Key features

- Freshly decorated Reception Room
- Recently renovated Kitchen
- 2 Double bedrooms
- Well maintained bungalow with large driveway
- Close To Central Solihull, M42 & M6 motorway links Birmingham Airport
- Close to Local Amenities, shops and train stations.
- Walking Distance to Local Schools
- Close to Jaguar Land Rover and direct bus route close to the property.
- Off Road Parking/Garage



2 Bedroom Bungalow located in Solihull

BU Homes are proud to present this well maintained two bedroom bungalow with generous off road parking and garden. Situated in a sought-after location with local amenities Solihull Town Centre, Olton Train Station, Birmingham Airport and Jaguar Land Rover close by and conveniently accessed via the very localised motorway links and transport links including; A45 Coventry Road, Birmingham international train station (providing links to Birmingham City Centre), Birmingham Airport, N.E.C, M42 and JLR. This property also sits in a great catchment area for both primary and second

Call us on

0121 7784443

info@buhomes.co.uk

www.buhomes.co.uk

Council Tax Band

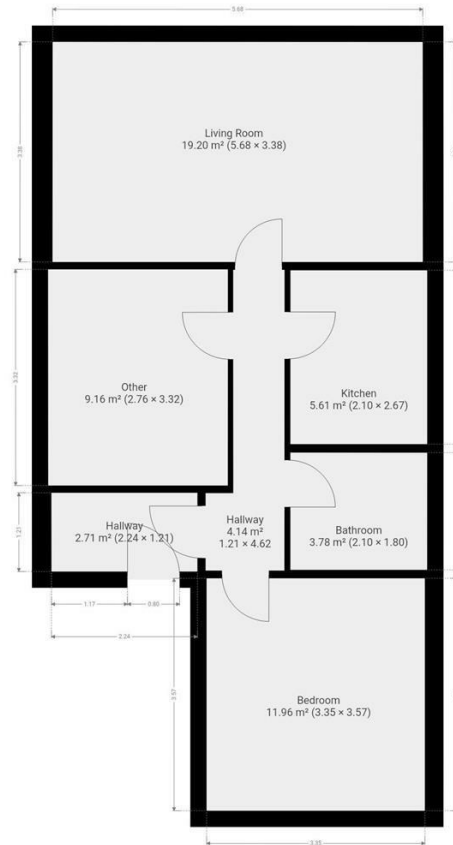

THIS FLOORPLAN IS PROVIDED WITHOUT WARRANTY OF ANY KIND. SENDSPA DISCLAIMS ANY WARRANTY INCLUDING, WITHOUT LIMITATION, SATISFACTORY QUALITY OR ACCURACY OF DIMENSIONS.

Energy Efficiency Rating		
	Current	Potential
Very energy efficient - lower running costs		
(92 plus) A		
(81-91) B		
(69-80) C		
(55-68) D	65	
(39-54) E		
(21-38) F		
(1-20) G		
Not energy efficient - higher running costs		
England & Wales	EU Directive 2002/91/EC 	

Agents Note: Whilst every care has been taken to prepare these particulars, they are for guidance purposes only. All measurements are approximate and are for general guidance purposes only and whilst every care has been taken to ensure their accuracy, they should not be relied upon and potential buyers are advised to recheck the measurements.

BU HOMES