

## THRAWL STREET, LONDON, E1

£3,500

\* VIRTUAL TOUR AVAILABLE \* Goldman Greg is delighted to present this stunning warehouse conversion overlooking Spitalfields.

This light and modern two bedroom apartment features big windows, high ceilings, open plan living/dining space with a breakfast bar, exposed brickwork, solid wood flooring, modern bathroom and two spacious double bedrooms.

Thrawl Street is home to famous restaurants and notable buildings such as Gherkin & Heron Tower. Further attractions include Spitalfields & Leadenhall markets. It is also within moments of Aldgate East station and Liverpool Street.



# Thrawl Street, E1 6RW

Approx Gross Internal Area = 75.53 sq m / 813 sq ft

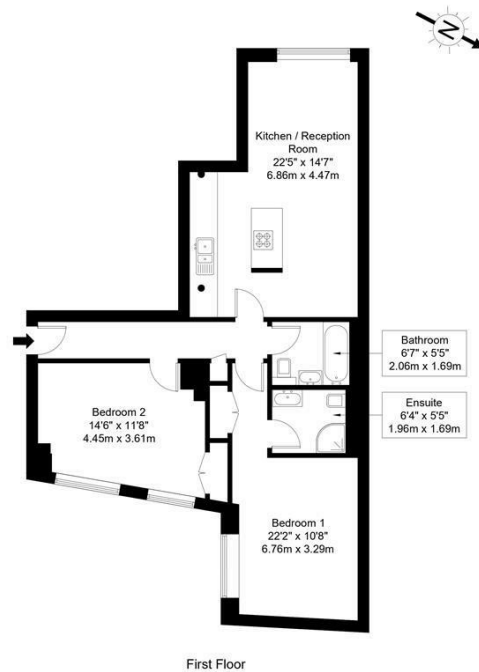

Ref :

Copyright **BLEUPLAN**

The Floor plan is not to scale and measurements and areas shown are approximate and therefore should be used for illustrative purposes only. The plan has been prepared in accordance with the RICS code of Measuring Practice and whilst we have confidence in the information produced it must not be relied on. Maximum lengths and widths are represented on the floor plan. If there is any aspect of particular importance, you should carry out or commission your own inspection of the property.  
Copyright @ BLEUPLAN

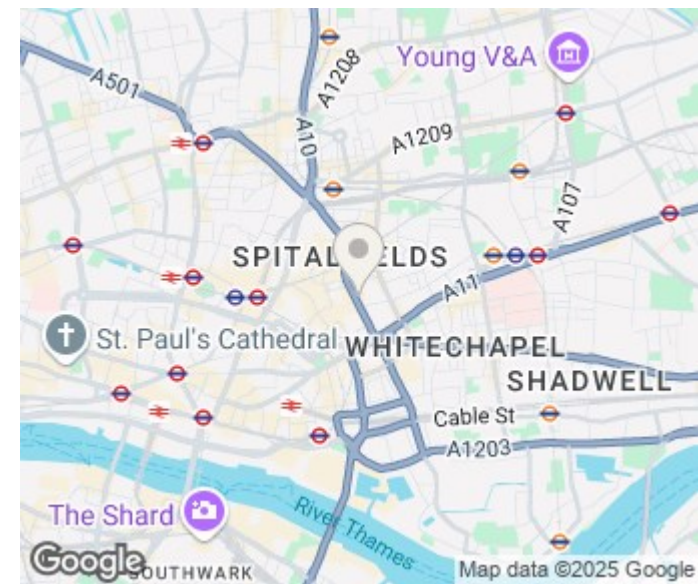

Energy Efficiency Rating		
	Current	Potential
Very energy efficient - lower running costs		
(92 plus) <b>A</b>		
(81-91) <b>B</b>		
(69-80) <b>C</b>	69	74
(55-68) <b>D</b>		
(39-54) <b>E</b>		
(21-38) <b>F</b>		
(1-20) <b>G</b>		
Not energy efficient - higher running costs		
<b>England &amp; Wales</b>	EU Directive 2002/91/EC	

Agents Note: Whilst every care has been taken to prepare these particulars, they are for guidance purposes only. All measurements are approximate and are for general guidance purposes only and whilst every care has been taken to ensure their accuracy, they should not be relied upon and potential buyers/tenants are advised to recheck the measurements

Goldman Greg  
143 Leman Street  
London  
E1 8EY

02079770018  
leads@goldmangreg.co.uk  
www.goldmangreg.co.uk

