



FORTESS ROAD, LONDON, NW5

£2,100 PCM

Goldman Greg are delighted to offer this one bedroom lower ground floor stunning apartment within a boutique, award winning development, just a stone throw from Kentish Town station.

Complete to the highest of standards and available on both a furnished and unfurnished basis, this property is suitable for all.

Comprising a double bedroom, three piece bathroom suite, fully fitted and integrated kitchen with all mod cons, washer and dryer appliances and a private terrace.

Wooden flooring and a neutral décor throughout compliment a stunning, well thought out, architecturally designed apartment.

Available from the 28th July 2025, early viewings are highly recommended.



Goldman Greg

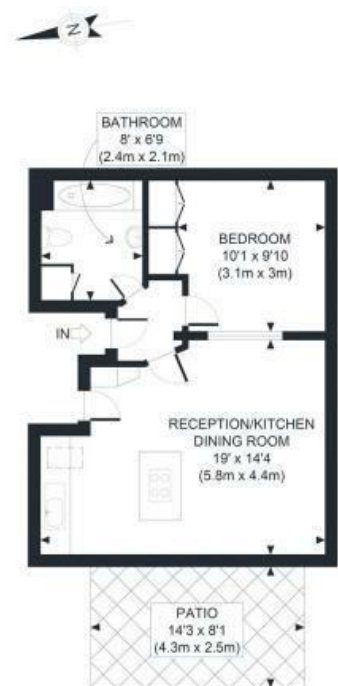

LOWER GROUND FLOOR
GROSS INTERNAL
FLOOR AREA 435 SQ FT

APPROX. GROSS INTERNAL FLOOR AREA 435 SQ FT / 40 SQM

Ref:

Copyright **photoplan**

Disclaimer: Floor plan measurements are approximate and are for illustrative purposes only. While we do not doubt the floor plan accuracy and completeness, you or your advisors should conduct a careful, independent investigation of the property in respect of monetary valuation.

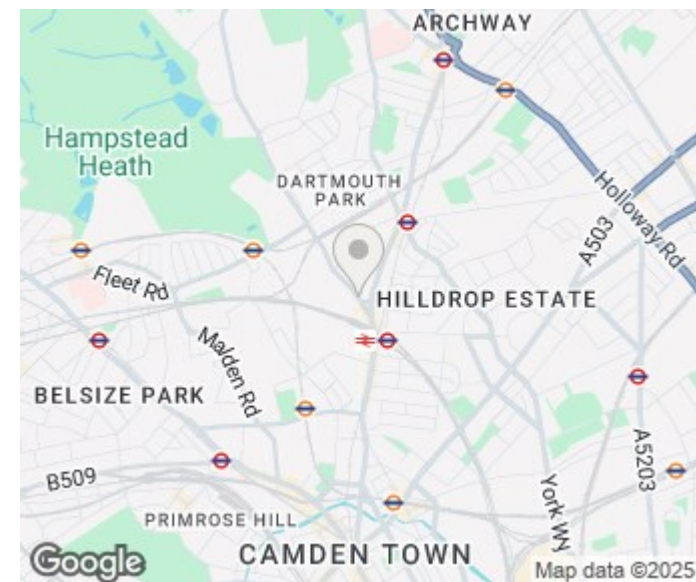

Energy Efficiency Rating		
	Current	Potential
Very energy efficient - lower running costs		
(92 plus) A		
(81-91) B		
(69-80) C		
(55-68) D		
(39-54) E		
(21-38) F		
(1-20) G		
Not energy efficient - higher running costs		
England & Wales	EU Directive 2002/91/EC	

Agents Note: Whilst every care has been taken to prepare these particulars, they are for guidance purposes only. All measurements are approximate and are for general guidance purposes only and whilst every care has been taken to ensure their accuracy, they should not be relied upon and potential buyers/tenants are advised to recheck the measurements

Goldman Greg
143 Leman Street
London
E1 8EY

02079770018
leads@goldmangreg.co.uk
www.goldmangreg.co.uk

