

BRECKNOCK ROAD, LONDON, N7

£1,650 PCM

* VIRTUAL TOUR AVAILABLE * Goldman Greg are delighted to offer this two bedroom apartment which has been freshly painted throughout located on Brecknock Road, N7.

The property benefits from a large kitchen with separate living room, one double bedroom with fitted storage, one single bedroom and a modern bathroom.

Located only minutes from Tufnell Park & Kentish Town underground Stations (Northern Line) and just a short stroll to the multitude of bars, restaurants, and other local amenities that both Tufnell Park and Kentish Town has to offer.

Available to move into, viewings are highly recommended of this property.



Goldman Greg

Brecknock Road, N7

Approx. Gross Internal Area = 55.7 sq m / 599 sq ft

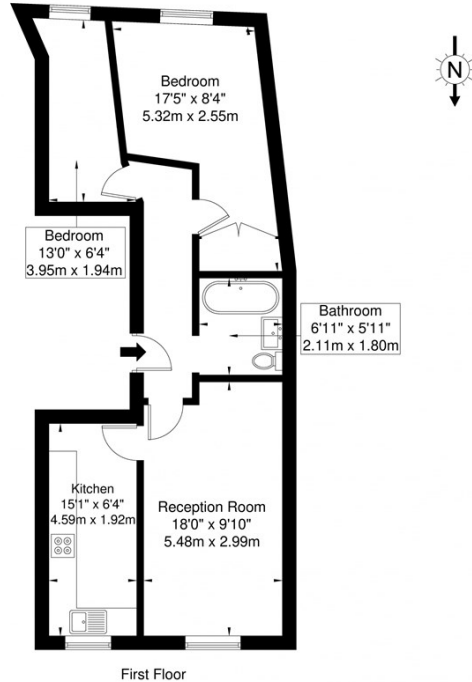

Ref

Copyright
BLEU
PLAN

The Floor plan is not to scale and measurements and areas shown are approximate and therefore should be used for illustrative purposes only. The plan has been prepared in accordance with the RICS code of Measuring Practice and whilst we have confidence in the information produced it must not be relied on. If there is any aspect of particular importance, you should carry out or commission your own inspection of the property.
Copyright © BLEUPLAN

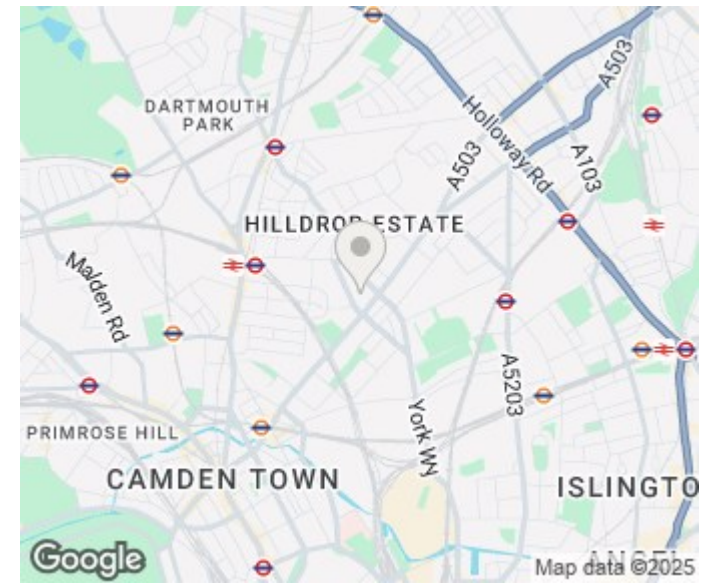

Energy Efficiency Rating		
	Current	Potential
Very energy efficient - lower running costs		
(92 plus) A		
(81-91) B		
(69-80) C		
(55-68) D	66	73
(39-54) E		
(21-38) F		
(1-20) G		
Not energy efficient - higher running costs		
England & Wales	EU Directive 2002/91/EC	

Agents Note: Whilst every care has been taken to prepare these particulars, they are for guidance purposes only. All measurements are approximate and are for general guidance purposes only and whilst every care has been taken to ensure their accuracy, they should not be relied upon and potential buyers/tenants are advised to recheck the measurements

Goldman Greg
143 Leman Street
London
E1 8EY

02079770018
leads@goldmangreg.co.uk
www.goldmangreg.co.uk

