



LEMAN STREET, LONDON, E1

£2,000 PCM

Goldman Greg are delighted to offer this two bedroom first floor apartment located on the heart of Leman Street, E1.

The property benefits from having a bright and airy living room with space for dining and features two large windows, letting in plenty of natural light. The property also offers two bedrooms, one being a double, a shower room and a fully equipped kitchen.

Transport in the area is really convenient with a number of buses and stations close by including Aldgate, Aldgate East, London Fenchurch Street and Tower Hill just to name a few!

You will also find plenty of independent local amenities on your doorstep including a range of shops, cafes, bars and restaurants.

Offered part furnished and available from 15th November 2024 and early viewings are highly recommended.



Goldman Greg

Leman Street, E1 8EY

Approx Gross Internal Area = 53.82 sq m / 579 sq ft

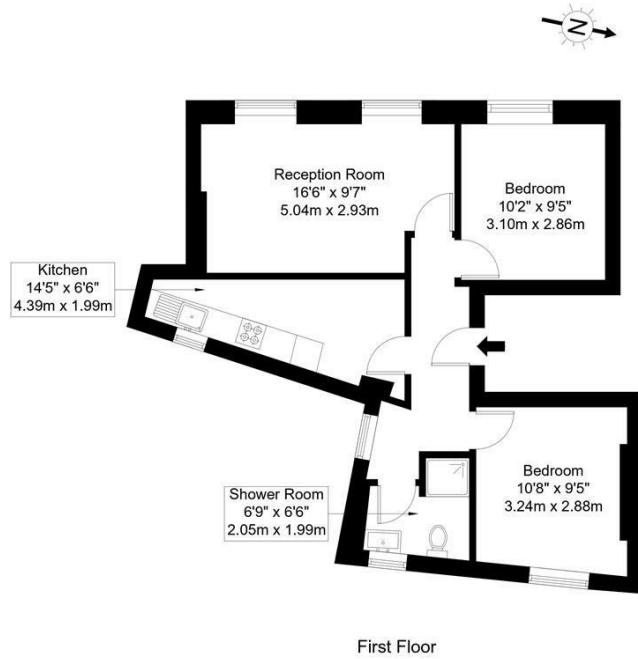

Ref :

Copyright **BLEU PLAN**

The Floor plan is not to scale and measurements and areas shown are approximate and therefore should be used for illustrative purposes only. The plan has been prepared in accordance with the RICS code of Measuring Practice and whilst we have confidence in the information produced it must not be relied on. If there is any aspect of particular importance, you should carry out or commission your own inspection of the property.
Copyright @ BLEUPLAN



Energy Efficiency Rating		
	Current	Potential
Very energy efficient - lower running costs		
(92 plus) A		
(81-91) B		
(69-80) C		73
(55-68) D	60	
(39-54) E		
(21-38) F		
(1-20) G		
Not energy efficient - higher running costs		
England & Wales	EU Directive 2002/91/EC	

Agents Note: Whilst every care has been taken to prepare these particulars, they are for guidance purposes only. All measurements are approximate and are for general guidance purposes only and whilst every care has been taken to ensure their accuracy, they should not be relied upon and potential buyers/tenants are advised to recheck the measurements

Goldman Greg
143 Leman Street
London
E1 8EY

02079770018
leads@goldmangreg.co.uk
www.goldmangreg.co.uk

