

CENTRE HEIGHTS, FINCHLEY ROAD, LONDON, NW3

£2,300 PCM

Goldman Greg are delighted to offer this smart 1 bedroom apartment featuring modern interiors throughout. Centre Heights is a lift and portered serviced building ideally located for the local amenities and transport links of Swiss Cottage and Finchley Road all within a very easy reach.

This immaculate home boasts the benefit of underfloor heating, bespoke fitted wardrobes, a fully integrated kitchen, a fully tiled bathroom with chrome fixtures, an air cooling system and engineered oak flooring.

Available from 28th September 2024, early viewings are highly recommended.



Goldman Greg

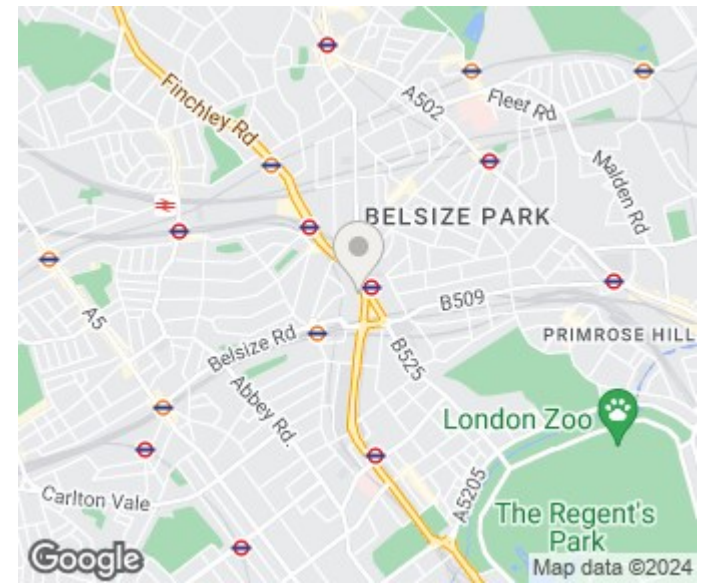
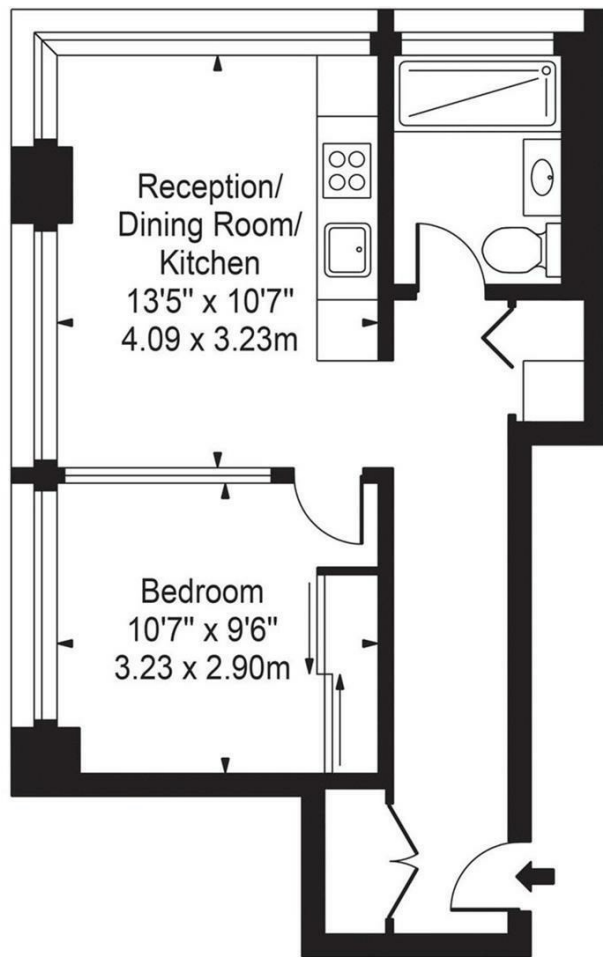

Energy Efficiency Rating		
	Current	Potential
Very energy efficient - lower running costs		
(92 plus) A		
(81-91) B	82	82
(69-80) C		
(55-68) D		
(39-54) E		
(21-38) F		
(1-20) G		
Not energy efficient - higher running costs		
England & Wales	EU Directive 2002/91/EC	

Agents Note: Whilst every care has been taken to prepare these particulars, they are for guidance purposes only. All measurements are approximate and are for general guidance purposes only and whilst every care has been taken to ensure their accuracy, they should not be relied upon and potential buyers/tenants are advised to recheck the measurements

Goldman Greg
143 Leman Street
London
E1 8EY

02079770018
leads@goldmangreg.co.uk
www.goldmangreg.co.uk

