



LEMAN STREET, LONDON, E1

£1,900 PCM

* VIRTUAL TOUR AVAILABLE * Goldman Greg are delighted to offer this one bedroom apartment located on Leman Street, E1.

The apartment offers a modern kitchen with appliances, and a separate reception room benefiting from large windows to enjoy plenty of natural daylight and access to a private roof terrace.

The apartment is fitted with gas central heating throughout.

Leman Street is located within a short walk to Tower Hill Tube and DLR station and a range of local shops and amenities.

Available from the 22nd July 2024.



Goldman Greg

Leman Street, E1 8EY

Approx. Gross Internal Area = 48.6 sq m / 523 sq ft

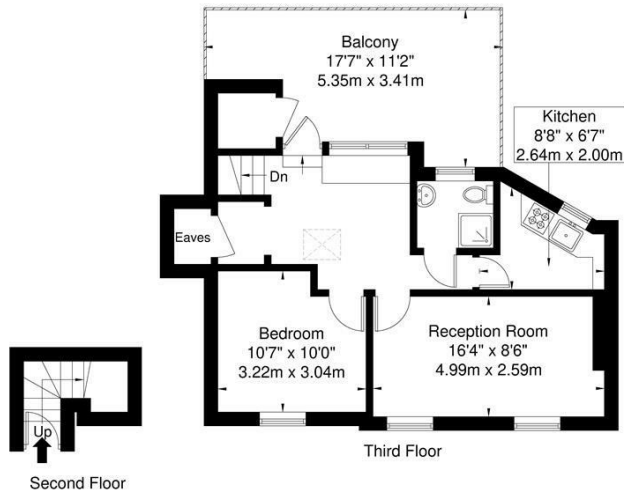

Ref

Copyright **BLEU PLAN**

The Floor plan is not to scale and measurements and areas shown are approximate and therefore should be used for illustrative purposes only. The plan has been prepared in accordance with the RICS code of Measuring Practice and whilst we have confidence in the information produced it must not be relied on. If there is any aspect of particular importance, you should carry out or commission your own inspection of the property.
Copyright © BLEUPLAN



Energy Efficiency Rating		Current	Potential
Very energy efficient - lower running costs			
(92 plus) A			
(81-91) B			
(69-80) C			
(55-68) D		55	59
(39-54) E			
(21-38) F			
(1-20) G			
Not energy efficient - higher running costs			
England & Wales		EU Directive 2002/91/EC	

Agents Note: Whilst every care has been taken to prepare these particulars, they are for guidance purposes only. All measurements are approximate and are for general guidance purposes only and whilst every care has been taken to ensure their accuracy, they should not be relied upon and potential buyers/tenants are advised to recheck the measurements

Goldman Greg
143 Leman Street
London
E1 8EY

02079770018
leads@goldmangreg.co.uk
www.goldmangreg.co.uk

