



## BOLLO LANE, LONDON, W4

£2,000

Goldman Greg are delighted to offer this bright one bedroom garden flat in a prime location. Featuring a sleek and impressive finish with ample living and storage as well as a private garden.

Bollo lane is located a short distance from Chiswick High Road, with easy access to Central London via the District Line.



Goldman Greg

67 Bollo Lane W4.  
 Approx Gross Internal Area  
 55 Sq M - 592 Sq Ft

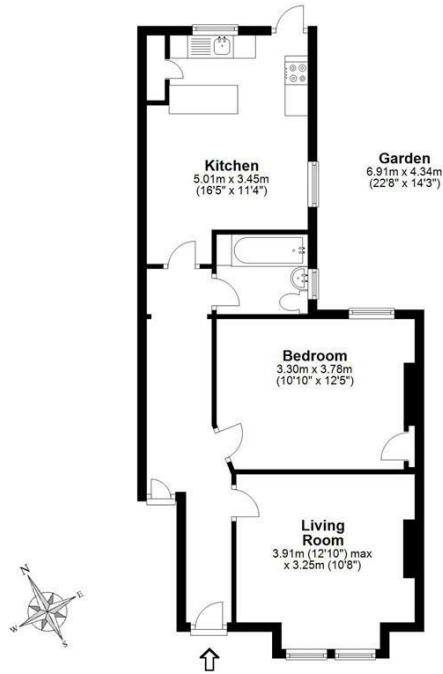

Whilst every attempt has been made to ensure the accuracy of the floor plan contained here, measurements are approximate and no responsibility is taken for any error, omission, or mis-statement. The plan is for illustrative purposes only and should be used as such by any prospective purchaser.



Energy Efficiency Rating		Current	Potential
Very energy efficient - lower running costs			
(92 plus) <b>A</b>			
(81-91) <b>B</b>			
(69-80) <b>C</b>			
(55-68) <b>D</b>		60	69
(39-54) <b>E</b>			
(21-38) <b>F</b>			
(1-20) <b>G</b>			
Not energy efficient - higher running costs			
<b>England &amp; Wales</b>		EU Directive 2002/91/EC	

Agents Note: Whilst every care has been taken to prepare these particulars, they are for guidance purposes only. All measurements are approximate and are for general guidance purposes only and whilst every care has been taken to ensure their accuracy, they should not be relied upon and potential buyers/tenants are advised to recheck the measurements

Goldman Greg  
 143 Lemn Street  
 London  
 E1 8EY

02079770018  
 leads@goldmangreg.co.uk  
 www.goldmangreg.co.uk

