



FINE & COUNTRY

Bourne Walk, Staincross, Barnsley, S75 6JQ

£700,000

🛏 4 🚿 3 🚗 3



- 1/3 of an Acre Grounds
- Landscaped South Facing Gardens
- 4 bedroom house with 1 Bed Annex / Leisure suite
- Swimming Pool
- High Quality Kitchen, Lounge / Dining Room & Garden Room
- Secure Parking & Garage
- Sought After Village Location
- Open Countryside
- M1 Access
- Local Services & Amenities



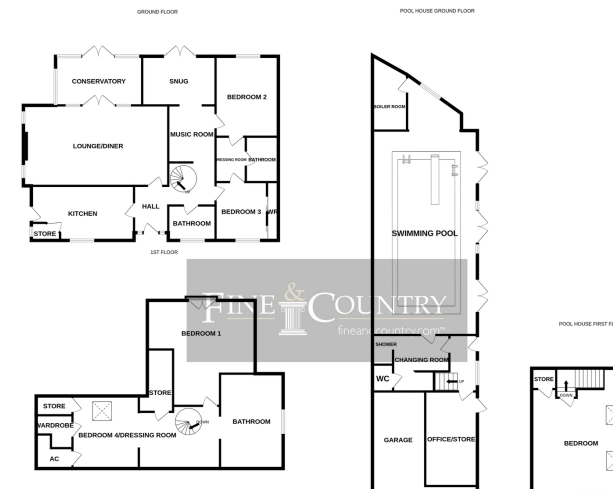

Whilst every attempt has been made to ensure the accuracy of the floorplan contained here, measurements of doors, windows, rooms and any other items are approximate and no responsibility is taken for any error, omission or mis-statement. This plan is for illustrative purposes only and should be used as such by any prospective purchaser. The services, systems and appliances shown have not been tested and no guarantee as to their operability or efficiency can be given.
Made with Metropix i2025

Set within privately enclosed grounds, approaching 1/3 of an acre; an individually designed and built four bedroom home with an annexed leisure suite incorporating a home office, swimming pool and a double garage.

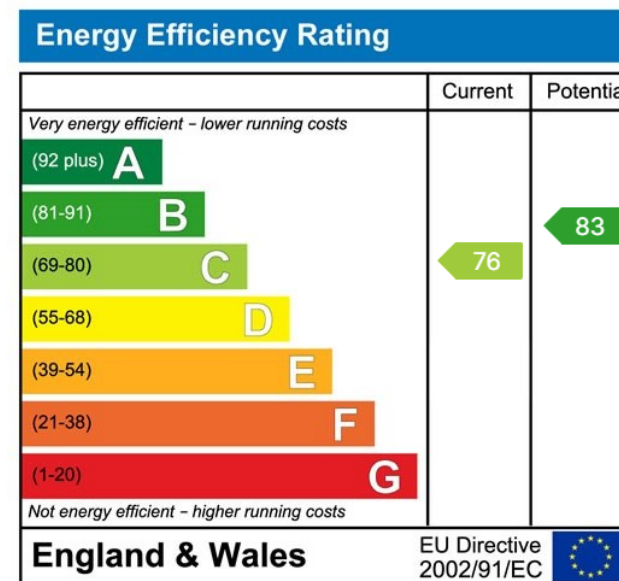

House 42, Locke, 44 Shambles St,
Barnsley S70 2SH
Tel: +44 (0)01226 729009
barnsley@fineandcountry.com

Unit 2 Former Council Offices, Eastgate
Honley, Holmfirth HD9 6PA
Tel: +44 (0)1484 550620
huddersfield@fineandcountry.com

The Balance Floor 7, 2 Pinfold Street
Sheffield, South Yorkshire S1 2GU
Tel: +44 (0)114 404 0044
sheffield@fineandcountry.com