



FINE & COUNTRY

# Brocco Bank, S11

Offers Over £750,000

🛏️ 4 🚿 3 🚗 2



- NEXT TO BOTANICAL GARDENS
- OFF ROAD PARKING
- LOCAL AMENITIES WITHIN WALKING DISTANCE
- LARGE LOUNGE AND KITCHEN
- HIGHLY SOUGHT AFTER LOCATION
- EXCELLENT SCHOOLS CLOSE BY
- FOUR DOUBLE BEDROOMS
- FABULOUS VICTORIAN PROPERTY
- ATTIC AND BASEMENT DEVELOPMENT POTENTIAL
- GOOD COMMUTER LINKS



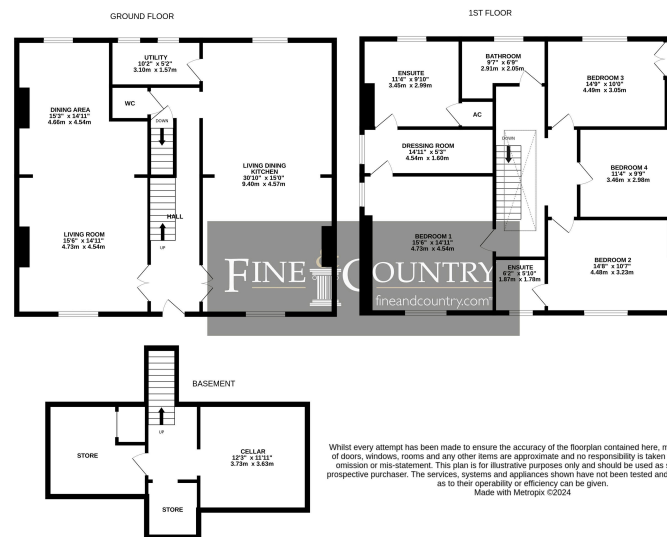

Whilst every attempt has been made to ensure the accuracy of the floorplan contained here, measurements of doors, windows, rooms and any other items are approximate and no responsibility is taken for any error, omission or mis-statement. This plan is for illustrative purposes only and should be used as such by any prospective purchaser. The services, systems and appliances shown have not been tested and no guarantee as to their operability or efficiency can be given.  
Made with Metropix ©2024

This stunning four-bedroom detached home is all about Location, Location, Location. Nestled just a few metres away from the Botanical Gardens and within walking distance of Sheffield's finest education establishments.

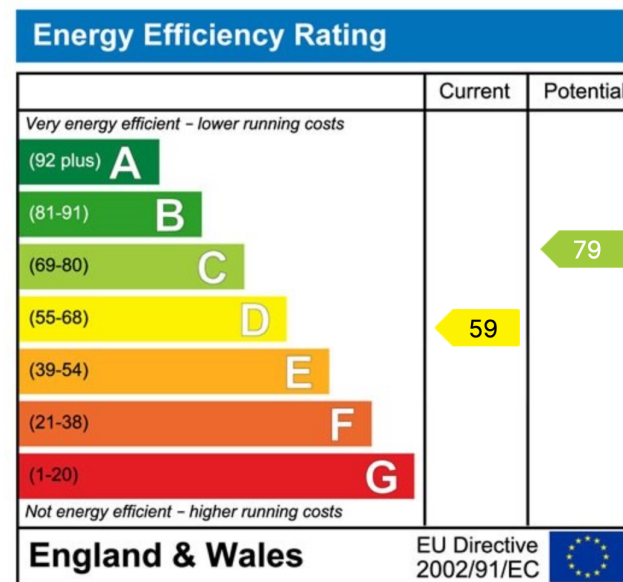

House 42, Locke, 44 Shambles St,  
Barnsley S70 2SH  
Tel: +44 (0)01226 729009  
barnsley@fineandcountry.com

Unit 2 Former Council Offices, Eastgate  
Honley, Holmfirth HD9 6PA  
Tel: +44 (0)1484 550620  
huddersfield@fineandcountry.com

The Balance Floor 7, 2 Pinfold Street  
Sheffield, South Yorkshire S1 2GU  
Tel: +44 (0)114 404 0044  
sheffield@fineandcountry.com