

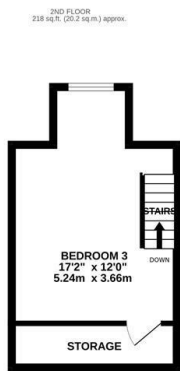

## 179 Main Street, Shirebrook, Nottinghamshire, NG20 8DT

Offers In The Region Of £115,000

- Mid Terrace House
- Gas Central Heating
- Investment Only
- Three Double Bedrooms
- Double Glazing
- Open Plan Lounge/Diner
- Large Rear Garden

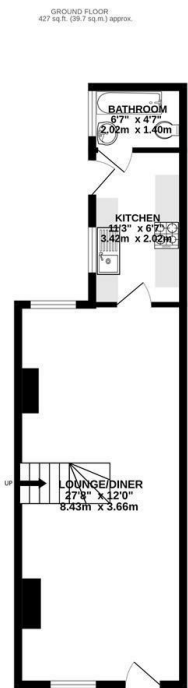

TOTAL FLOOR AREA - 963 sq.ft. (89.4 sq.m.) approx.  
 Whilst every attempt has been made to ensure the accuracy of the floorplan contained herein, measurements of doors, windows, rooms and any other items are approximate and no responsibility is taken for any error, omission or misstatement. This plan is for guidance purposes only and should be used as such for any prospective purchase. The services, systems and appliances shown have not been tested and no guarantee is given as to their operability or efficiency can be given.  
 Made with Metropix ©2024

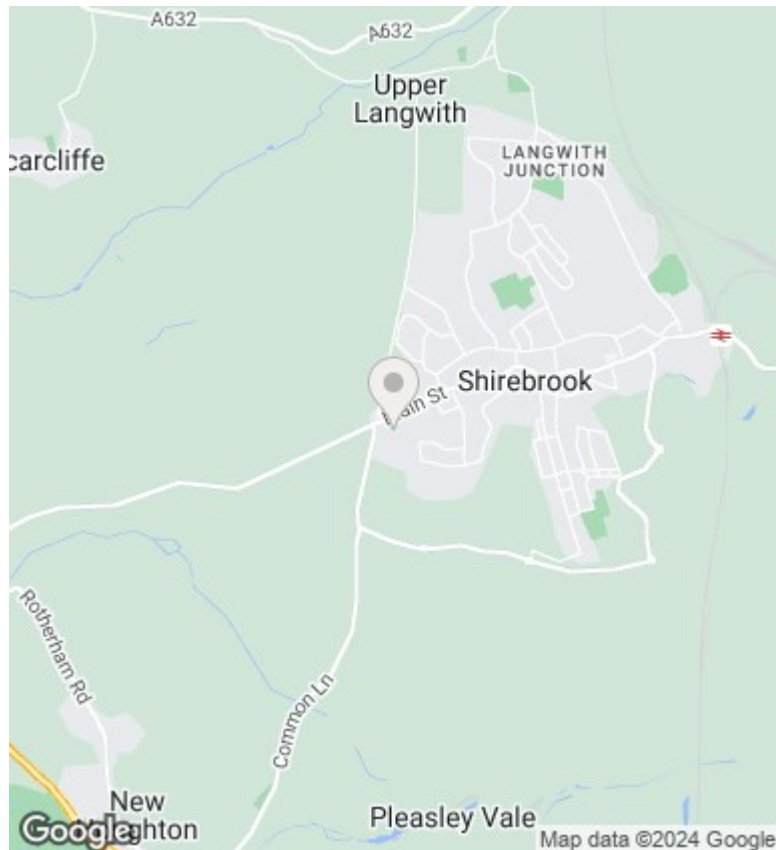

### Directions

### Viewings

Viewings by arrangement only. Call 01623 747 956 to make an appointment.

### Council Tax Band

A

### EPC Rating:

D

### Energy Efficiency Rating

	Current	Potential
<i>Very energy efficient - lower running costs</i>		
(92 plus) <b>A</b>		
(81-91) <b>B</b>		<b>83</b>
(69-80) <b>C</b>		
(55-68) <b>D</b>	<b>57</b>	
(39-54) <b>E</b>		
(21-38) <b>F</b>		
(1-20) <b>G</b>		
<i>Not energy efficient - higher running costs</i>		
<b>England &amp; Wales</b>	EU Directive 2002/91/EC	