



ANTLER RISE
HEMSWELL

The Handley

A 3 bedroom semi-detached home





The Handley

A 3 bedroom semi-detached home

Ground Floor

Lounge/Dining

5040mm x 2820mm

Kitchen

3030mm x 2810mm

First Floor

Bedroom 1

3420mm x 2720mm

Bedroom 2

3330mm x 2710mm

Bedroom 3

2250mm x 2030mm

Ground Floor

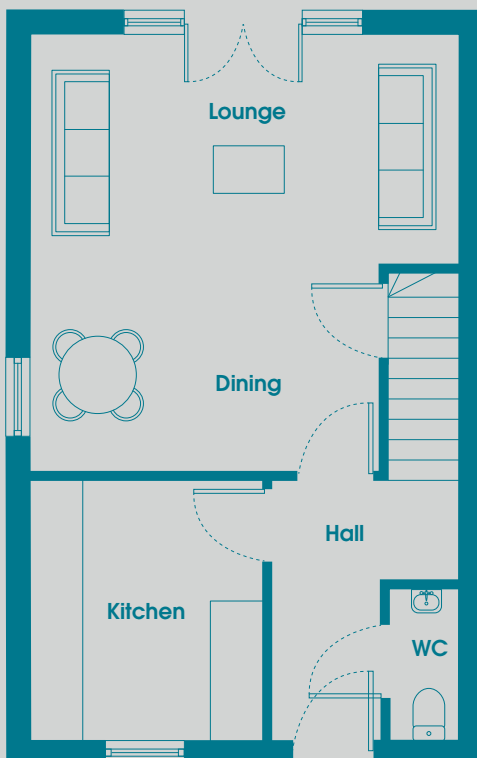

First Floor

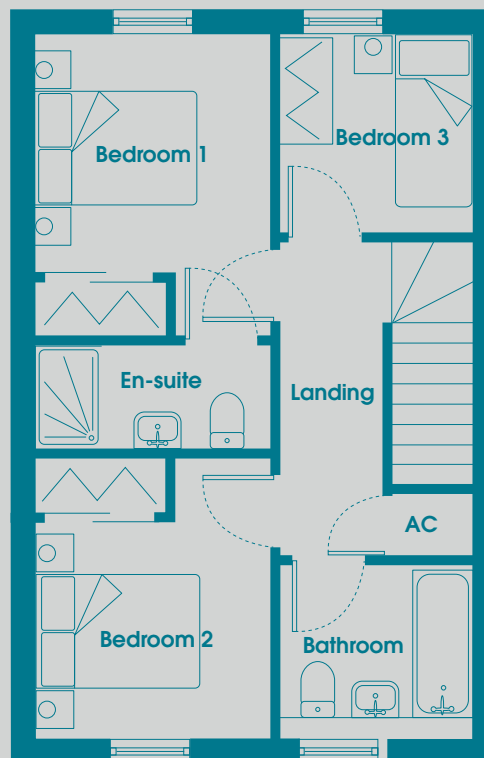

antlerrise.co.uk

The floor plans depict a typical layout of this house type. For exact plot specification, details of external and internal finishes, dimensions, site plan and floor plan differences please consult your sales advisor. Dimensions given are estimated from architects drawings and subject to change. Approximate dimensions are provided to give a general indication of the proposed development and floor layout and should not be used for carpet sizes, appliance spaces or items of furniture. Floor plans are not displayed to scale. CGIs and photographs are for illustration purposes only. Sales plans are for illustrative purposes only and layouts/window positions may vary from plot to plot. For accurate layouts and room dimensions please refer to individual mechanical and electrical drawings.