

Need a Mortgage in principle
to make offers? Call us now
for quick assistance!
0121 775 0101

DM&Co.
SALES & LETTINGS



Do you need to sell?
Start your journey now!
Call us we can help.
0121 775 0101

DM&Co.
SALES & LETTINGS



37 The Crescent
Solihull, B91 1JR
Offers in the Region of £730,000

SCAN FOR MORE INFO
SIZE - 2047 Sq Ft
TENURE - Freehold
COUNCIL TAX - Solihull Metropolitan Borough Council - F
BROADBAND - Upload Max 1000Mbps
Download Max 1800Mbps
MOBILE - 02
EPC - D - 65
PARKING - For at least 6 Cars
FLOODRISK - Very Low
SERVICES - Mains
COVENANTS - N/A

Nestled in the heart of Solihull, The Crescent presents a remarkable opportunity to acquire a substantial detached family home. Built in the 1930's the property offers an impressive square footage and with its prime location and generous proportions, this home is perfect for those seeking comfort and convenience in Solihull.

FEATURES

- Spacious Detached Family Home
- Offered With No Upward Chain
- Dual Aspect Lounge
- Fabulous Open Plan Dining/Kitchen/Breakfast Room
- Sun Room & Conservatory
- Ground Floor Shower Room
- Two Principal Dual Aspect Bedroom
- Second Double Bedroom & Third Single
- Useful Store Room with Fitted Cupboards
- Two First Floor Shower Rooms
- Large Driveway & Single Garage
- Low Maintenance Rear Garde
- Central Solihull Location

Are you an investor
interested in expanding your
portfolio?

Call 0121 775 0101 to provide your
investment criteria for alerts.



SCAN TO VIEW OUR
WEEKLY FILMS &
SUBSCRIBE

Sneak Peeks

Every week, we unveil "Sneak Peeks," a feature showcasing exclusive properties before they hit Rightmove and other platforms.

The Landlord Club

Join our Landlord Club for weekly updates on legislation, market trends, and our Letting Director's 'Investment Pick of the Week' for optimal ROI.

HTSPMD

Tune into 'How's The Solihull Property Market Dom' weekly for a quick, insightful snapshot of the market.

The Mortgage Update

Get weekly insights and the best deals with our Mortgage Update, your shortcut to navigating the complex mortgage landscape confidently.

Ground Floor

Approx. 124.3 sq. metres (1338.2 sq. feet)

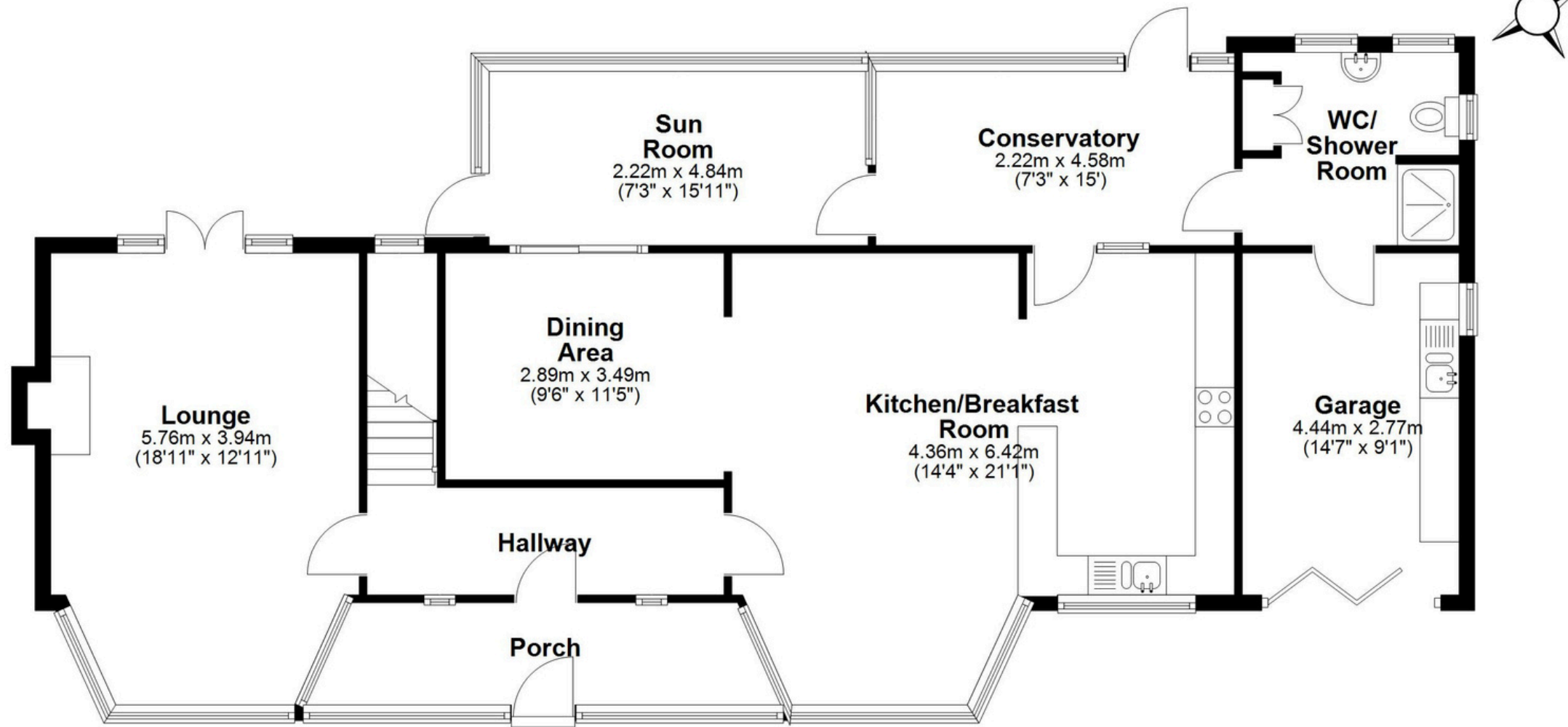

First Floor

Approx. 65.9 sq. metres (709.6 sq. feet)

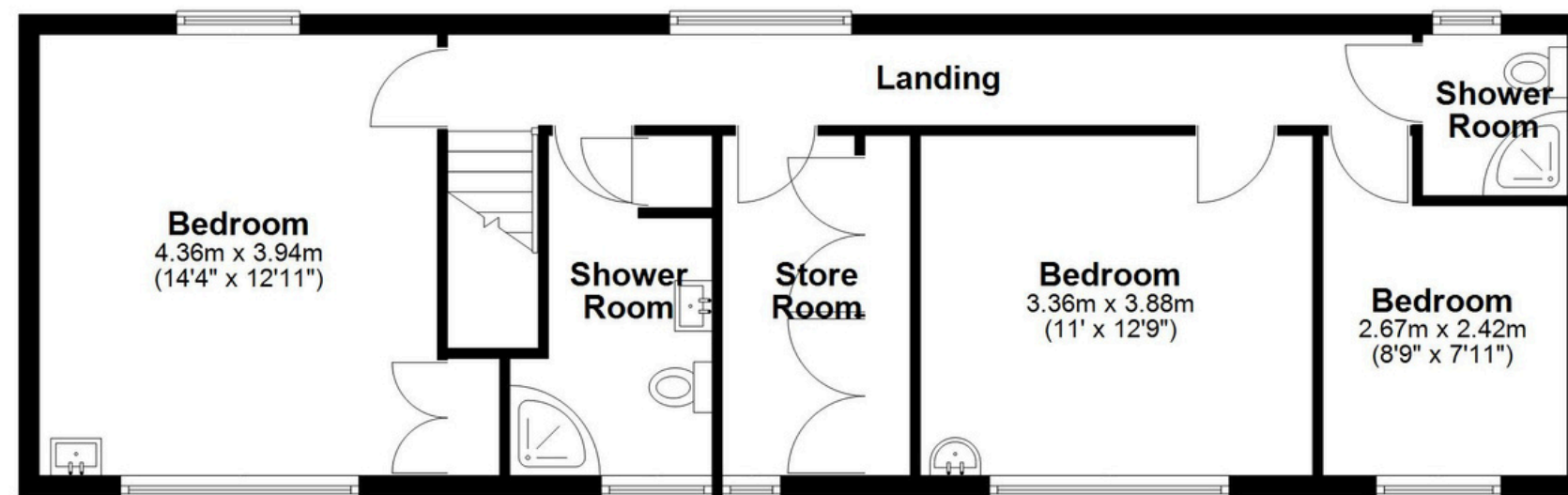

Total area: approx. 190.2 sq. metres (2047.8 sq. feet)

This floor plan is for illustration purposes only, this is not intended to be a measured/scaled survey or comply with RICS guidelines. All measurements (including total floor area) openings, orientation and floor area are approximate. No details are guaranteed, they cannot be relied upon for any purpose and do not form part of any agreement. A party must rely upon its own inspection(s). No responsibility is taken for any error, omission, or mis-statement.
Plan produced using PlanUp.