



**DM&Co.**  
— SALES & LETTINGS —

65a Mill Lane  
Bentley Heath B93 8NN

This Delightful First-Floor Maisonette Located  
In A Quiet Area Is Available From 9th  
September On An Unfurnished Basis.





## DETAILS

This neutrally decorated first floor maisonette is available to move into from 9th September on an unfurnished basis.

Upon entering, you are greeted by a staircase leading to a spacious lounge/dining room, where natural light pours in through a generously sized window, creating a warm and inviting atmosphere. The room features a stylish wall with cut-out sections, adding a unique touch to the space.

The modern fitted kitchen is complete with a breakfast bar and integrated appliances, including a fridge/freezer, dishwasher, oven, hob and extractor fan. There is also ample space for a washing machine.

The accommodation comprises a large double bedroom, a dingle bedroom and a well appointed bathroom.

Solihull Council Tax - Band B



## OUTSIDE

One of the standout features of this maisonette is its private garden area, perfect for enjoying the outdoors, along with the added benefit of a single garage for secure parking or additional storage.

## VIEWINGS

At short notice with DM & Co. Homes on  
0121 775 0101 or by email  
[lettings@dmandcohomes.co.uk](mailto:lettings@dmandcohomes.co.uk)



## GENERAL INFORMATION

The property is situated in a popular area and has easy access to Dorridge village centre and train station. Solihull is a short drive away and offers a wider range of amenities to include shops, restaurants and leisure facilities. Junctions 4 and 5 of the M42 are both close at hand and offer fast links to the Midlands motorway network and beyond.

Mobile Coverage In Your Area - EE, Vodafone, Three, O2

Broadband Coverage In Your Area - Openreach, CityFibre, Virgin Media

## OTHER SERVICES

DM & Co are pleased to offer the following services:-

**Residential Lettings:** If you are considering letting your property, please contact the office on 0121 775 0101.

**Mortgage Services:** If you would like advice on the best mortgages available, please contact us on 0121 775 0101.

**Agents Note:** Whilst every care has been taken to prepare these sales particulars, they are for guidance purposes only. All measurements are approximate and are for general guidance purposes only and whilst every care has been taken to ensure their accuracy, they should not be relied upon and potential buyers are advised to recheck the measurements.

FEATURES

- Well-Presented First Floor Maisonette
- Spacious Living Area
- Kitchen With Integrated Appliances
- One Double & One Single
- Modern Family Bathroom
- Garden Area
- Quiet Location
- Holding Deposit - £265.00
- Security Deposit - £1326.92
- Available 9th September On An Unfurnished Basis

VIEWING

Book a viewing with Sole Agents DM & Co.  
Premium by phone or email:

📞 0121 775 0101

@ lettings@dmandcohomes.co.uk

Agents Note: Whilst every care has been taken to prepare these sales particulars, they are for guidance purposes only. All measurements are approximate and are for general guidance purposes only and whilst every care has been taken to ensure their accuracy, they should not be relied upon and potential buyers are advised to recheck the measurements

Ground Floor  
Approx. 1.3 sq. metres (14.0 sq. feet)

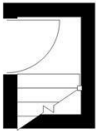

First Floor  
Approx. 58.4 sq. metres (628.8 sq. feet)

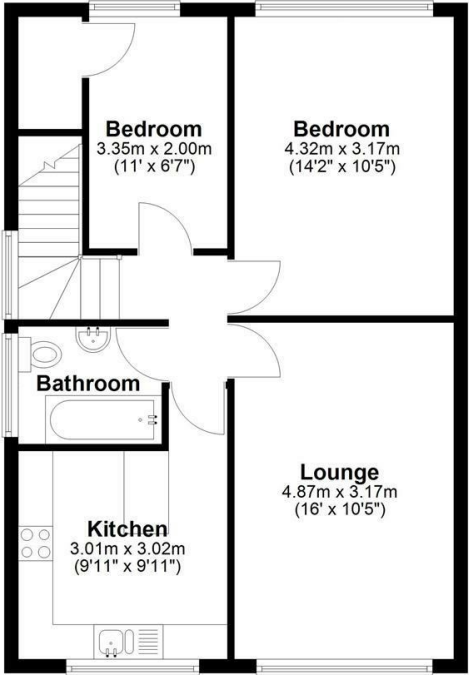

Total area: approx. 59.7 sq. metres (642.8 sq. feet)

This floor plan is for illustration purposes only, this is not intended to be a measured/scaled survey or comply with RICS guidelines. All measurements (including total floor area) openings, orientation and floor area are approximate. No details are guaranteed, they cannot be relied upon for any purpose and do not form part of any agreement. A party must rely upon its own inspection(s). No responsibility is taken for any error, omission, or mis-statement.  
Plan produced using PlanUp.

