

Need a Mortgage in principle  
to make offers? Call us now  
for quick assistance!  
**0121 775 0101**



Do you need to sell?  
Start your journey now!  
Call us we can help.  
**0121 775 0101**



**SCAN FOR MORE INFO**  
**SIZE** - 1,434 Sq Ft  
**TENURE** - Freehold  
**COUNCIL TAX** - Birmingham City Council - B  
**BROADBAND** - Upload Max 200Mbps  
Download Max 1800Mbps  
**MOBILE** - EE, Three, O2, Vodafone  
**EPC** - B - 83  
**PARKING** - Secure Parking For 2 Cars  
**FLOODRISK** - Very Low  
**SERVICES** - Mains  
**COVENANTS** - N/A

## DOUGLAS ROAD

Offers In Excess Of £300,000

Situated on a generous corner plot in the popular area of Acocks Green, Birmingham, this fabulous three bedroom end terrace home on Douglas Road offers a superb blend of space, comfort and practicality. With its well proportioned layout and family friendly design, it's an ideal choice for those looking for room to grow or simply enjoy more space.

### FEATURES

- Three Bedroom End Terrace House
- Corner Plot
- Two Spacious Reception Rooms
- Extended Kitchen/Diner
- Downstairs Shower Room
- Three Double Bedrooms
- Family Bathroom
- Large Low Maintenance Garden
- Versatile Garden Room
- Secure Off Road Parking

Are you an investor  
interested in expanding your  
portfolio?

**Call 0121 775 0101 to provide your investment criteria for alerts.**



SCAN TO **VIEW OUR**  
**WEEKLY FILMS &**  
**SUBSCRIBE**

### Sneak Peeks

Every week, we unveil "Sneak Peeks," a feature showcasing exclusive properties before they hit Rightmove and other platforms.

### The Landlord Club

Join our Landlord Club for weekly updates on legislation, market trends, and our Letting Director's 'Investment Pick of the Week' for optimal ROI.

### HTSPMD

Tune into 'How's The Solihull Property Market Dom' weekly for a quick, insightful snapshot of the market.

### The Mortgage Update

Get weekly insights and the best deals with our Mortgage Update, your shortcut to navigating the complex mortgage landscape confidently.



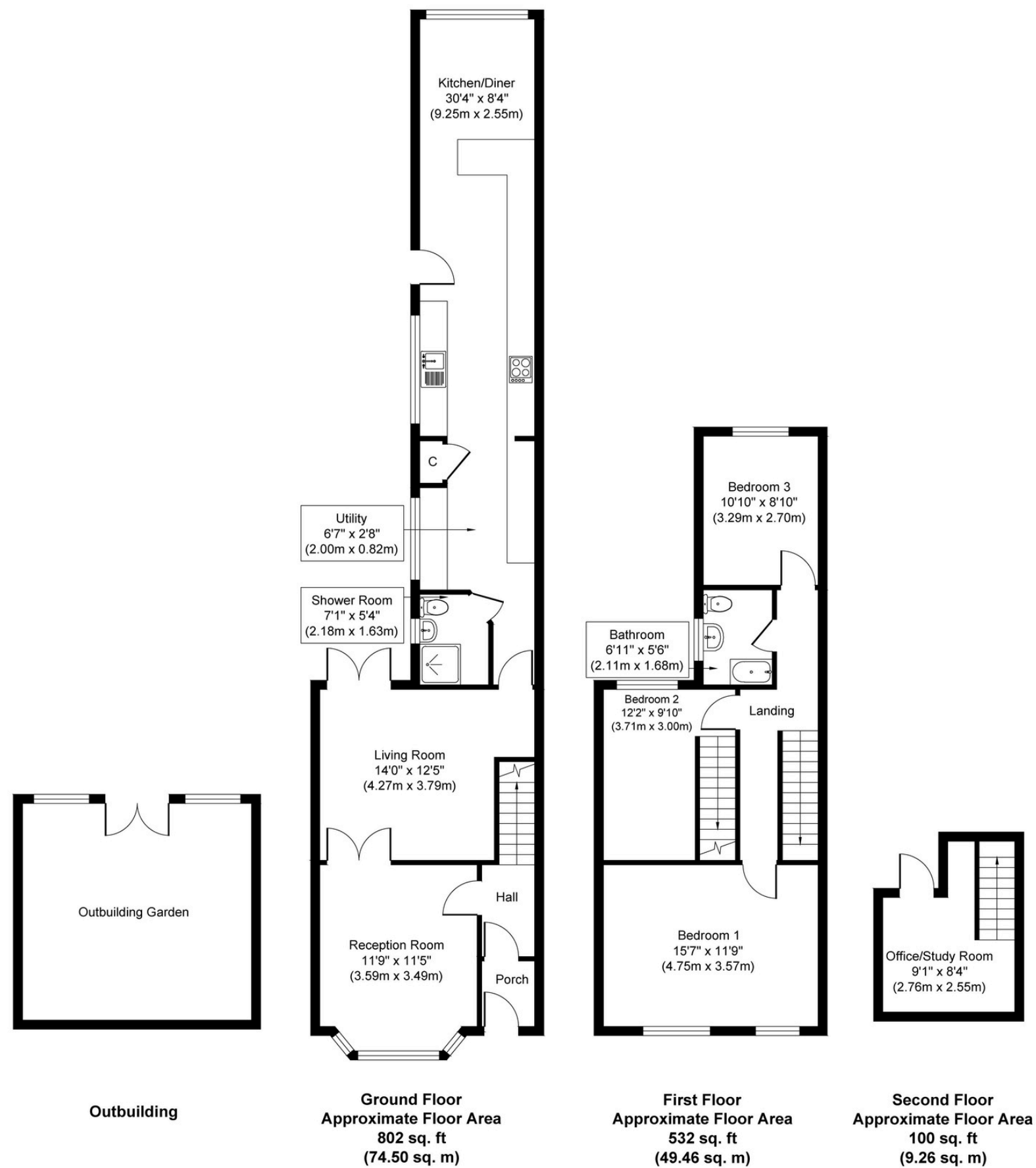

Whilst every attempt has been made to ensure the accuracy of the floor plan contained here, measurements of doors, windows, rooms and any other items are approximate and no responsibility is taken for any error, omission, or mis-statement. The measurements should not be relied upon for valuation, transaction and/or funding purposes. This plan is for illustrative purposes only and should be used as such by any prospective purchaser or tenant.

The services, systems and appliances shown have not been tested and no guarantee as to their operability or efficiency can be given.

Copyright V360 Ltd 2025 | [www.houseviz.com](http://www.houseviz.com)