



DM&Co.
— SALES & LETTINGS —

29 Marie Drive
B27 7NY

A Beautifully Presented Three-Bedroom Home Offering Modern Interiors, A Private Garden, And A Convenient Location, Offered Unfurnished & Available Now!



DETAILS

This beautifully maintained three bedroom mid-terrace home is perfectly suited for families or professionals looking for a spacious and modern rental in the heart of Acocks Green. Offered unfurnished & is available for an immediate occupancy.

The property features a stylish, re-fitted kitchen at the front of the house, offering a contemporary space for cooking and dining. To the rear, a generously sized lounge provides a bright and comfortable area for relaxing or entertaining, with direct access to the rear garden — ideal for summer evenings or weekend downtime.

Upstairs, the home offers three bedrooms: two well-proportioned doubles and a third single bedroom, perfect for a home office, nursery, or guest room. The family shower room has been updated with a sleek, modern finish, ensuring convenience and comfort.

Birmingham Council - Tax B



OUTSIDE

Outside, the property benefits from a private rear garden — a great space for outdoor living and low-maintenance enjoyment.

Parking is on road.

Located within easy reach of local amenities, schools, and transport links, this home offers both practicality and comfort in a sought-after residential area.



GENERAL INFORMATION

Mobile Coverage In Your Area - EE, Vodafone, Three, O2

Broadband Coverage In Your Area - Openreach, Sky

Basic - 26 Mbps

Ultrafast - 1800 Mbps

OTHER SERVICES

DM & Co are pleased to offer the following services:-

Residential Lettings: If you are considering letting your property, please contact the office on 0121 775 0101.

Mortgage Services: If you would like advice on the best mortgages available, please contact us on 0121 775 0101.

Agents Note: Whilst every care has been taken to prepare these sales particulars, they are for guidance purposes only. All measurements are approximate and are for general guidance purposes only and whilst every care has been taken to ensure their accuracy, they should not be relied upon and potential buyers are advised to recheck the measurements.

FEATURES

- Well Presented Three Bedroom Mid-Terrace Home
- Modern Re-Fitted Kitchen And Contemporary Shower Room
- Spacious Lounge With Access To Private Rear Garden
- Ideal For Families Or Professional Tenants
- Located Close To Amenities, Schools, And Transport Links
- Low Maintenance Rear Garden Perfect For Outdoor Enjoyment
- Holding Deposit - £300.00
- Security Deposit - £1500.00
- Unfurnished
- Available Now

VIEWING

Book a viewing with Sole Agents DM & Co.
Premium by phone or email:

📞 0121 775 0101

@ lettings@dmandcohomes.co.uk

Agents Note: Whilst every care has been taken to prepare these salesparticulars, they are for guidance purposes only. All measurements are approximate and are for general guidance purposes only and whilst every care has been taken to ensure their accuracy, they should not be relied upon and potential buyers are advised to recheck the measurements

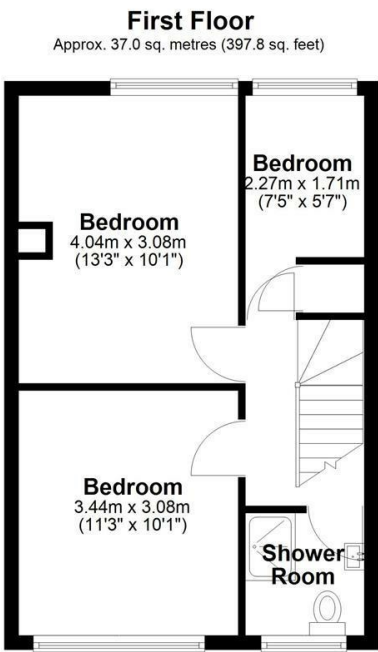
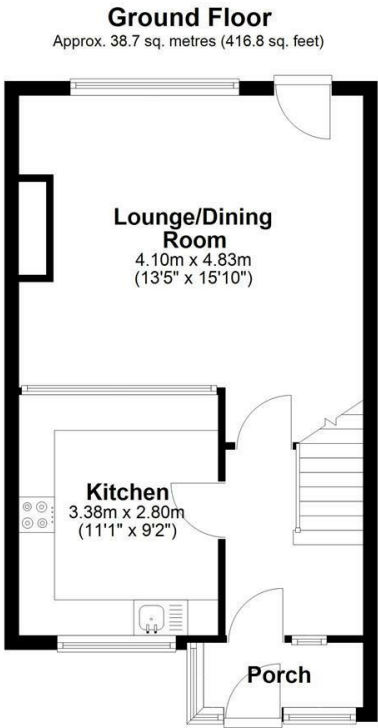

Total area: approx. 75.7 sq. metres (814.6 sq. feet)

This floor plan is for illustration purposes only, this is not intended to be a measured/scaled survey or comply with RICS guidelines. All measurements (including total floor area) openings, orientation and floor area are approximate. No details are guaranteed, they cannot be relied upon for any purpose and do not form part of any agreement. A party must rely upon its own inspection(s). No responsibility is taken for any error, omission, or mis-statement.
Plan produced using PlanUp.

