

Need a Mortgage in principle
to make offers? Call us now
for quick assistance!
0121 775 0101



Do you need to sell?
Start your journey now!
Call us we can help.
0121 775 0101



SCAN FOR MORE INFO
SIZE - 2044 Sq Ft
TENURE - Freehold
COUNCIL TAX - Solihull Metropolitan Borough Council - D
BROADBAND - Upload Max 1000Mbps
Download Max 1800Mbps
MOBILE - O2
EPC - 69 - C
PARKING - For at least 4 Cars
FLOODRISK - Very Low
SERVICES - Mains
COVENANTS - N/A

Are you an investor
interested in expanding your
portfolio?

**Call 0121 775 0101 to provide your
investment criteria for alerts.**

THE LODGE, RICHMOND ROAD

Olton, B92

This remarkable, unique 4 bedroom detached house, built in 1870, offers a perfect blend of character and modern living. It has been thoughtfully extended to provide generous accommodation for both relaxation and entertainment and offers a harmonious blend of space, style and functionality, making it an ideal family home in a sought-after location.

FEATURES

- Detached Character Property
- Thoughtfully Extended to Create Spacious Accommodation Throughout
- Snug & Study/Bedroom
- Large Lounge/Dining Room with Feature Beam & Log Burner
- Stunning Breakfast Kitchen with Separate Utility Room
- Principal Bedroom with En-Suite to Ground Floor
- Further Ground Floor Double Bedroom
- Two Good Sized Double Bedrooms to First Floor & Family Bathroom
- Private Rear Garden with Decked Area & Lawn Beyond
- Driveway Parking for up to Four Vehicles & Single Garage
- Close to Olton Train Station



SCAN TO **VIEW OUR**
WEEKLY FILMS &
SUBSCRIBE

Sneak Peeks

Every week, we unveil "Sneak Peeks," a feature showcasing exclusive properties before they hit Rightmove and other platforms.

The Landlord Club

Join our Landlord Club for weekly updates on legislation, market trends, and our Letting Director's 'Investment Pick of the Week' for optimal ROI.

HTSPMD

Tune into 'How's The Solihull Property Market Dom' weekly for a quick, insightful snapshot of the market.

The Mortgage Update

Get weekly insights and the best deals with our Mortgage Update, your shortcut to navigating the complex mortgage landscape confidently.

Ground Floor

Approx. 142.1 sq. metres (1529.7 sq. feet)

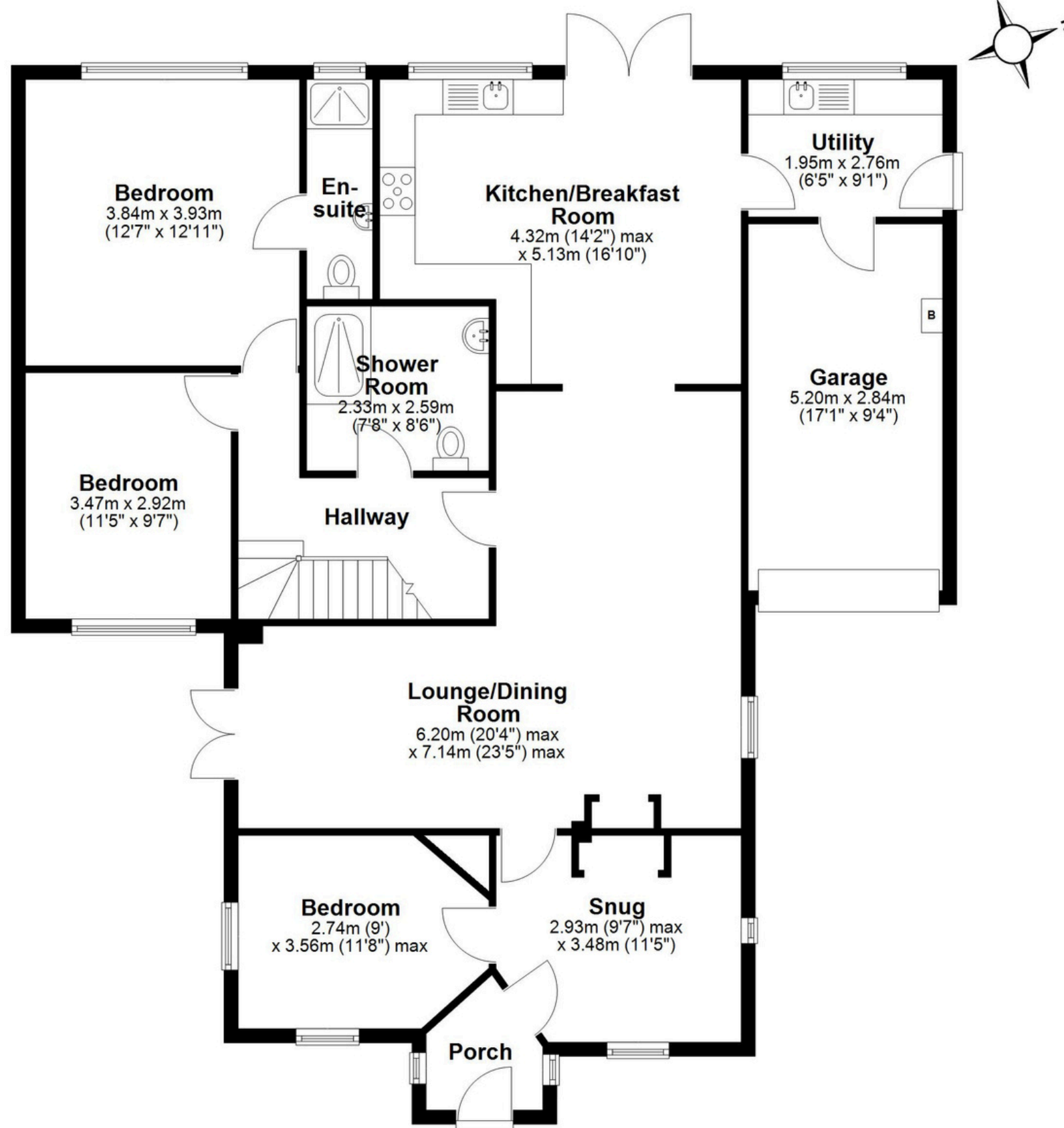

First Floor

Approx. 47.8 sq. metres (514.6 sq. feet)

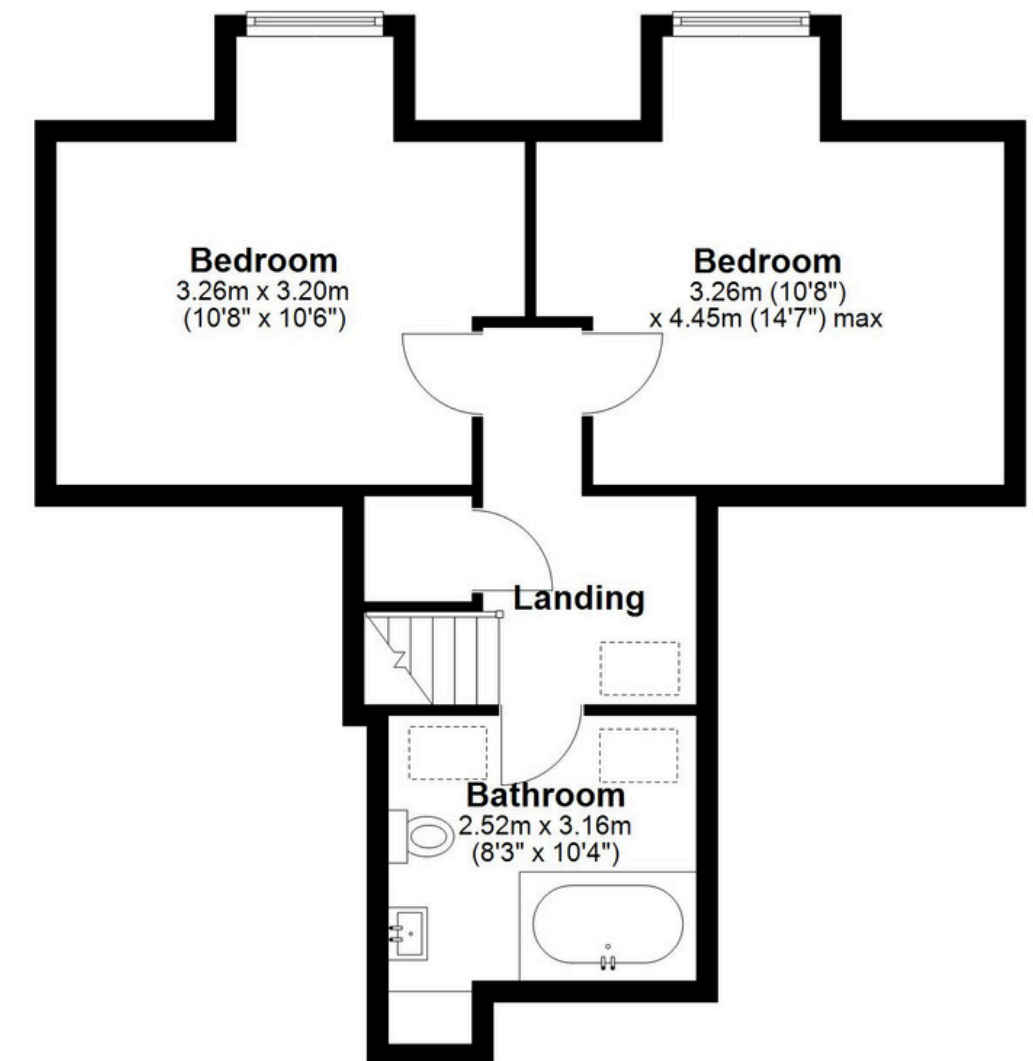

Total area: approx. 189.9 sq. metres (2044.3 sq. feet)

This floor plan is for illustration purposes only, this is not intended to be a measured/scaled survey or comply with RICS guidelines. All measurements (including total floor area) openings, orientation and floor area are approximate. No details are guaranteed, they cannot be relied upon for any purpose and do not form part of any agreement. A party must rely upon its own inspection(s). No responsibility is taken for any error, omission, or mis-statement.
Plan produced using PlanUp.