

Need a Mortgage in principle
to make offers? Call us now
for quick assistance!
0121 775 0101



Do you need to sell?
Start your journey now!
Call us we can help.
0121 775 0101



SCAN FOR MORE INFO
SIZE - 1553 Sq Ft
TENURE - Freehold
COUNCIL TAX - Solihull Metropolitan Borough Council - E
BROADBAND - Upload Max 1000Mbps
Download 1800Mbps
MOBILE - O2 Vodafone
EPC - D - 61
PARKING - Ample Driveway Parking
FLOODRISK - Very Low
SERVICES - Mains
COVENANTS - N/A

Are you an investor
interested in expanding your
portfolio?

**Call 0121 775 0101 to provide your
investment criteria for alerts.**

BURYFIELD ROAD

Solihull, B91

This impressive semi-detached family home offers a perfect blend of space, style and comfort. Set on a desirable corner plot, it offers fantastic potential to extend (subject to planning permission). This is an exceptional opportunity for families seeking a spacious and well presented residence in a sought after location.

FEATURES

- Spacious Semi-Detached Family Home on a Corner Plot
- Tastefully Presented Throughout
- Two Reception Rooms
- Stunning Breakfast Kitchen
- Utility Room & Guest Cloakroom
- Two Good Sized Double Bedrooms with Fitted Wardrobes
- Double Bedroom Three
- Family Bathroom
- Ample Driveway Parking with Single Garage
- Wrap Around Private Rear Garden
- Potential to Extend (STPP)



SCAN TO **VIEW OUR
WEEKLY FILMS &
SUBSCRIBE**

Sneak Peeks

Every week, we unveil "Sneak Peeks," a feature showcasing exclusive properties before they hit Rightmove and other platforms.

The Landlord Club

Join our Landlord Club for weekly updates on legislation, market trends, and our Letting Director's 'Investment Pick of the Week' for optimal ROI.

HTSPMD

Tune into 'How's The Solihull Property Market Dom' weekly for a quick, insightful snapshot of the market.

The Mortgage Update

Get weekly insights and the best deals with our Mortgage Update, your shortcut to navigating the complex mortgage landscape confidently.

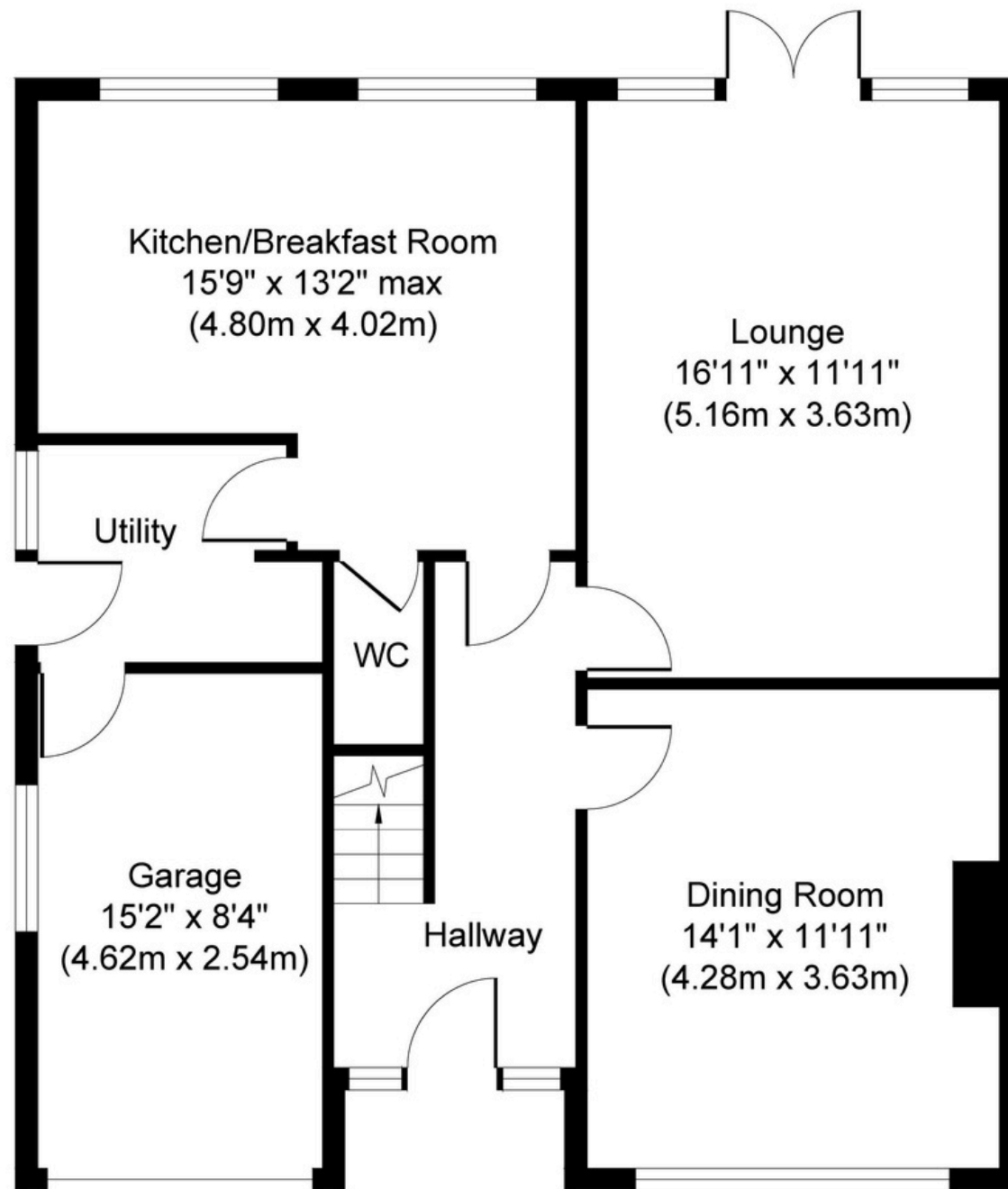

Ground Floor
Approximate Floor Area
852 sq. ft
(79.20 sq. m)

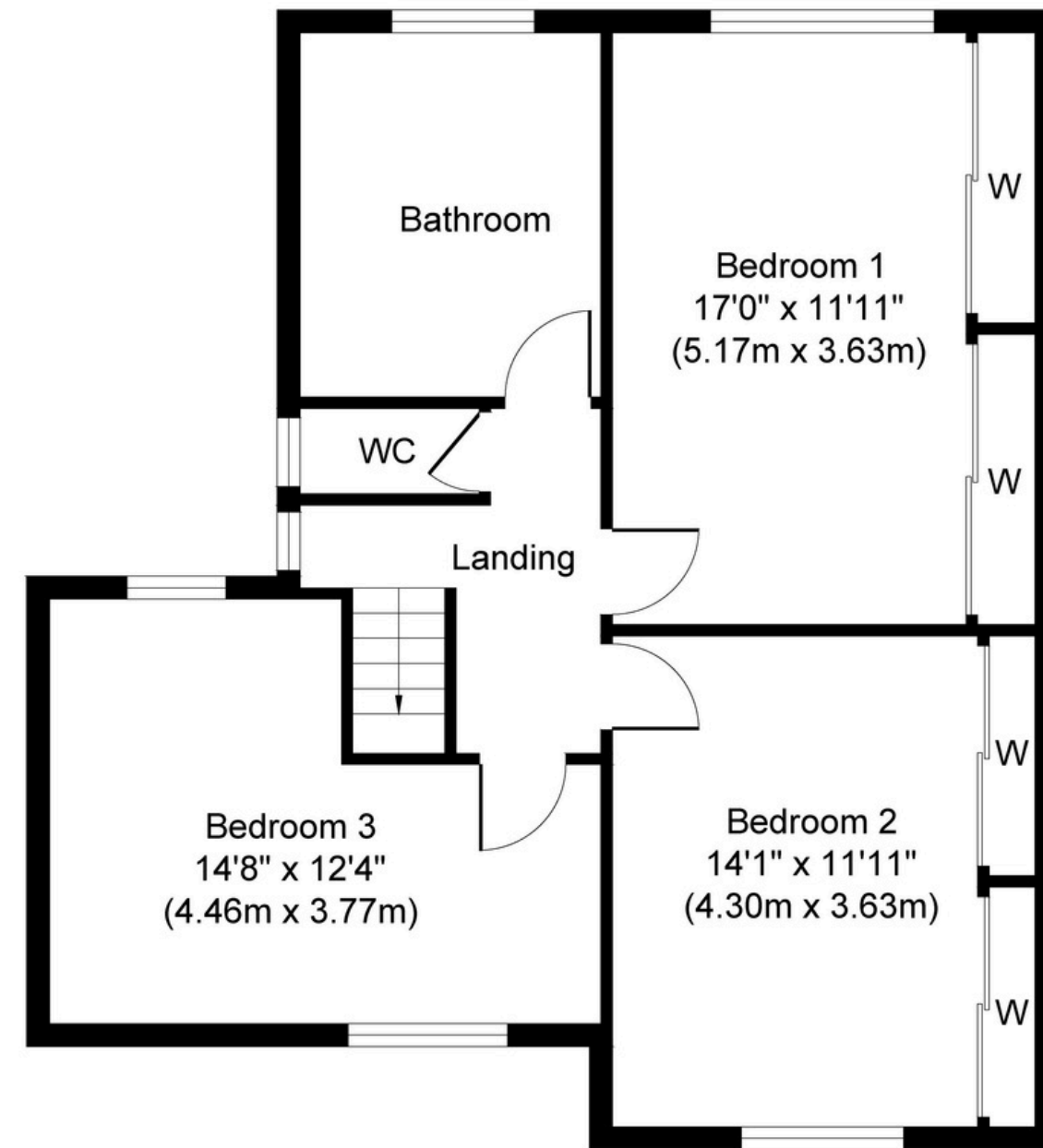

First Floor
Approximate Floor Area
701 sq. ft
(65.20 sq. m)

Whilst every attempt has been made to ensure the accuracy of the floor plan contained here, measurements of doors, windows, rooms and any other items are approximate and no responsibility is taken for any error, omission, or mis-statement. The measurements should not be relied upon for valuation, transaction and/or funding purposes. This plan is for illustrative purposes only and should be used as such by any prospective purchaser or tenant.

The services, systems and appliances shown have not been tested and no guarantee as to their operability or efficiency can be given.

Copyright V360 Ltd 2025 | www.houseviz.com