

Need a Mortgage in principle
to make offers? Call us now
for quick assistance!
0121 775 0101



Do you need to sell?
Start your journey now!
Call us we can help.
0121 775 0101



SHELSLEY WAY

Hillfield, B91

SCAN FOR MORE INFO
SIZE - 1133 Sq Ft
TENURE - Freehold
COUNCIL TAX - Solihull Metropolitan Borough Council - D
BROADBAND - Upload Max 1000Mbps
Download Max 1000Mbps
MOBILE - EE Vodafone
EPC - C - 73
PARKING - For at least 2 Cars
FLOOD RISK - Very Low
SERVICES - Mains
COVENANTS - N/A

Are you an investor
interested in expanding your
portfolio?

**Call 0121 775 0101 to provide your
investment criteria for alerts.**

A beautifully presented end terrace house that offers a perfect blend of modern living and family comfort. This charming family home in Tudor Grange school catchment is not to be missed, offering a wonderful opportunity for those seeking a peaceful yet convenient lifestyle in Solihull.

FEATURES

- Extended and Well Presented Family Home
- Bright Lounge to the Front
- Stunning Breakfast Kitchen with Integrated Appliances
- Separate Utility Room with Guest Cloakroom
- Second Reception Room
- Principal Bedroom wit En-Suite Shower Room
- Second Double Bedroom and Third Single
- Luxury Modern Family Bathroom
- Private South Facing Rear Garden
- Driveway Parking for Twp Vehicles
- Tudor Grange School Catchment



SCAN TO **VIEW OUR
WEEKLY FILMS &
SUBSCRIBE**

Sneak Peeks

Every week, we unveil "Sneak Peeks," a feature showcasing exclusive properties before they hit Rightmove and other platforms.

The Landlord Club

Join our Landlord Club for weekly updates on legislation, market trends, and our Letting Director's 'Investment Pick of the Week' for optimal ROI.

HTSPMD

Tune into 'How's The Solihull Property Market Dom' weekly for a quick, insightful snapshot of the market.

The Mortgage Update

Get weekly insights and the best deals with our Mortgage Update, your shortcut to navigating the complex mortgage landscape confidently.

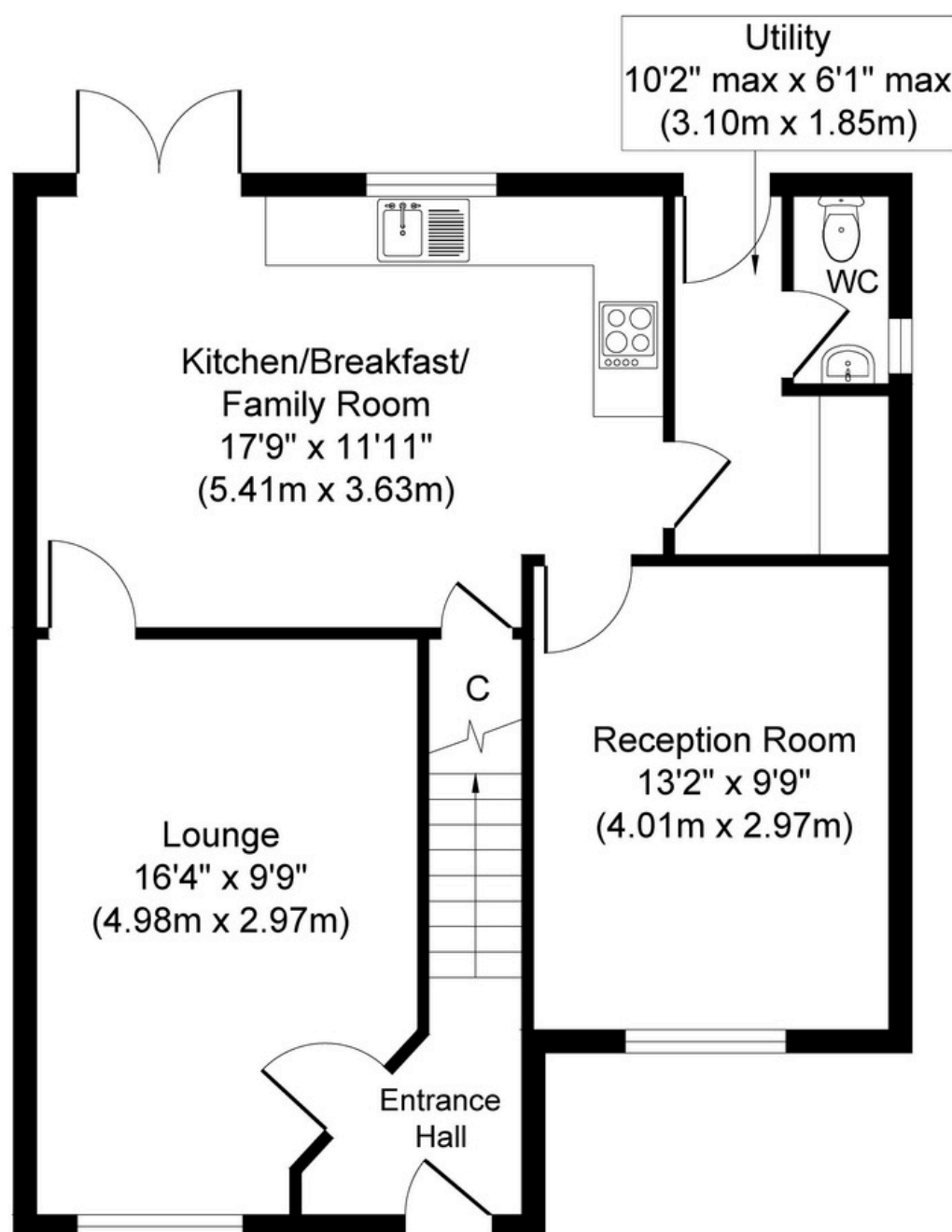

Ground Floor
Approximate Floor Area
643 sq. ft
(59.77 sq. m)

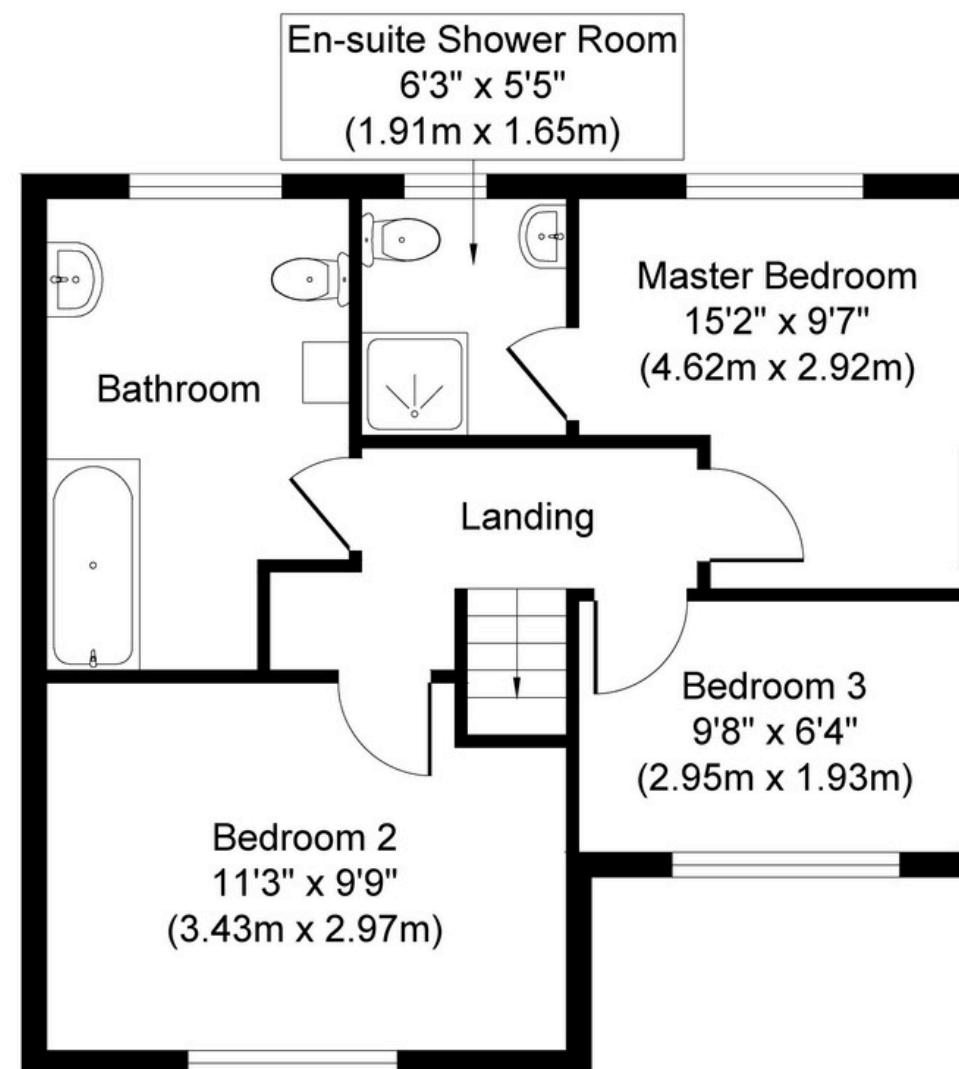

First Floor
Approximate Floor Area
490 sq. ft
(45.54 sq. m)

Whilst every attempt has been made to ensure the accuracy of the floor plan contained here, measurements of doors, windows, rooms and any other items are approximate and no responsibility is taken for any error, omission, or mis-statement. The measurements should not be relied upon for valuation, transaction and/or funding purposes. This plan is for illustrative purposes only and should be used as such by any prospective purchaser or tenant.

The services, systems and appliances shown have not been tested and no guarantee as to their operability or efficiency can be given.

Copyright V360 Ltd 2025 | www.houseviz.com