

Need a Mortgage in principle to make offers? Call us now for quick assistance!
0121 775 0101

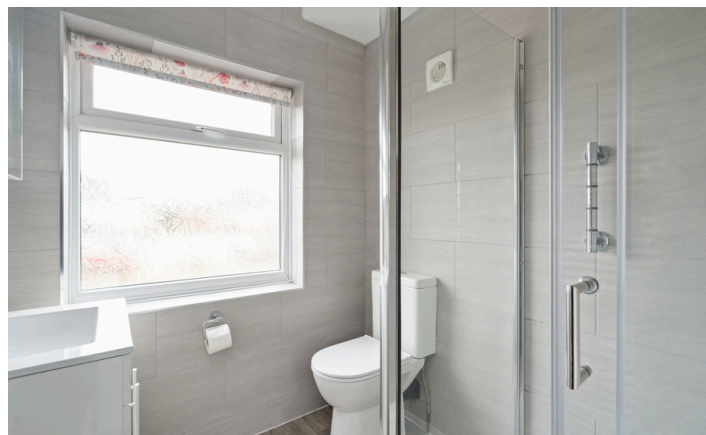

Do you need to sell? Start your journey now! Call us we can help.
0121 775 0101



SCAN FOR MORE INFO
SIZE - 1256 Sq Ft
TENURE - Freehold
COUNCIL TAX - Solihull MBC -
EDBROADBAND - Upload Max 1000Mbps
Download Max 1000Mbps
MOBILE - Vodafone
EPC - B - 83
PARKING - For at least 3 Cars
FLOODRISK - Very Low
SERVICES - Mains
COVENANTS - N/A

ULLERIES ROAD

Offers in the region of £350,000

Although in need of updating, this property brims with potential for further extension (STPP), allowing you to unleash your creativity and make it your own. Having been cherished by the vendors for 65 years, this house is now ready for a new chapter with its next lucky owners.

FEATURES

- Traditional Semi-Detached with Potential to Extend (STPP)
- Requiring Some Updating
- Dining Room with Bay Window
- Spacious Lounge
- Kitchen with Large Utility Area
- Two Double Bedrooms & Third Single
- Modern Family Bathroom
- Private & Mature Rear Garden
- Driveway Parking & Single Garage
- Convenient Location

Are you an investor interested in expanding your portfolio?

Call 0121 775 0101 to provide your investment criteria for alerts.



SCAN TO VIEW OUR WEEKLY FILMS & SUBSCRIBE

Sneak Peeks

Every week, we unveil "Sneak Peeks," a feature showcasing exclusive properties before they hit Rightmove and other platforms.

The Landlord Club

Join our Landlord Club for weekly updates on legislation, market trends, and our Letting Director's 'Investment Pick of the Week' for optimal ROI.

HTSPMD

Tune into 'How's The Solihull Property Market Dom' weekly for a quick, insightful snapshot of the market.

The Mortgage Update

Get weekly insights and the best deals with our Mortgage Update, your shortcut to navigating the complex mortgage landscape confidently.

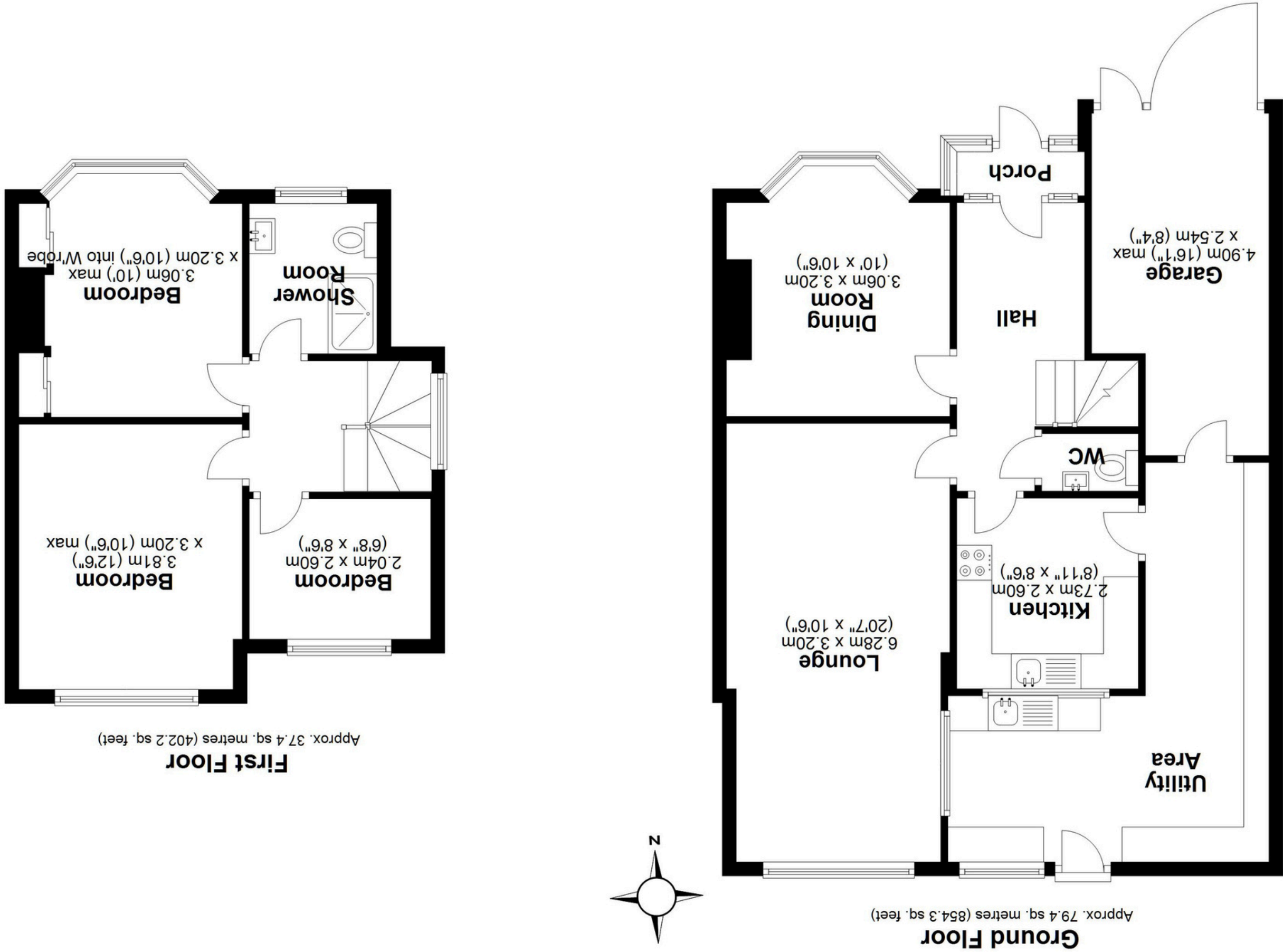

Total area: approx. 116.7 sq. metres (1256.5 sq. feet)

This floor plan is for illustration purposes only, this is not intended to be a measured/scaled survey or comply with RICS guidelines. All measurements (including total floor area) openings, orientation and floor area are approximate. No details are guaranteed, they cannot be relied upon for any purpose and do not form part of any agreement. A party must rely upon its own inspection(s). No responsibility is taken for any error, omission, or mis-statement.
Plan produced using PlanUp.

