

Need a Mortgage in principle to make offers? Call us now for quick assistance!  
0121 775 0101



Do you need to sell? Start your journey now! Call us we can help.  
01564 777 314



## Apartment 20 Eleanor Lodge

Guide Price of £450,000



**SCAN FOR MORE INFO**  
**SIZE** - 846 Sq Ft  
**TENURE** - Leasehold  
**COUNCIL TAX** - Solihull Metropolitan Borough Council E  
**BROADBAND** - Upload Max 1000 Mbps  
Download Max 1000 Mbps  
**MOBILE** - Vodafone, O2  
**EPC** - B  
**PARKING** - Free Parking  
**FLOODRISK** - No Risk  
**SERVICES** - Mains  
**COVENANTS** - N/A

Are you an investor interested in expanding your portfolio?

Call 01564 777 314 to provide your investment criteria for alerts.

This spacious two-bedroom apartment built in 2020, perfectly combines modern living with exceptional convenience. Located in a prime area with easy access to public transport links, it is ideal for those seeking a comfortable, low-maintenance lifestyle

### FEATURES

- First Floor Apartment
- Large Dual Aspect Lounge/Dining Room
- Fitted Modern Kitchen
- Two Double Bedrooms
- Ample Storage
- Emergency Call System
- Free Parking
- Short Walk to Knowle High Street
- No Upward Chain

### Sneak Peeks

Every week, we unveil "Sneak Peeks," a feature showcasing exclusive properties before they hit Rightmove and other platforms.

### HTSPMD

Tune into 'How's The Solihull Property Market Dom' weekly for a quick, insightful snapshot of the market.

### The Landlord Club

Join our Landlord Club for weekly updates on legislation, market trends, and our Letting Director's 'Investment Pick of the Week' for optimal ROI.

### The Mortgage Update

Get weekly insights and the best deals with our Mortgage Update, your shortcut to navigating the complex mortgage landscape confidently.



SCAN TO VIEW OUR WEEKLY FILMS & SUBSCRIBE

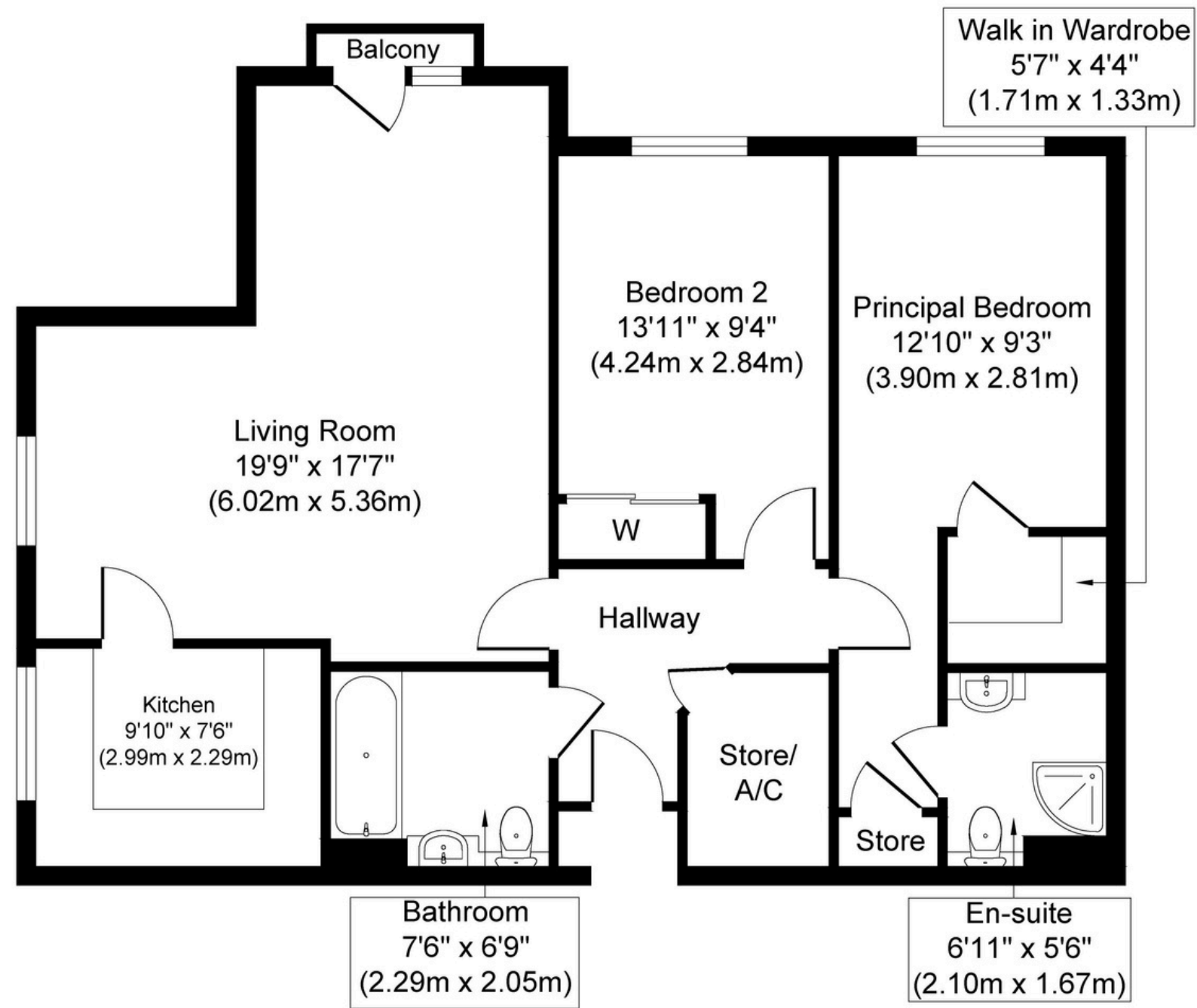

**Approximate Floor Area**  
**846 sq. ft**  
**(78.6 sq. m)**

Whilst every attempt has been made to ensure the accuracy of the floor plan contained here, measurements of doors, windows, rooms and any other items are approximate and no responsibility is taken for any error, omission, or mis-statement. The measurements should not be relied upon for valuation, transaction and/or funding purposes. This plan is for illustrative purposes only and should be used as such by any prospective purchaser or tenant. The services, systems and appliances shown have not been tested and no guarantee as to their operability or efficiency can be given.