

**Need a Mortgage in principle to make offers?** Call us now for quick assistance!  
**0121 775 0101**



**Do you need to sell? Start your journey now!** Call us we can help.  
**0121 775 0101**



**SCAN FOR MORE INFO**  
**SIZE** - 1763 Sq Ft  
**TENURE** - Freehold  
**COUNCIL TAX** - Solihull MBC - E  
**BROADBAND** - Upload Max 1000MBps  
Download Max 1000MBps  
**MOBILE** - O2 Vodaphone  
**EPC** - D - 67  
**PARKING** - For at least 4 Cars  
**FLOODRISK** - Very Low  
**SERVICES** - Mains  
**COVENANTS** - N/A

## SCHOOL ROAD

**Offers Over £475,000**

Located on School Road in Shirley, the house has been lovingly owned by the same family since its construction in 1976 and is now ready for a new chapter with its next owners. With the potential to extend or convert (STPP) this property is offered with no upward chain.

### FEATURES

- Detached Family Home with No Upward Chain
- Fantastic Potential
- Galley Style Fitted Kitchen
- Two Reception Rooms
- Conservatory
- Four Bedrooms
- Re-Fitted Shower Room
- Driveway Parking & Single Garage
- Mature Rear Garden
- Excellent Location

**Are you an investor interested in expanding your portfolio?**

**Call 0121 775 0101 to provide your investment criteria for alerts.**



**SCAN TO VIEW OUR WEEKLY FILMS & SUBSCRIBE**

### Sneak Peeks

Every week, we unveil "Sneak Peeks," a feature showcasing exclusive properties before they hit Rightmove and other platforms.

### The Landlord Club

Join our Landlord Club for weekly updates on legislation, market trends, and our Letting Director's 'Investment Pick of the Week' for optimal ROI.

### HTSPMD

Tune into 'How's The Solihull Property Market Dom' weekly for a quick, insightful snapshot of the market.

### The Mortgage Update

Get weekly insights and the best deals with our Mortgage Update, your shortcut to navigating the complex mortgage landscape confidently.

Whilst every attempt has been made to ensure the accuracy of the floor plan contained here, measurements of doors, windows, rooms and any other items are approximate and no responsibility is taken for any error, omission, or mis-statement. The measurements should not be relied upon for valuation, transaction and/or funding purposes. This plan is for illustrative purposes only and should be used as such by any prospective purchaser or tenant. The services, systems and appliances shown have not been tested and no guarantee as to their operability or efficiency can be given.

Copyright V360 Ltd 2024 | www.houseviz.com

**Ground Floor**  
 1184 sq. ft  
 Approximate Floor Area  
 (109.97 sq. m)

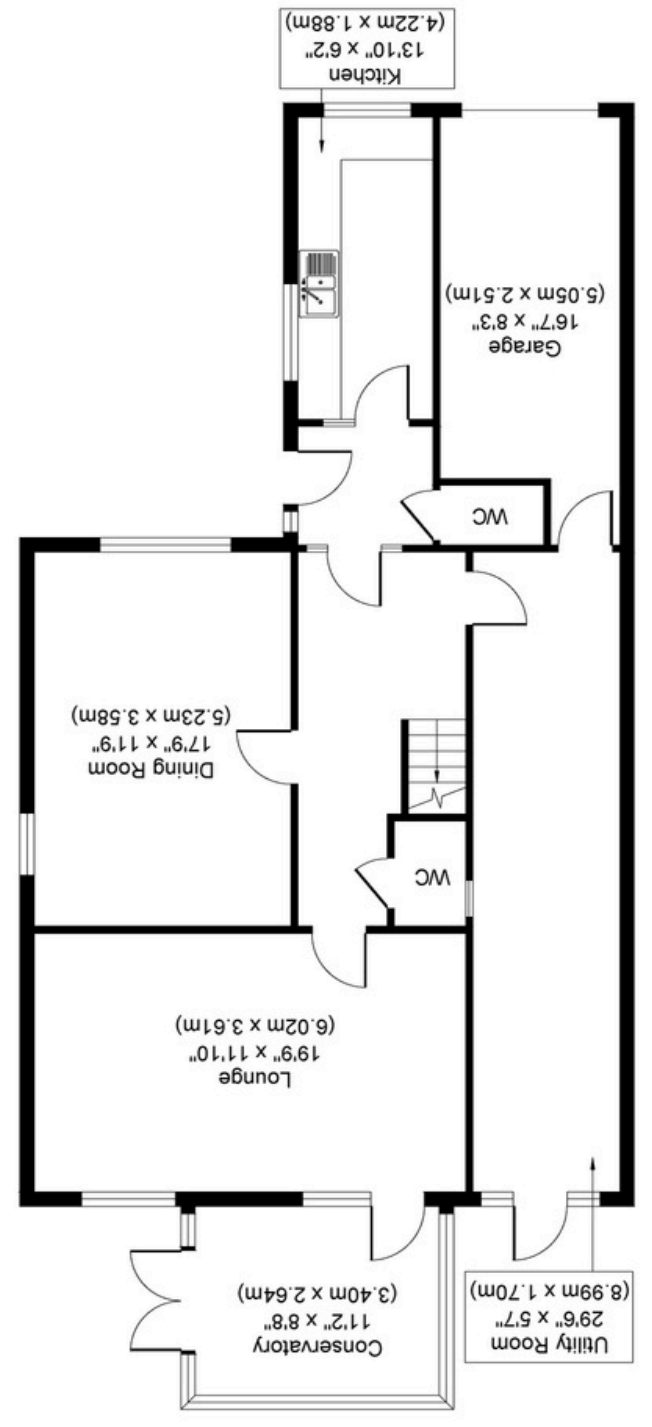

**First Floor**  
 579 sq. ft  
 Approximate Floor Area  
 (53.81 sq. m)

