

**Need a Mortgage in principle to make offers?** Call us now for quick assistance!  
**0121 775 0101**



**Do you need to sell? Start your journey now!** Call us we can help.  
**0121 775 0101**



**SCAN FOR MORE INFO**  
**SIZE** - 1187 Sq Ft  
**TENURE** - Freehold  
**COUNCIL TAX** - Solihull MBC - D  
**BROADBAND** - Upload Max 1000Mbps  
 Download Max 1000Mbps  
**MOBILE** - Three O2 Vodaphone  
**EPC** - C - 71  
**PARKING** - For at least 2 Cars  
**FLOODRISK** - Very Low  
**SERVICES** - Mains  
**COVENANTS** - N/A

**MEREVALE ROAD**  
 Offers in the region of **£400,000**

Located on the desirable Merevale Road in Solihull, this stunning semi-detached house is a true gem waiting to be discovered. If you are looking for a beautifully presented home with modern decor throughout, look no further. This property seamlessly blends style with functionality, offering a comfortable and inviting space for you to call your own.

**FEATURES**

- Beautifully Presented Throughout
- Open Plan Lounge/Dining Room
- Breakfast/Kitchen with Integrated Appliances
- Three Double Bedrooms
- Modern Four Piece Family Bathroom
- Private South Facing Rear Garden
- Driveway Parking
- Single Garage
- Convenient Location

**Are you an investor interested in expanding your portfolio?**

**Call 0121 775 0101 to provide your investment criteria for alerts.**



SCAN TO VIEW OUR WEEKLY FILMS & SUBSCRIBE

**Sneak Peeks**

Every week, we unveil "Sneak Peeks," a feature showcasing exclusive properties before they hit Rightmove and other platforms.

**The Landlord Club**

Join our Landlord Club for weekly updates on legislation, market trends, and our Letting Director's 'Investment Pick of the Week' for optimal ROI.

**HTSPMD**

Tune into 'How's The Solihull Property Market Dom' weekly for a quick, insightful snapshot of the market.

**The Mortgage Update**

Get weekly insights and the best deals with our Mortgage Update, your shortcut to navigating the complex mortgage landscape confidently.

Whilst every attempt has been made to ensure the accuracy of the floor plan contained here, measurements of doors, windows, rooms and any other items are approximate and no responsibility is taken for any error, omission, or mis-statement. The measurements should not be relied upon for valuation, transaction and/or funding purposes. This plan is for illustrative purposes only and should be used as such by any prospective purchaser or tenant. The services, systems and appliances shown have not been tested and no guarantee as to their operability or efficiency can be given.

Copyright V360 Ltd 2024 | www.houseviz.com

**Ground Floor**  
**Approximate Floor Area**  
**644 sq. ft.**  
**(59.8 sq. m.)**

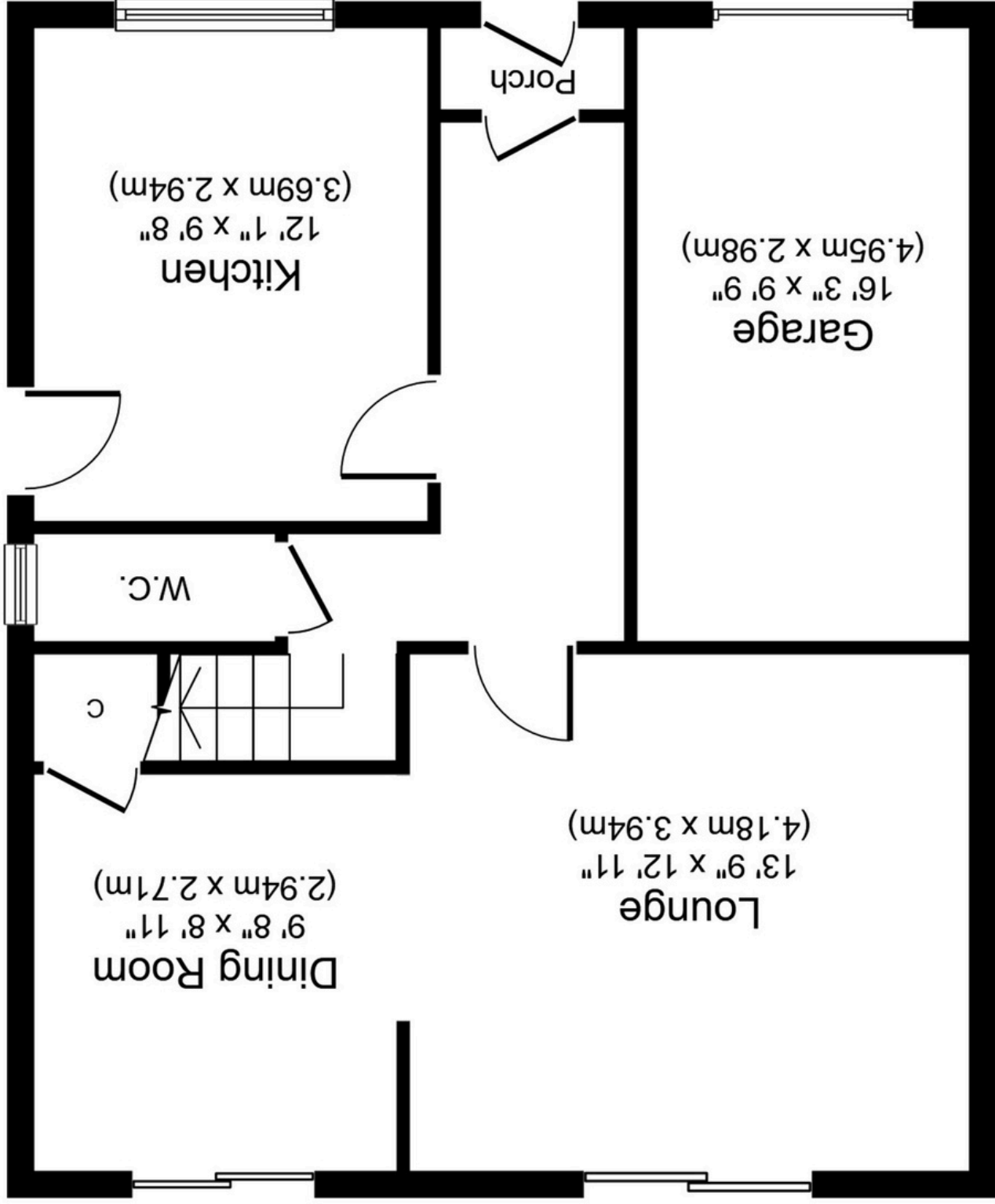

**First Floor**  
**Approximate Floor Area**  
**543 sq. ft.**  
**(50.5 sq. m.)**

