

Need a Mortgage in principle to make offers? Call us now for quick assistance!
0121 775 0101



Do you need to sell? Start your journey now! Call us we can help.
01564 777 314



56 Hertford Way, Knowle

Purchase price of £375,000



SCAN FOR MORE INFO
SIZE - 704 Sq Ft
TENURE - Freehold
COUNCIL TAX - Solihull Metropolitan Borough Council C
BROADBAND - Upload Max 220 Mbps
Download Max 1000 Mbps
MOBILE - EE, O2, Vodafone
EPC - B
PARKING - Driveway Parking
FLOODRISK - No Risk
SERVICES - Mains
COVENANTS - N/A

Are you an investor interested in expanding your portfolio?

Call 01564 777 314 to provide your investment criteria for alerts.

A modern two-bedroom semi-detached house with a beautifully landscaped garden. Situated in a quiet cul-de-sac, this property is within the desirable Arden Academy catchment area and offers convenient access to both Dorridge station and Knowle village.

FEATURES

- Modern Two Bedroom Semi Detached House
- Lounge with French Doors Leading to the Garden
- Kitchen with Fitted Appliances
- Convenient WC on the Ground Floor
- Benefitting from the remainder of the NHBC Warranty
- Main Bedroom with En Suite Shower room
- Off Road Parking for Two Cars
- Walking Distance to Dorridge Station
- NO UPWARD CHAIN

Sneak Peeks

Every week, we unveil "Sneak Peeks," a feature showcasing exclusive properties before they hit Rightmove and other platforms.

The Landlord Club

Join our Landlord Club for weekly updates on legislation, market trends, and our Letting Director's 'Investment Pick of the Week' for optimal ROI.

HTSPMD

Tune into 'How's The Solihull Property Market Dom' weekly for a quick, insightful snapshot of the market.

The Mortgage Update

Get weekly insights and the best deals with our Mortgage Update, your shortcut to navigating the complex mortgage landscape confidently.



SCAN TO VIEW OUR WEEKLY FILMS & SUBSCRIBE

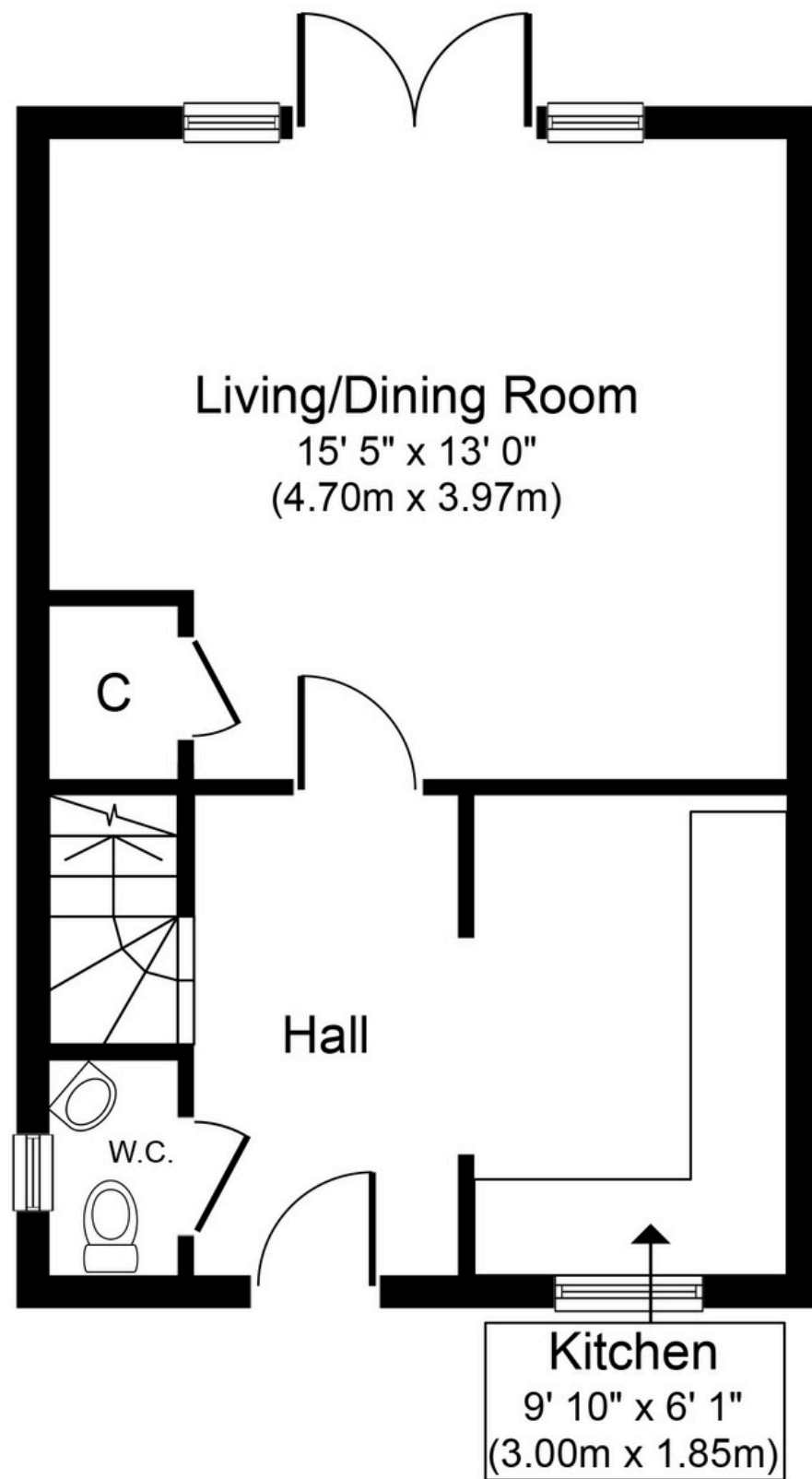

Ground Floor
Approximate Floor Area
352 sq. ft.
(32.7 sq. m.)

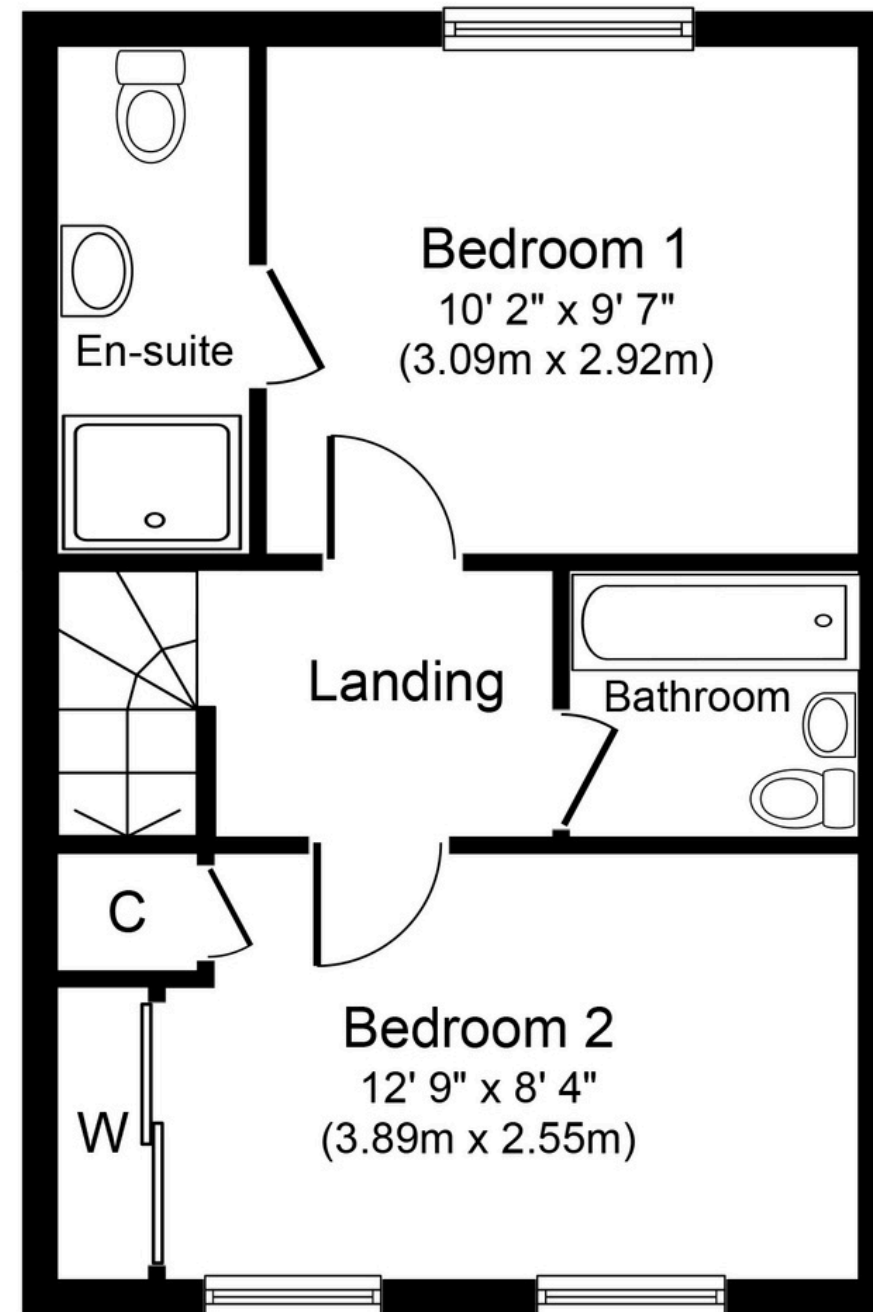

First Floor
Approximate Floor Area
352 sq. ft.
(32.7 sq. m.)

Whilst every attempt has been made to ensure the accuracy of the floor plan contained here, measurements of doors, windows, rooms and any other items are approximate and no responsibility is taken for any error, omission, or mis-statement. The measurements should not be relied upon for valuation, transaction and/or funding purposes. This plan is for illustrative purposes only and should be used as such by any prospective purchaser or tenant.

The services, systems and appliances shown have not been tested and no guarantee as to their operability or efficiency can be given.