

Need a Mortgage in principle to make offers? Call us now for quick assistance!
0121 775 0101



Do you need to sell? Start your journey now! Call us we can help.
01564 777 314



Box Trees, Old Warwick Road

Offers Over £500,000



SCAN FOR MORE INFO
SIZE - 1506 Sq Ft
TENURE - Freehold
COUNCIL TAX - Warwick Council - E
BROADBAND - Upload Max 1000 Mbps
 Download Max 220 Mbps
MOBILE - EE Three O2
EPC - B
PARKING - Driveway Parking
FLOODRISK - Very Low
SERVICES - Mains
COVENANTS - N/A

A rare opportunity to acquire this well presented three bedroom pre war semi-detached house in the heart of Lapworth Village. This extended family home is in a prime location being a short walk to Lapworth Train Station, primary school, famous local pubs, canal network and glorious countryside.

FEATURES

- Three Bedroom Semi-Detached House
- Dining Room
- Extended Lounge
- Breakfast Kitchen
- Modern Shower Room
- Large South West Facing Garden
- Detached Double Garage
- Fantastic Village Location
- A Short Walk to Local Ameniti

Are you an investor interested in expanding your portfolio?

Call 01564 777 314 to provide your investment criteria for alerts.



SCAN TO VIEW OUR WEEKLY FILMS & SUBSCRIBE

Sneak Peeks

Every week, we unveil "Sneak Peeks," a feature showcasing exclusive properties before they hit Rightmove and other platforms.

The Landlord Club

Join our Landlord Club for weekly updates on legislation, market trends, and our Letting Director's 'Investment Pick of the Week' for optimal ROI.

HTSPMD

Tune into 'How's The Solihull Property Market Dom' weekly for a quick, insightful snapshot of the market.

The Mortgage Update

Get weekly insights and the best deals with our Mortgage Update, your shortcut to navigating the complex mortgage landscape confidently.

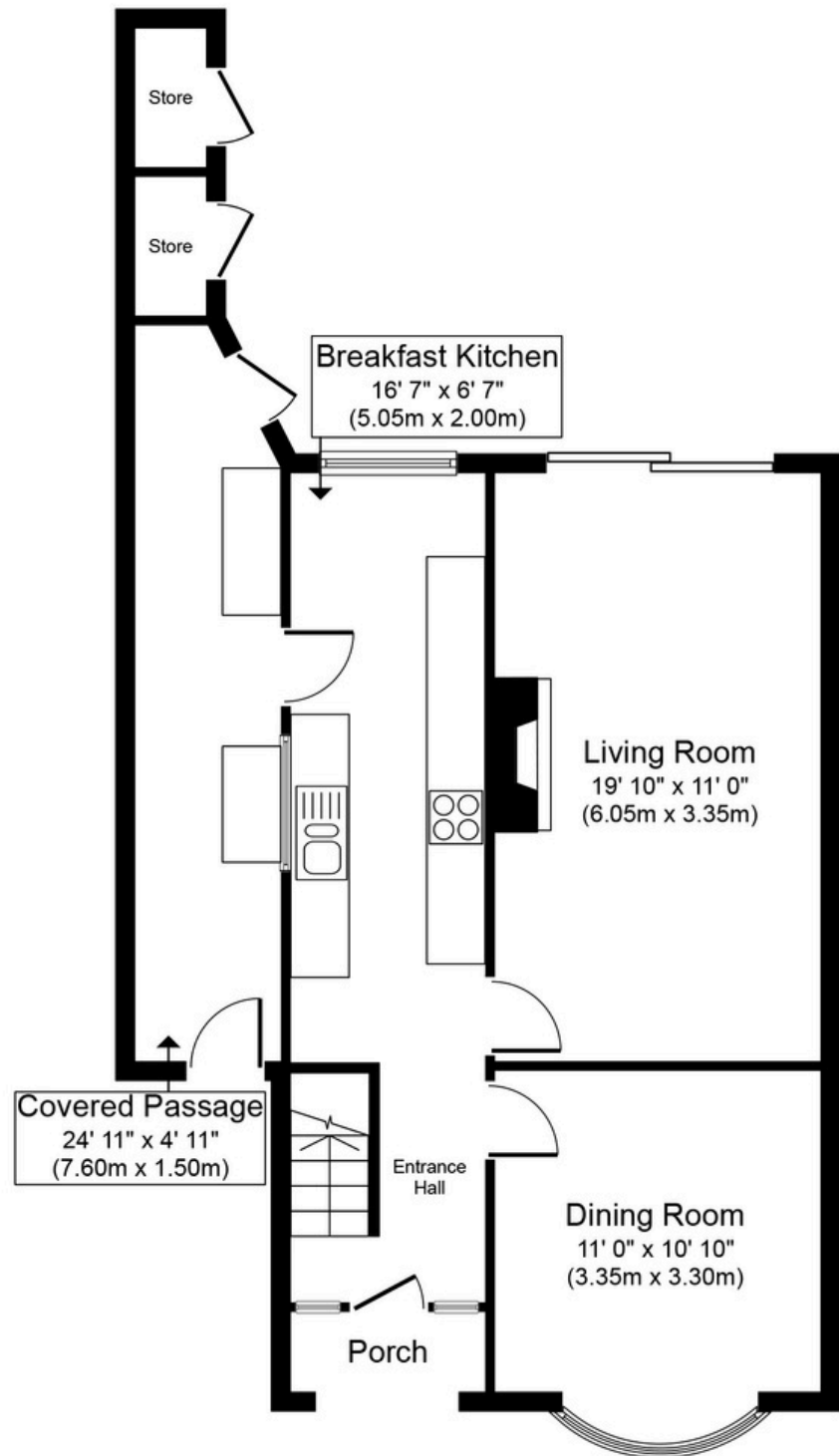

Ground Floor
Approximate Floor Area
645 sq. ft.
(60.0 sq. m.)

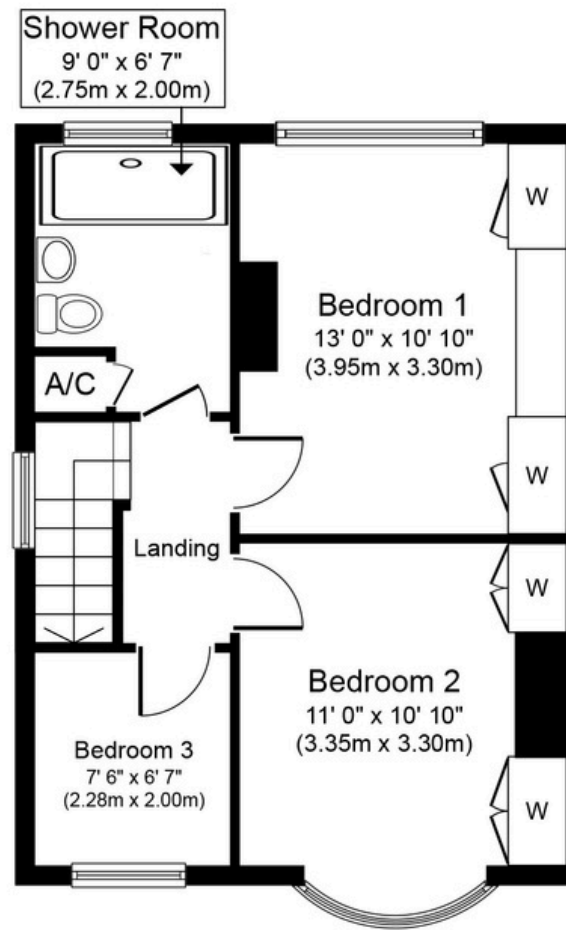

First Floor
Approximate Floor Area
442 sq. ft.
(41.0 sq. m.)

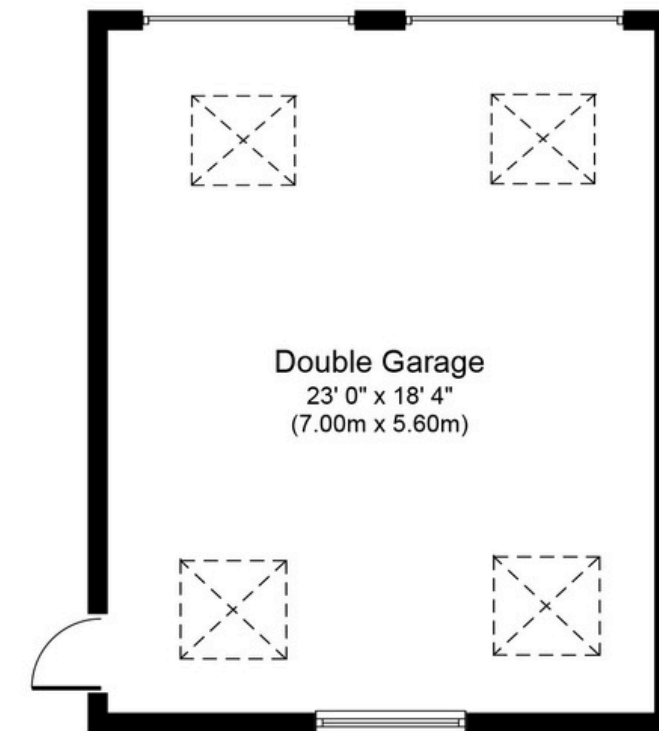

Double Garage
Approximate Floor Area
419 sq. ft.
(39.0 sq. m.)

Whilst every attempt has been made to ensure the accuracy of the floor plan contained here, measurements of doors, windows, rooms and any other items are approximate and no responsibility is taken for any error, omission, or mis-statement. The measurements should not be relied upon for valuation, transaction and/or funding purposes. This plan is for illustrative purposes only and should be used as such by any prospective purchaser or tenant.

The services, systems and appliances shown have not been tested and no guarantee as to their operability or efficiency can be given.