

Need a Mortgage in principle to make offers? Call us now for quick assistance!
0121 775 0101



Do you need to sell? Start your journey now! Call us we can help.
01564 777 314



SCAN FOR MORE INFO
SIZE - 1453 Sq Ft
TENURE - Freehold
COUNCIL TAX - Solihull MBC - D
MOBILE - O2
EPC - B - 83
PARKING - For at least 2 Cars
FLOODRISK - Very Low
SERVICES - Mains. Oil Fired Heating
COVENANTS - N/A

33 OAK LANE

Offers over £525,000

Nestled within Barston village, this beautifully presented four bedroom semi-detached property offers ample space for a family as well as delightful views of greenbelt fields from the landscaped south facing garden. Benefitting from close proximity to Knowle, Dorridge, Hampton-In-Arden and Solihull town centre yet in a semi rural location, this property really needs to be viewed to appreciate all that it has to offer.

FEATURES

- Immaculate Four Bedroom Semi-Detached
- Open Plan Breakfast Kitchen/Family Room
- Utility and Guest Cloakroom
- Three Double Bedrooms
- Large Family Bathroom
- Principal Bedroom to Second Floor with En-Suite
- South Facing Rear Garden
- Stunning Open Views
- Parking

Are you an investor interested in expanding your portfolio?

Call 01564 777 314 to provide your investment criteria for alerts.



SCAN TO VIEW OUR WEEKLY FILMS & SUBSCRIBE

Sneak Peeks

Every week, we unveil "Sneak Peeks," a feature showcasing exclusive properties before they hit Rightmove and other platforms.

The Landlord Club

Join our Landlord Club for weekly updates on legislation, market trends, and our Letting Director's 'Investment Pick of the Week' for optimal ROI.

HTSPMD

Tune into 'How's The Solihull Property Market Dom' weekly for a quick, insightful snapshot of the market.

The Mortgage Update

Get weekly insights and the best deals with our Mortgage Update, your shortcut to navigating the complex mortgage landscape confidently.

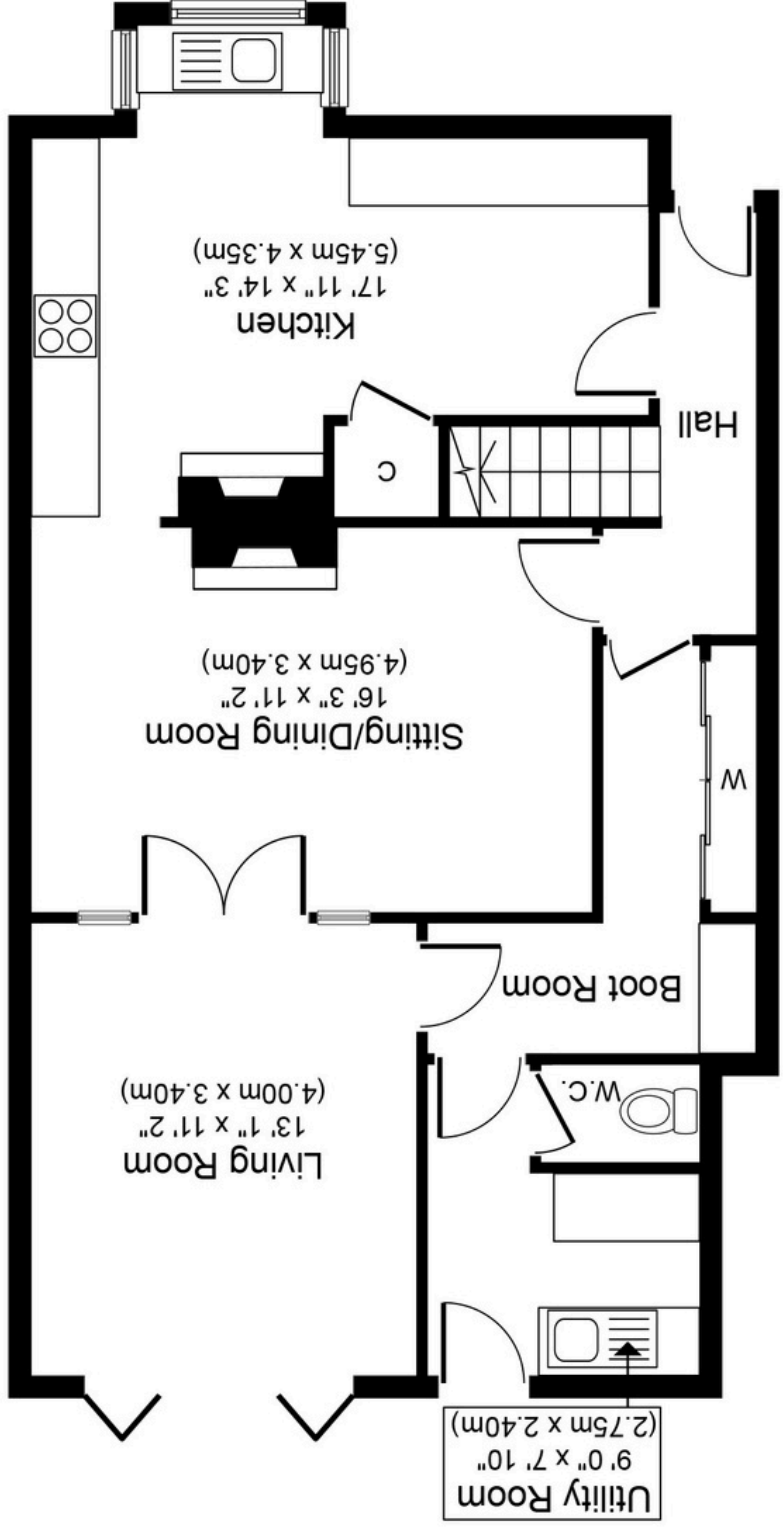

Ground Floor
698 sq. ft.
Approximate Floor Area
(64.8 sq. m.)

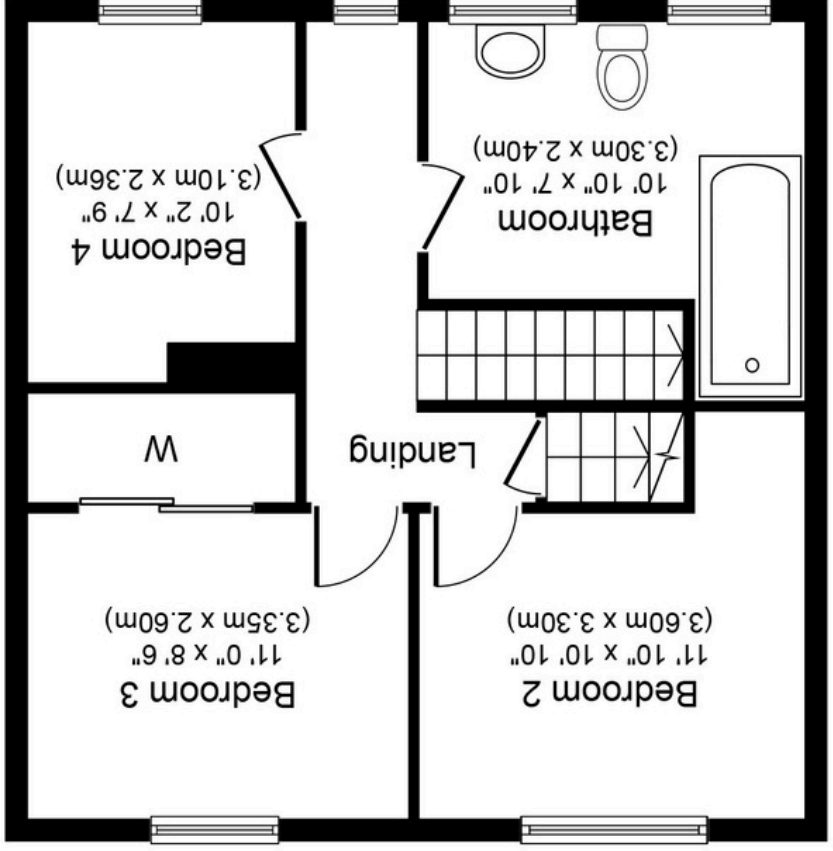

First Floor
437 sq. ft.
Approximate Floor Area
(40.6 sq. m.)

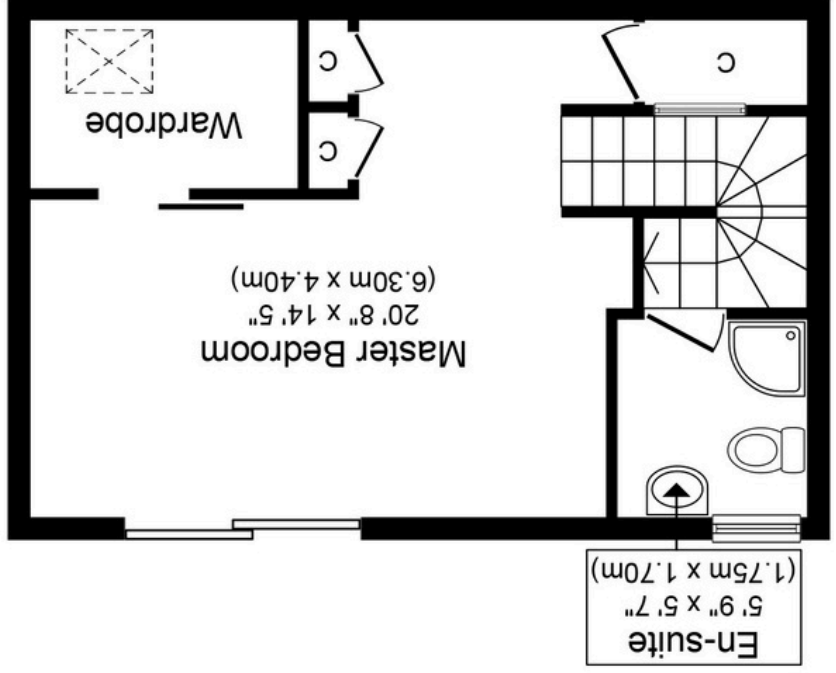

Second Floor
318 sq. ft.
Approximate Floor Area
(29.5 sq. m.)

Whilst every attempt has been made to ensure the accuracy of the floor plan contained here, measurements of doors, windows, rooms and any other items are approximate and no responsibility is taken for any error, omission, or mis-statement. The measurements should not be relied upon for valuation, transaction and/or funding purposes. This plan is for illustrative purposes only and should be used as such by any prospective purchaser or tenant. The services, systems and appliances shown have not been tested and no guarantee as to their operability or efficiency can be given.