



DM&Co.
— SALES & LETTINGS —

44 Delamere Road
Hall Green B28 0ER

A Superbly Presented Four Bedroom Modern Home Located Just Off The Stratford Road With A Fantastic Array Of Local Amenities. This Home Is Offered Unfurnished & Is Available End Of August!



DETAILS

This modern & contemporary home is offered on an unfurnished basis & available end of August.

This is a fantastic opportunity to rent a magnificent four bedroom family home.

At ground floor level there is a spacious hallway, main reception room, W.C. / cloakroom and a luxurious open plan kitchen / dining area having patio doors that open out onto the landscaped rear garden.

At first floor level there are three bedrooms and a family bathroom with separate shower. At second floor level there is a superb master suite having en-suite shower room.

Birmingham City Council - Tax Band D



OUTSIDE

To the front of the property there is a private driveway with sufficient parking for two or more cars.

To the rear there is a landscaped garden.

This property benefits from a single garage.

VIEWINGS

At short notice with DM & Co. Homes on 0121 775 0101 or by email lettings@dmandcohomes.co.uk



GENERAL INFORMATION

This property is based within walking distance to local amenities & fantastic public transport links.

Networks in your area - Virgin Media, Openreach

Mobile availability in your area - EE, Three, O2, Vodafone



OTHER SERVICES

DM & Co are pleased to offer the following services:-

Residential Lettings: If you are considering letting your property, please contact the office on 0121 775 0101.

Mortgage Services: If you would like advice on the best mortgages available, please contact us on 0121 775 0101.



Agents Note: Whilst every care has been taken to prepare these sales particulars, they are for guidance purposes only. All measurements are approximate and are for general guidance purposes only and whilst every care has been taken to ensure their accuracy, they should not be relied upon and potential buyers are advised to recheck the measurements.

FEATURES

- Four Bedroom Family Home
- Spacious Accommodation
- Master Bedroom with En Suite
- Private Driveway for Multiple Cars
- Open Plan Kitchen Diner
- Single Garage
- White Goods Included
- Holding Deposit - £369.00
- Security Deposit - £1846.15
- Available End Of August

SIZE

Total - 1303.40 sq ft

VIEWING

Book a viewing with Sole Agents DM & Co.
Premium by phone or email:

📞 0121 775 0101

@ lettings@dmandcohomes.co.uk

Agents Note: Whilst every care has been taken to prepare these sales particulars, they are for guidance purposes only. All measurements are approximate and are for general guidance purposes only and whilst every care has been taken to ensure their accuracy, they should not be relied upon and potential buyers are advised to recheck the measurements.

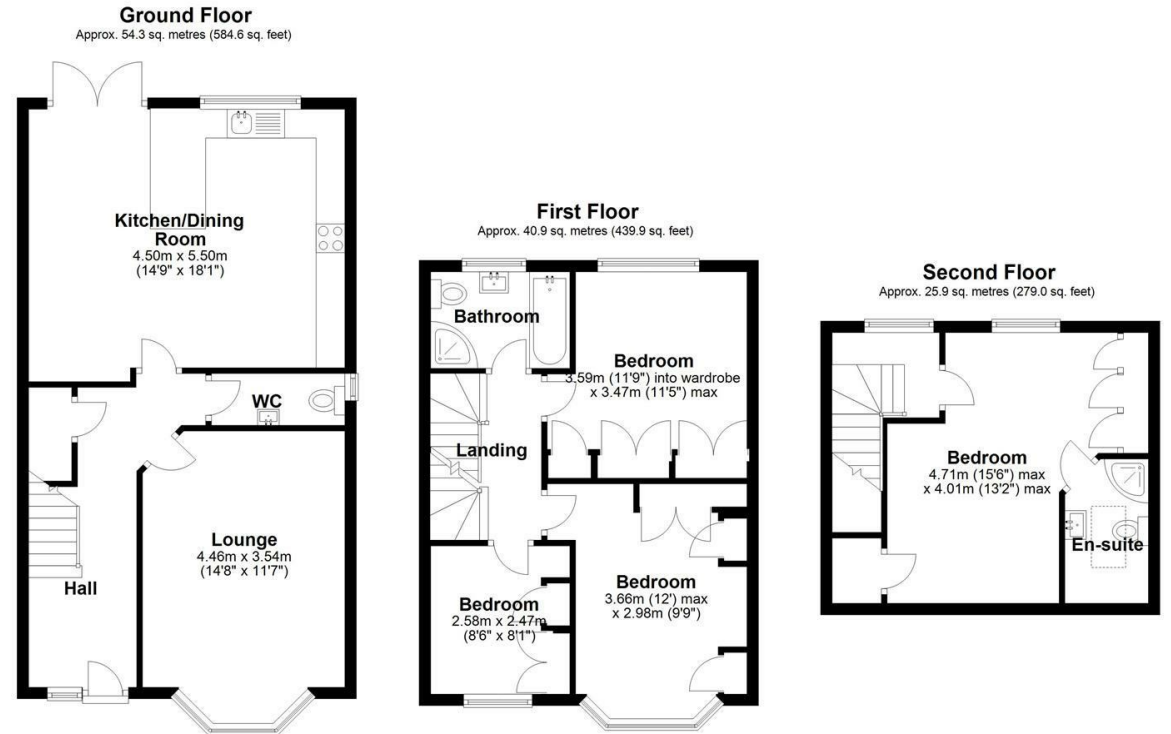

Total area: approx. 121.1 sq. metres (1303.4 sq. feet)

Please note this plan is for illustration purposes only, this is not intended to be a measured survey or comply with RICS guidelines. All measurements are for the actual floor area and are approximate so should be checked by prospective buyers/tenants. No responsibility is taken for any error, omission, or mis-statement.
Plan produced using PlanUp.

