

Need a Mortgage in principle to make offers? Call us now for quick assistance!
0121 775 0101



Do you need to sell? Start your journey now! Call us we can help.
0121 775 0101



SCAN FOR MORE INFO
SIZE - 593 Sq Ft
TENURE - Freehold
COUNCIL TAX - Solihull MBC - B
BROADBAND - Upload Max 1000 Mbps
 Download Max 220 Mbps
EPC - 75 - C
PARKING - 1 Allocated Space
FLOODRISK - Very Low
SERVICES - Mains
COVENANTS - N/A

SNITTERFIELD DRIVE

Offers Over £260,000

Welcome to this charming property located on Snitterfield Drive in the lovely area of Shirley, Solihull. This house offers a wonderful opportunity to create a warm and inviting home. Whether you're looking to start a new chapter or simply seeking a change of scenery, this property is sure to appeal to you.

FEATURES

- Mid Terraced Property
- No Upward Chain
- Fitted Kitchen
- Lounge/Dining Room with French Doors to Garden
- Guest Cloakroom
- Two Double Bedrooms with Fitted Wardrobes
- Family Bathroom
- Allocated Parking Space with Additional Communal Parking
- Low Maintenance Rear Garden
- Convenient Location
- £189.23 Per Annum Service Charge

Are you an investor interested in expanding your portfolio?

Call 0121 775 0101 to provide your investment criteria for alerts.



SCAN TO VIEW OUR WEEKLY FILMS & SUBSCRIBE

Sneak Peeks

Every week, we unveil "Sneak Peeks," a feature showcasing exclusive properties before they hit Rightmove and other platforms.

The Landlord Club

Join our Landlord Club for weekly updates on legislation, market trends, and our Letting Director's 'Investment Pick of the Week' for optimal ROI.

HTSPMD

Tune into 'How's The Solihull Property Market Dom' weekly for a quick, insightful snapshot of the market.

The Mortgage Update

Get weekly insights and the best deals with our Mortgage Update, your shortcut to navigating the complex mortgage landscape confidently.

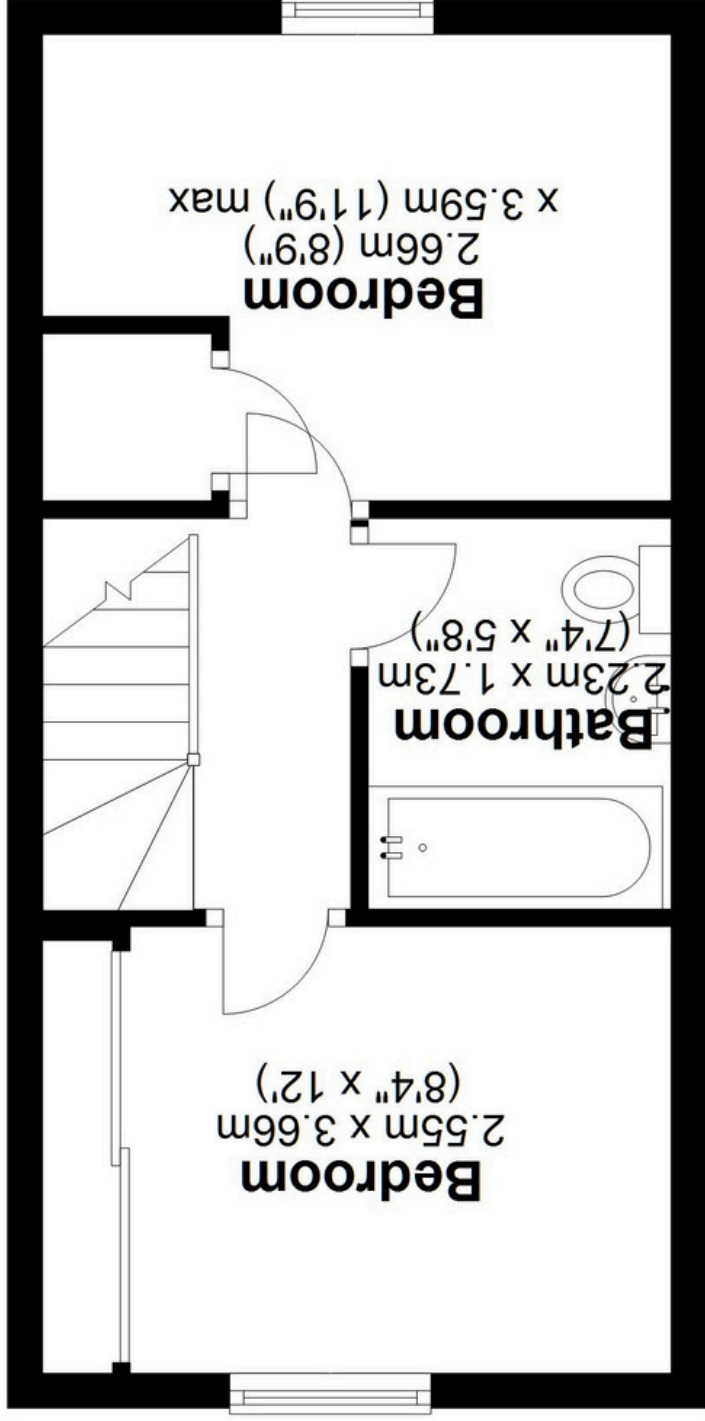

First Floor
 Approx. 27.6 sq. metres (297.3 sq. feet)

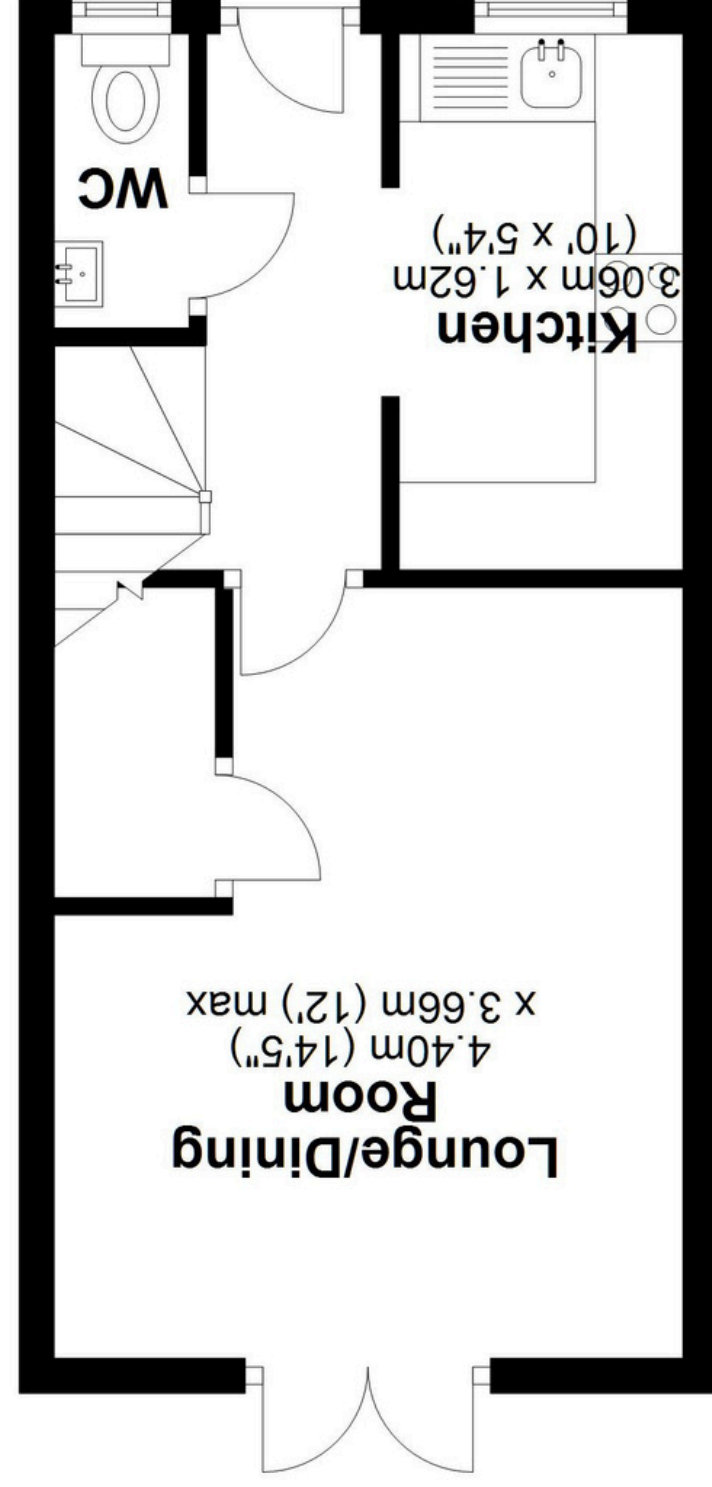

Ground Floor
 Approx. 27.5 sq. metres (296.2 sq. feet)



Total area: approx. 55.1 sq. metres (593.5 sq. feet)

This floor plan is for illustration purposes only, this is not intended to be a measured/scaled survey or comply with RICS guidelines. All measurements (including total floor area) openings, orientation and floor area are approximate. No details are guaranteed, they cannot be relied upon for any purpose and do not form part of any agreement. A party must rely upon its own inspection(s). No responsibility is taken for any error, omission, or mis-statement.
 Plan produced using PlanUp.