

Need a Mortgage in principle to make offers? Call us now for quick assistance!  
0121 775 0101



Do you need to sell? Start your journey now! Call us we can help.  
0121 775 0101



**SCAN FOR MORE INFO**  
**SIZE** - 1400 Sq Ft  
**TENURE** - Freehold  
**COUNCIL TAX** - Solihull MBC - D  
**BROADBAND** - Upload Max 1G000 Mbps  
 Download Max 1000 Mbps  
**EPC** - C - 76  
**PARKING** - For at least 2 Cars  
**FLOODRISK** - Very Low  
**SERVICES** - Mains  
**COVENANTS** - N/A  
**SERVICE CHARGE** - Half Yearly £163.78

Are you an investor interested in expanding your portfolio?

Call 0121 775 0101 to provide your investment criteria for alerts.

## MIDDLEWOOD CLOSE

Offers in the region of £375,000

Welcome to this charming property located in Middlewood Close, Solihull. This delightful end terrace house boasts a spacious 1,400 sq.ft of three storey living space, perfect for a family looking for a new home.

### FEATURES

- Beautifully Presented Three Storey Family Home
- Ground Floor Bedroom/Study/TV Room
- Living Room with Balcony
- Fitted Kitchen/Dining Room
- Utility Room
- Two Double Second Floor Bedrooms
- En-Suite Shower Room & Family Bathroom
- Landscaped Rear Garden
- Driveway Parking and Single Garage
- Convenient Location

### Sneak Peeks

Every week, we unveil "Sneak Peeks," a feature showcasing exclusive properties before they hit Rightmove and other platforms.

### The Landlord Club

Join our Landlord Club for weekly updates on legislation, market trends, and our Letting Director's 'Investment Pick of the Week' for optimal ROI.

### HTSPMD

Tune into 'How's The Solihull Property Market Dom' weekly for a quick, insightful snapshot of the market.

### The Mortgage Update

Get weekly insights and the best deals with our Mortgage Update, your shortcut to navigating the complex mortgage landscape confidently.



SCAN TO VIEW OUR WEEKLY FILMS & SUBSCRIBE

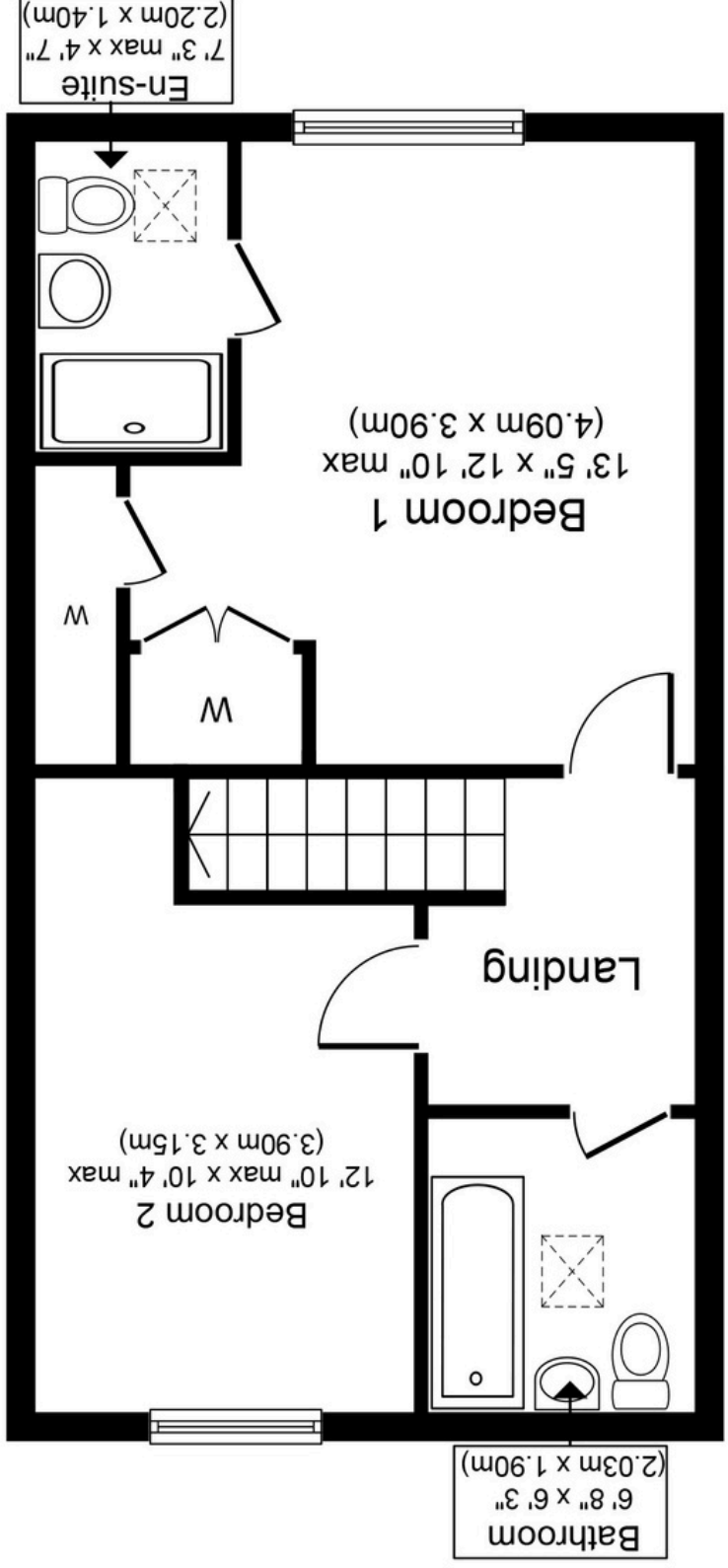
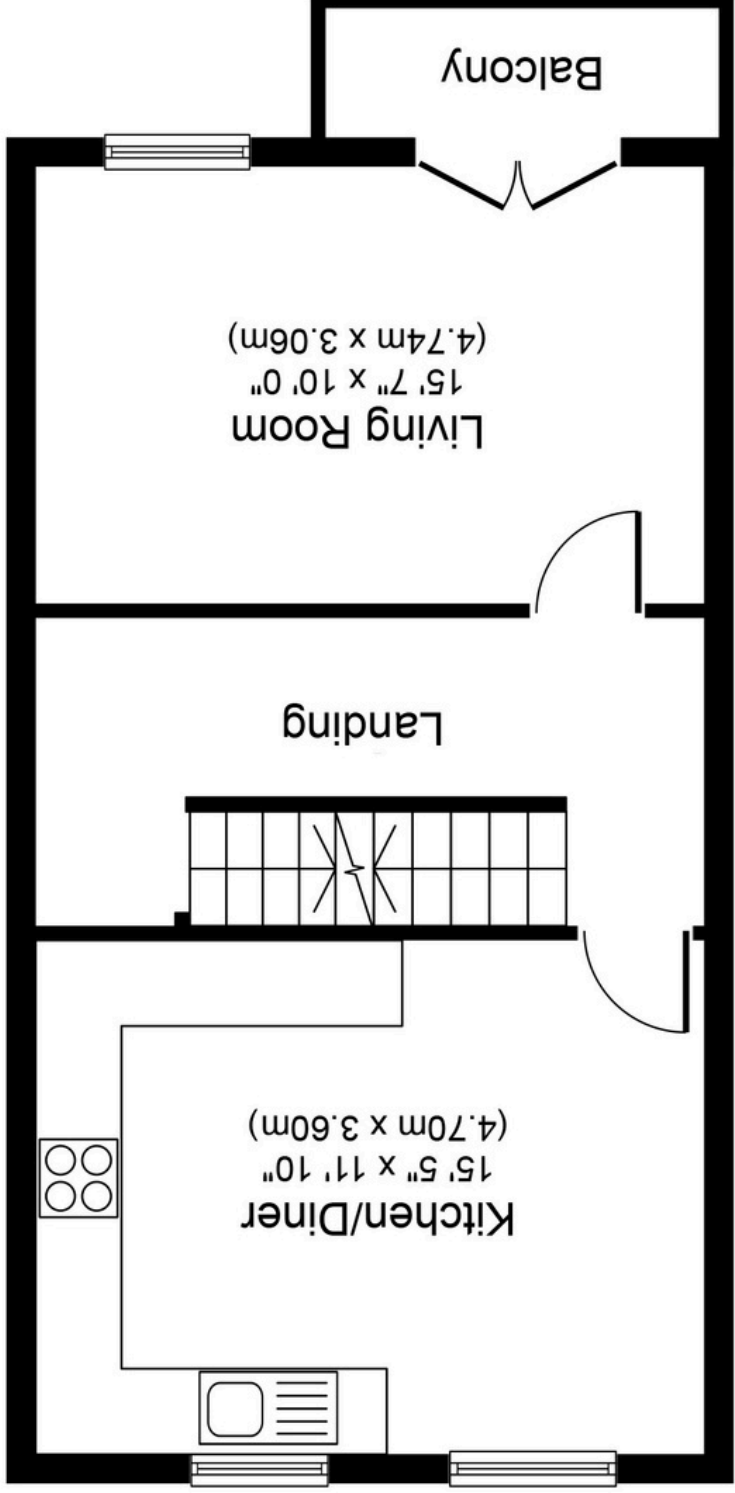
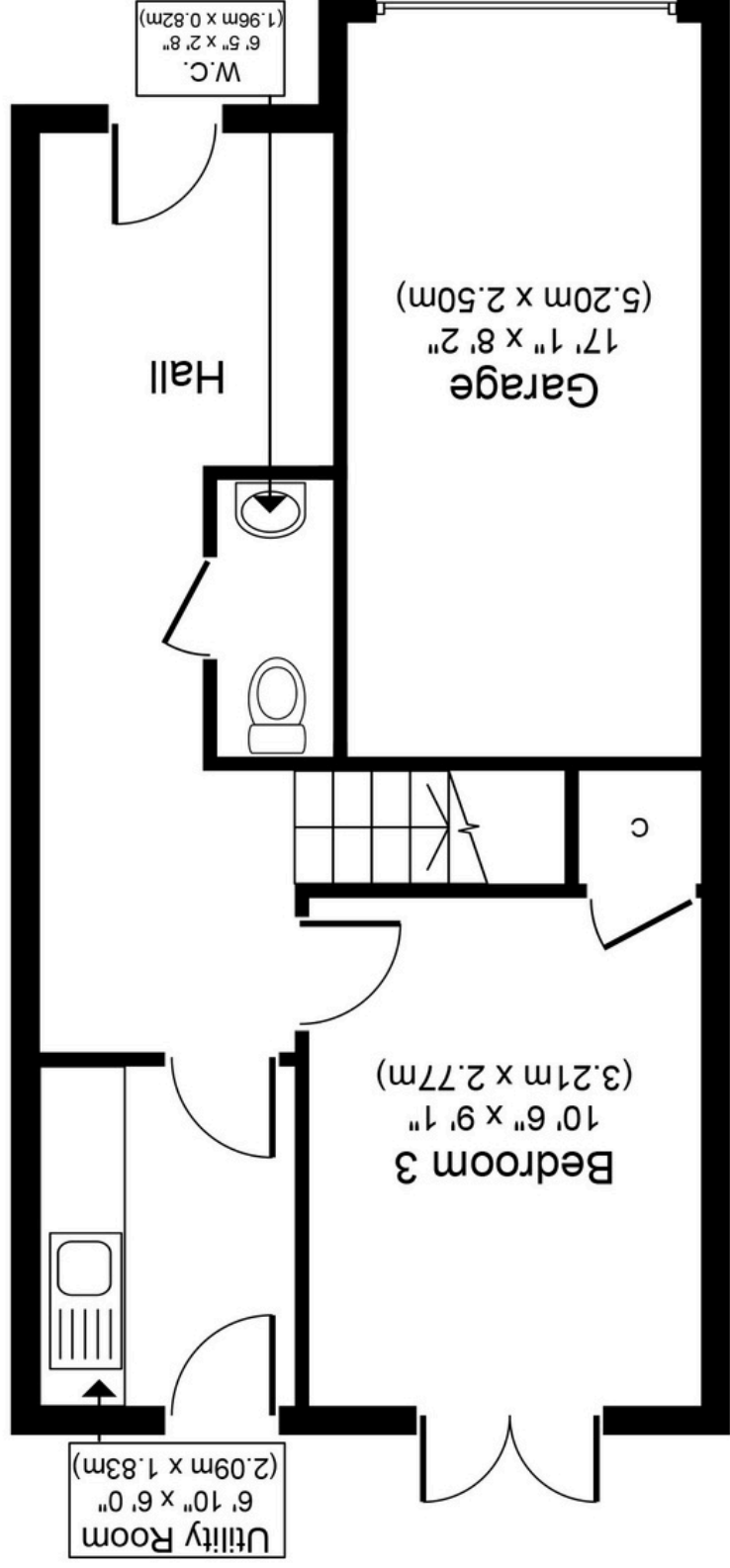

Whilst every attempt has been made to ensure the accuracy of the floor plan contained here, measurements of doors, windows, rooms and any other items are approximate and no responsibility is taken for any error, omission, or mis-statement. The measurements should not be relied upon for valuation, transaction and/or funding purposes. This plan is for illustrative purposes only and should be used as such by any prospective purchaser or tenant. The services, systems and appliances shown have not been tested and no guarantee as to their operability or efficiency can be given.

Copyright V360 Ltd 2024 | www.houseviz.com