

Need a Mortgage in principle to make offers? Call us now for quick assistance!
0121 775 0101



Do you need to sell? Start your journey now! Call us we can help.
0121 775 0101



SCAN FOR MORE INFO
SIZE - 602 Sq Ft
TENURE - Leasehold
SERVICE CHARGE - £2,796 Per Annum
COUNCIL TAX - Solihull MBC - D
BROADBAND - Upload Max 1GBps
Download Max 1GBps
MOBILE - EE Three O2 Vodafone
EPC - D - 67
PARKING - Ample Residents & Visitors Spaces
FLOODRISK - Very Low
SERVICES - Mains
COVENANTS - N/A

Are you an investor interested in expanding your portfolio?

Call 0121 775 0101 to provide your investment criteria for alerts.

FERNLEIGH COURT

Offers Over £140,000

Experience the ease and comfort of this delightful two bedroom apartment, tailored for over 55's. Nestled in a serene development close to Solihull Town Centre, it combines convenience with a peaceful living environment. Offered with no upward chain.

FEATURES

- Over 55's Independent Living
- Close Proximity to Solihull Town Centre
- Two Bedrooms
- Spacious Lounge
- Well Equipped Kitchen
- Tranquil Communal Grounds
- Ample Parking for Residents and Visitors
- All White Goods, Carpets and Curtains Included in the Sale
- NO UPWARD CHAIN

Sneak Peeks

Every week, we unveil "Sneak Peeks," a feature showcasing exclusive properties before they hit Rightmove and other platforms.

The Landlord Club

Join our Landlord Club for weekly updates on legislation, market trends, and our Letting Director's 'Investment Pick of the Week' for optimal ROI.

HTSPMD

Tune into 'How's The Solihull Property Market Dom' weekly for a quick, insightful snapshot of the market.

The Mortgage Update

Get weekly insights and the best deals with our Mortgage Update, your shortcut to navigating the complex mortgage landscape confidently.



SCAN TO VIEW OUR WEEKLY FILMS & SUBSCRIBE

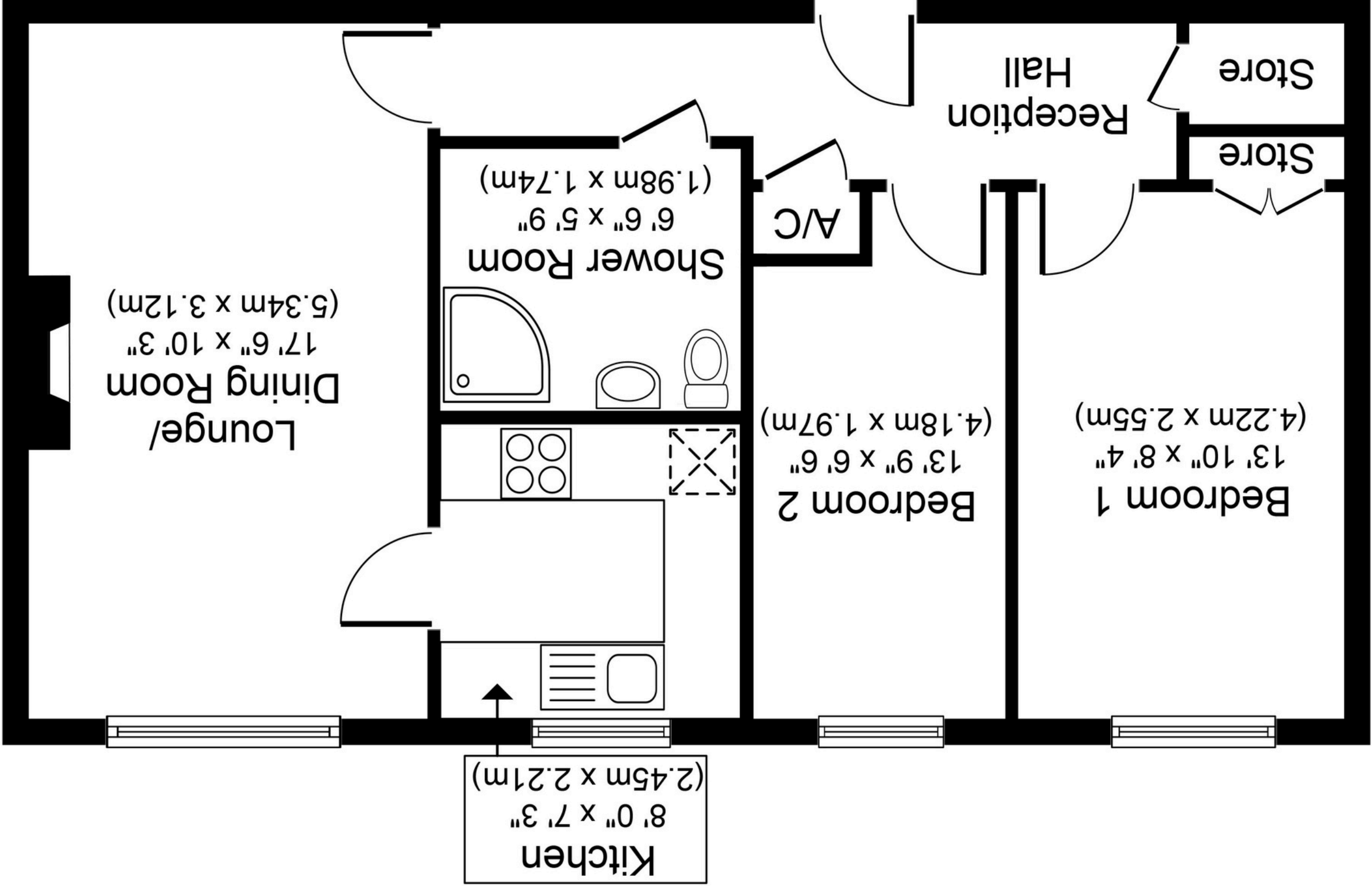

Ground Floor
Approximate Floor Area
602 sq. ft.
(56.0 sq. m.)

Whilst every attempt has been made to ensure the accuracy of the floor plan contained here, measurements of doors, windows, rooms and any other items are approximate and no responsibility is taken for any error, omission, or mis-statement. The measurements should not be relied upon for valuation, transaction and/or funding purposes. This plan is for illustrative purposes only and should be used as such by any prospective purchaser or tenant. The services, systems and appliances shown have not been tested and no guarantee as to their operability or efficiency can be given.
 Copyright V360 Ltd 2023 | www.houseviz.com