

The Deansgate

3 bedroom home.

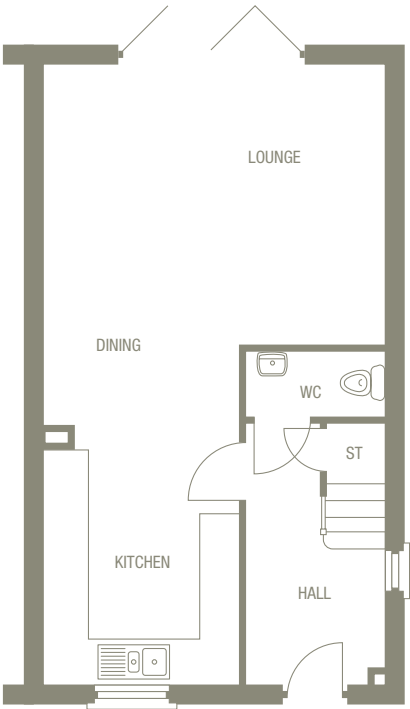

Welcome to The Deansgate, a strikingly modern home with an impressive interior designed for easy entertaining and relaxing home life. The hallway leads into an open plan kitchen/dining/living area with bi-fold doors opening into the garden. The first floor features 3 well-planned bedrooms plus a family bathroom and a stylish ensuite shower room serves the master bedroom.



Ground Floor

Room	Size	
Lounge	4850* x 3960mm	15'11"* x 13'0"
Kitchen/Dining	2800 x 4840mm	9'2" x 15'10"
WC/Cloaks	1965 x 950mm	6'5" x 3'1"

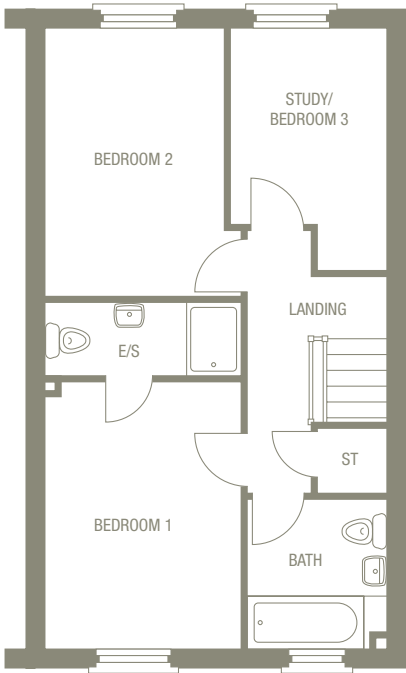

First Floor

Room	Size	
Bedroom 1	2760 x 3805*mm	9'1" x 12'6"*
En-suite	2760 x 1030mm	9'1" x 3'5"
Bedroom 2	2760* x 3790mm	9'1"* x 12'5"
Study/Bedroom 3	2210* x 3400*mm	7'3"* x 11'2"*
Bathroom	2000 x 2100mm	6'7" x 6'11"

934 total sq ft

*Denotes maximum room dimensions. This is a computer generated image of The Deansgate, elevation treatment may vary. All internal images are indicative of a Morris house type. Room sizes are approximate. Plots may be handed and any garages may be single or double. Kitchen and bathroom layouts are indicative. These plans are correct at time of going to press, but may be subject to change during construction. Please ensure that you check for specific plot details.

