



**GASCOIGNE
HALMAN**

3 ANVIL CLOSE, ELTON, CHESTER

THE AREAS LEADING ESTATE AGENT



3 ANVIL CLOSE, ELTON, CHESTER

£240,000

A stylish, smart and spacious three storey end townhouse set in a small, exclusive cul-de-sac within the village conservation area of Elton.

The property offers well designed accommodation arranged over three floors. It offers plenty of space and flexibility on the ground floor for families to socialise and entertain whilst on the upper floors are four excellent sized bedrooms and two bathrooms.

There is an entrance hallway with cloakroom/WC. The kitchen/dining room is fitted with modern cabinets oak worktops. The living room is extended and creates a generous room with doors opening to the courtyard garden.





DESCRIPTION

The first floor provides two double bedrooms, a single bedroom and a family bathroom. The entire second floor is occupied by the large main bedroom. This room has built in wardrobes and an en-suite bathroom. The property has double glazed windows and a gas fired heating/hot water system is installed. There is a block paved driveway and brick built single garage to the rear plus a private, walled rear courtyard garden.

LOCATION

The property forms part of a small residential development built in 2002/2003. Despite this being a relatively modern house, the Conservation Area setting and style of the buildings gives the area a character feel. There is a parade of shops nearby catering for many day to day needs plus a primary school and village pub. Helsby and Frodsham are both within easy reach offering a wide range of services plus the well regarded Helsby High School. The road, rail and motorway networks allow access to many parts of the North West with Chester, Liverpool, Warrington and Manchester all within daily travelling distance.

TENURE

Freehold.

COUNCIL TAX

Band D. Cheshire West & Chester.

EPC RATING

Current C.

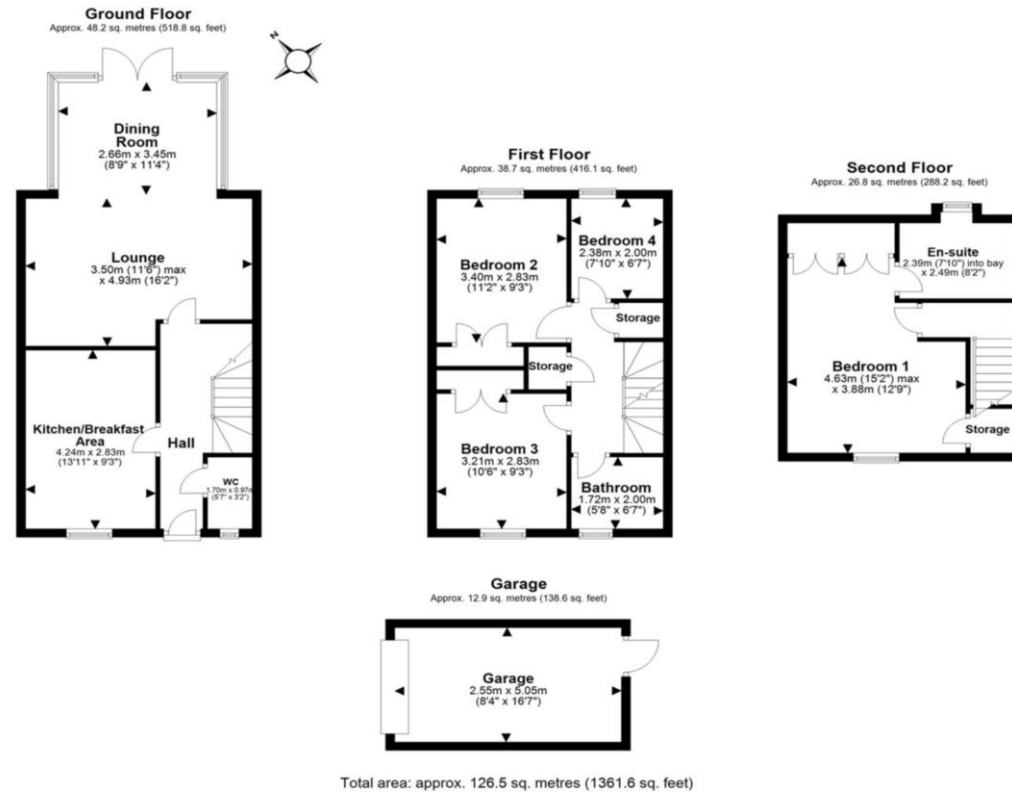

NOTICE Gascoigne Halman for themselves and for the vendors or lessors of this property whose agents they are give notice that: (i) the particulars are set out as a general outline only for the guidance of intending purchasers or lessees, and do not constitute, nor constitute part of, an offer or contract; (ii) all descriptions, dimensions, references to condition and necessary permissions for use and occupation, and other details are given in good faith and are believed to be correct but any intending purchasers or tenants should not rely on them as statements or representations of fact but must satisfy themselves by inspection or otherwise as to the correctness of each of them; (iii) no person in the employment of Gascoigne Halman has any authority to make or give any representation or warranty whatever in relation to this property.

FRODSHAM OFFICE

01928 739777

frodsham@gascoignehalman.co.uk

Pollard Buildings, Church Street, Frodsham, WA6 7DW

**GASCOIGNE
HALMAN**