



**GASCOIGNE  
HALMAN**

6 ACACIA CLOSE, ELTON, CHESTER

---

THE AREAS LEADING ESTATE AGENT





## 6 ACACIA CLOSE, ELTON, CHESTER

**£295,000**

**A really impressive 1150 sq ft three/four bedroom detached family home with spacious, adaptable accommodation, a superb modern finish and stunning South facing landscaped rear garden.**

This lovely home offers a practical and adaptable layout with a modern open plan feel. The accommodation is presented in first class order throughout and will appeal to families and downsizers alike.

To the ground floor, there is a good sized lounge opening to a large dining room. This open to a spacious conservatory with insulated roof making it ideal for all year round use. The kitchen has a stylish modern design and is complimented by a utility room and cloakroom/WC. The former garage is converted and is ideal for use as a home office or fourth double bedroom.







The first floor offers three excellent double bedrooms and two smart bathroom, one being en-suite.

The external space continues to impress with the private rear garden enjoying a South facing aspect and being recently landscaped with smart paving, lawn and a useful garden store.

## LOCATION

The property forms part of a small residential cul-de-sac of detached homes built by a well regarded builder in 1997. This house enjoys a prime position at the head of the cul-de-sac. There is a parade of local shops in Elton catering for many day to day needs plus a popular primary school and village pub. Helsby and Frodsham are both within easy reach offering a wide range of services plus the well regarded Helsby High School. The road, rail and motorway networks allow access to many parts of the North West with Chester, Liverpool, Warrington and Manchester all within daily travelling distance.

## TENURE

Freehold.

## COUNCIL TAX

Band C. Cheshire West & Chester.

## EPC RATING

Current C

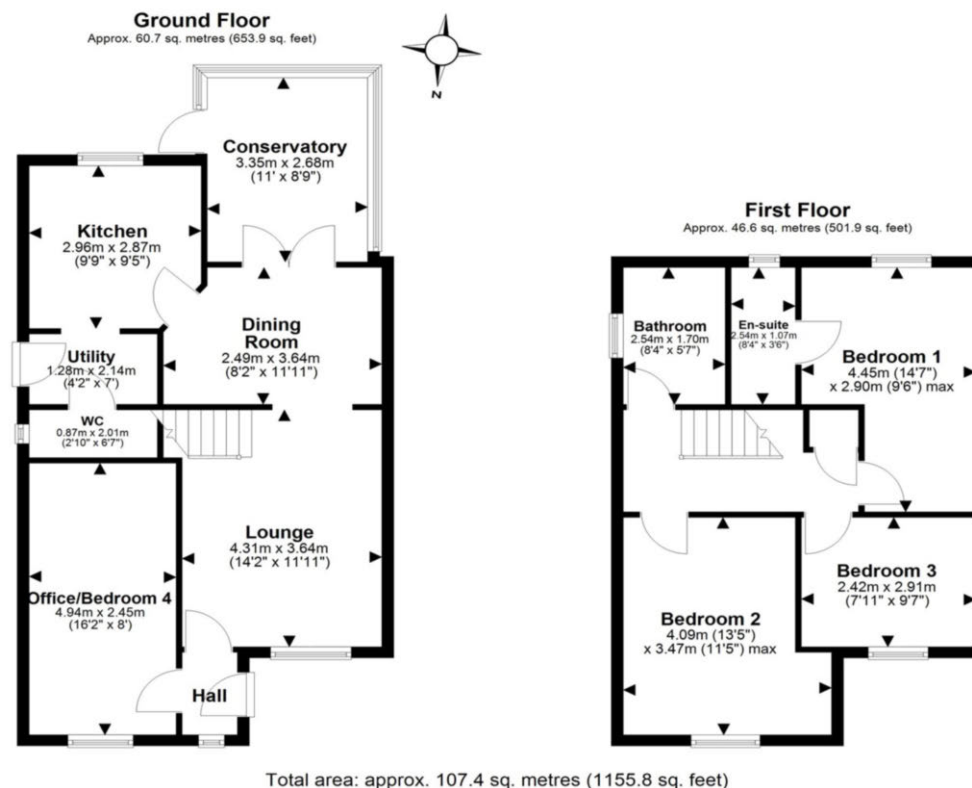

NOTICE Gascoigne Halman for themselves and for the vendors or lessors of this property whose agents they are give notice that: (i) the particulars are set out as a general outline only for the guidance of intending purchasers or lessees, and do not constitute, nor constitute part of, an offer or contract; (ii) all descriptions, dimensions, references to condition and necessary permissions for use and occupation, and other details are given in good faith and are believed to be correct but any intending purchasers or tenants should not rely on them as statements or representations of fact but must satisfy themselves by inspection or otherwise as to the correctness of each of them; (iii) no person in the employment of Gascoigne Halman has any authority to make or give any representation or warranty whatever in relation to this property.

## FRODSHAM OFFICE

01928 739777

frodsham@gascoignehalman.co.uk

Pollard Building, Church Street, Frodsham, WA6 7DW

**GASCOIGNE  
HALMAN**