



**GASCOIGNE  
HALMAN**

19 MERE VIEW, HELSBY, FRODSHAM

---

THE AREAS LEADING ESTATE AGENT





## 19 MERE VIEW, HELSBY, FRODSHAM

**£130,000**

**A second floor apartment with modern, bright, easy to manage and economical to run accommodation enjoying views to Helsby Hill.**

This top floor apartment would be ideal for first time buyers or downsizers seeking an easy to manage home in a convenient, well connected area, close to local amenities and excellent transport links.





The property was built in 2006 as part of the popular Meres Edge development and occupies a position at the rear of the development. It is on the top floor of the building with light and bright accommodation and far reaching views to Helsby Hill and beyond. The property also benefits from access to a spacious loft storage area.

The layout includes an entrance hallway with entry intercom system, living room, fitted kitchen, two bedrooms and a bathroom. Gas central heating is installed and double glazing fitted throughout. There is allocated parking and ample visitor spaces.

### LOCATION

The property forms part of a popular development in Helsby and is well placed within walking distance of local services and shops including a Tesco supermarket. Helsby lies close to open countryside whilst also being convenient for access to many other parts of the North West via the road, rail and motorway networks. Public transport services run nearby and trains from Helsby connect to Chester, Warrington, Liverpool and Manchester.

### TENURE & SERVICE CHARGE

The property is leasehold for the residue of an initial 120 year term from 2005. No ground rent is payable but this will be verified by solicitors. A service charge of £1098 per year is payable. This cover maintenance of the communal areas and grounds, external building maintenance and a contribution to a reserve fund.

### COUNCIL TAX

Band A. Cheshire West & Chester.

### Top Floor Apartment

Approx. 46.9 sq. metres (505.3 sq. feet)

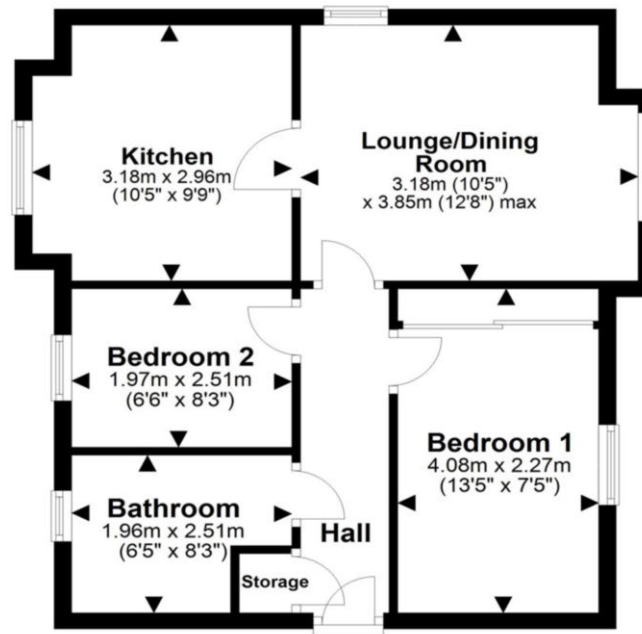

Total area: approx. 46.9 sq. metres (505.3 sq. feet)

NOTICE Gascoigne Halman for themselves and for the vendors or lessors of this property whose agents they are give notice that: (i) the particulars are set out as a general outline only for the guidance of intending purchasers or lessees, and do not constitute, nor constitute part of, an offer or contract; (ii) all descriptions, dimensions, references to condition and necessary permissions for use and occupation, and other details are given in good faith and are believed to be correct but any intending purchasers or tenants should not rely on them as statements or representations of fact but must satisfy themselves by inspection or otherwise as to the correctness of each of them; (iii) no person in the employment of Gascoigne Halman has any authority to make or give any representation or warranty whatever in relation to this property.

#### FRODSHAM OFFICE

01928 739777

frodsham@gscoignehalman.co.uk

Pollard Building, Church Street, Frodsham, WA6 7DW

**GASCOIGNE  
HALMAN**