



**GASCOIGNE
HALMAN**

WEAVER ROAD, FRODSHAM

THE AREAS LEADING ESTATE AGENT



WEAVER ROAD, FRODSHAM

Offers Over £250,000

Offered for sale for the first time since being built in 1971, this treasured semi-detached family home is set at the end of a popular cul-de-sac, overlooking a small green and enjoying far reaching views to the rear.

The property has a feeling of space and light with large windows allowing in plenty of natural lighting. The interior offers scope for updating and enhancement but could be lived in and enjoyed immediately and worked on over time.





The living room is of generous proportions and runs front to back. The kitchen has a range of modern cabinets and leads to a useful rear porch/utility area. The three bedrooms will all accommodate a double bed and the bathroom is also a good size. Double glazed windows are fitted and gas central heating installed.

There is a front garden area and driveway leading to a single garage with newly fitted remote controlled door. The rear garden is enclosed and has lawn and flower borders.

LOCATION

The house is within a well established area of Frodsham, convenient for access to local facilities, shops and schools. The location is also well placed for access to open countryside with walking along the banks of the River Weaver nearby. There are popular schools for all age groups in the area and the house lies within the catchment for Helsby High School. The road, rail and motorway networks allow access for the commuter to many parts of the North West.

TENURE

Freehold.

COUNCIL TAX

Band C. Cheshire West & Chester.

EPC RATING

Awaited.

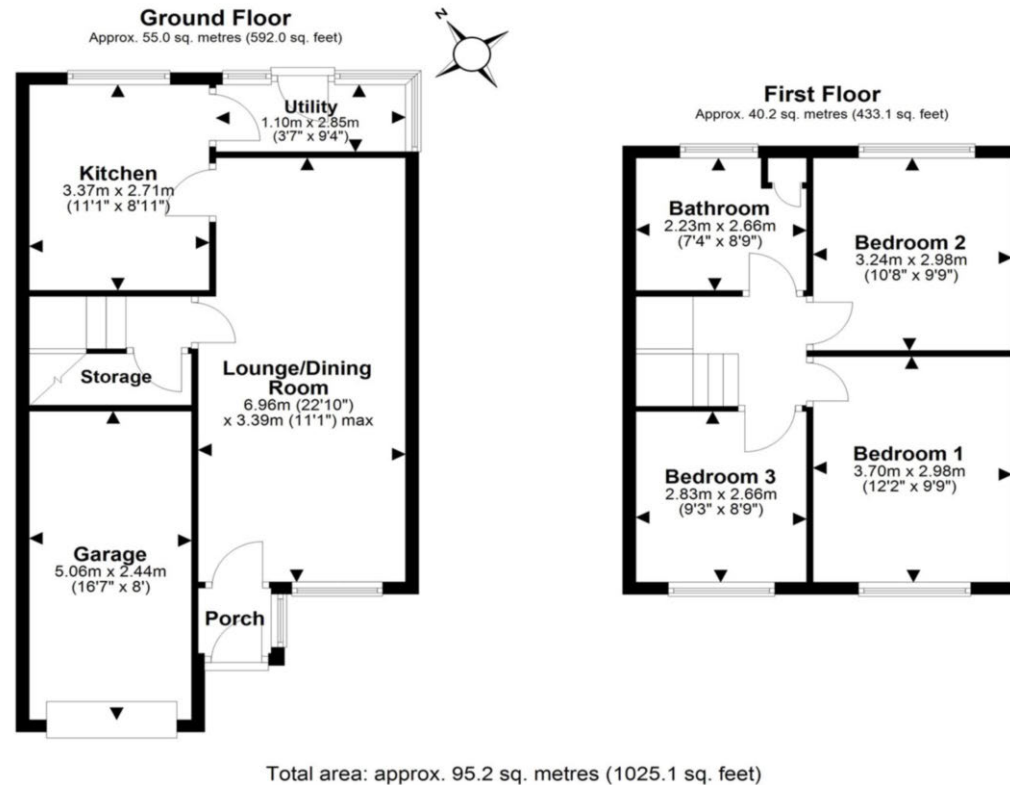

NOTICE Gascoigne Halman for themselves and for the vendors or lessors of this property whose agents they are give notice that: (i) the particulars are set out as a general outline only for the guidance of intending purchasers or lessees, and do not constitute, nor constitute part of, an offer or contract; (ii) all descriptions, dimensions, references to condition and necessary permissions for use and occupation, and other details are given in good faith and are believed to be correct but any intending purchasers or tenants should not rely on them as statements or representations of fact but must satisfy themselves by inspection or otherwise as to the correctness of each of them; (iii) no person in the employment of Gascoigne Halman has any authority to make or give any representation or warranty whatever in relation to this property.

FRODSHAM OFFICE

01928 739777

frodsham@gascoignehalman.co.uk

Pollard Building, Church Street, Frodsham, WA6 7DW

**GASCOIGNE
HALMAN**