



**GASCOIGNE
HALMAN**

FLAT 2, GREENFIELDS LODGE, FERMA LANE, GREAT
BARROW, CHESTER

THE AREAS LEADING ESTATE AGENT



FLAT 2, GREENFIELDS LODGE, FERMA LANE, GREAT BARROW, CHESTER

£175,000

For those aged 55 and over, a luxuriously appointed, ground floor apartment with far reaching rural views set in the grounds of a Victorian residence on the edge of a popular Cheshire village.

Greenfields Lodge is an exclusive collection of just 16 apartments arranged in a courtyard, with landscaped communal gardens and ample vehicle parking for residents and visitors.





The property has been refurbished throughout in recent years and offers a light, bright interior. There is a large living room, superb luxury kitchen with integrated quality appliances, two double bedrooms and a sumptuous bathroom. There are modern electric heaters and double glazed windows.

LOCATION

The property is situated within the grounds of a large Victorian mansion that has itself been converted into luxury apartments. It is off a quiet country lane on the edge of Great Barrow, with countryside walks on the doorstep and a local pub around the corner.

This is a peaceful retreat with a strong sense of community yet convenient for access to Chester and all it has to offer.

TENURE AND SERVICE CHARGE

The property is leasehold for the residue of an initial 125 year terms from June 1999. Ground rent of £50 per year is payable (24/25). A service charge of £2184 per year is payable (24/25). This covers external building and garden maintenance and building insurance.

COUNCIL TAX

Band B. Cheshire West & Chester.

EPC RATING

Current C

First Floor Apartment
Approx. 53.3 sq. metres (574.2 sq. feet)

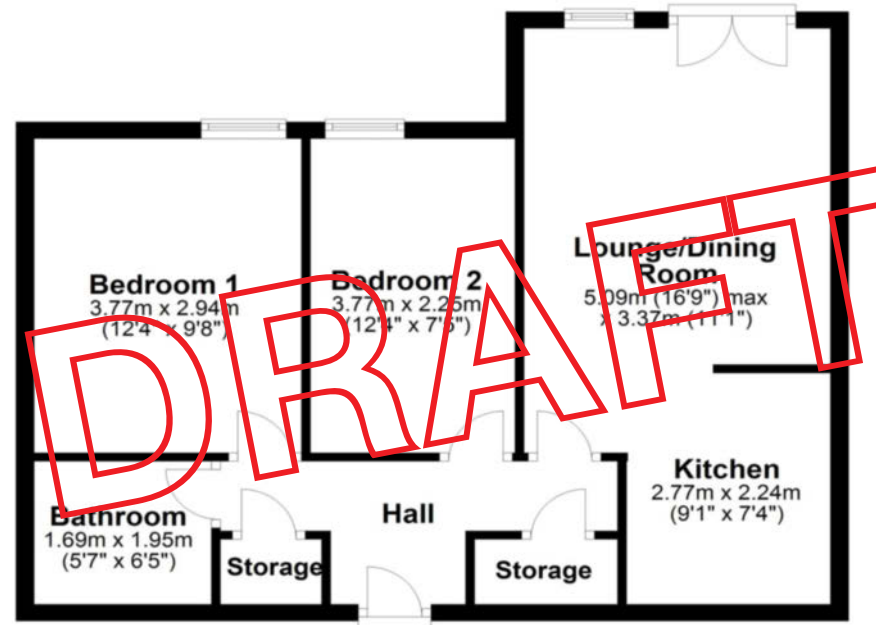

Total area: approx. 53.3 sq. metres (574.2 sq. feet)

NOTICE Gascoigne Halman for themselves and for the vendors or lessors of this property whose agents they are give notice that: (i) the particulars are set out as a general outline only for the guidance of intending purchasers or lessees, and do not constitute, nor constitute part of, an offer or contract; (ii) all descriptions, dimensions, references to condition and necessary permissions for use and occupation, and other details are given in good faith and are believed to be correct but any intending purchasers or tenants should not rely on them as statements or representations of fact but must satisfy themselves by inspection or otherwise as to the correctness of each of them; (iii) no person in the employment of Gascoigne Halman has any authority to make or give any representation or warranty whatever in relation to this property.

FRODSHAM OFFICE

01928 739777

frodsham@gascoignehalman.co.uk

Pollard Building, Church Street, Frodsham, WA6 7DW

**GASCOIGNE
HALMAN**