



**GASCOIGNE  
HALMAN**

RANULPH COURT, FRODSHAM

---

THE AREAS LEADING ESTATE AGENT



## RANULPH COURT, FRODSHAM

**Offers in the region of £435,000**

**Tucked away in a small, select cul-de-sac, an attractive, well designed detached house offering spacious accommodation and a lovely private rear garden.**

The house enjoys a secluded setting, part of an exclusive cul-de-sac of just eight detached homes built in 1995. Although similar, each of the houses is built in a slightly different style and with materials that compliment the mature surroundings.

The property is being offered for sale with no onward chain. It is well presented and ready for new owners to move straight and enjoy from day one but it also offers scope for further updating and improvement.





The layout is excellent, extending to over 1440 sq ft (134 sq m) with plenty of internal space and flexibility. The ground floor includes an entrance hallway with cloakroom/WC, a good sized lounge, large conservatory, dining room and fitted kitchen.

On the first floor are four well proportioned bedrooms and two bathrooms, one being en-suite. Three of the bedrooms also have built in wardrobes. There are double glazed windows throughout and a gas fired central heating system is installed.

A wide block paved driveway provides ample parking and leads to an integral single garage. The house is framed by private, mature gardens with lawns and well stocked, established borders. The rear garden is completely private, enveloped by the gardens of adjacent homes and an orchard.

#### **LOCATION**

The location is hard to beat for both privacy and convenience. Ranulph Court is a small, select cul-de-sac of just eight similar detached family homes. It is perfect for families and couples alike being approximately 1 mile from the centre of Frodsham, with a range of local facilities and popular schools within walking distance. Open countryside is also nearby with some excellent walking almost on the doorstep. The road, rail and motorway networks allow access to many parts of the North West. Regular, direct rail services run from Frodsham to Chester, Warrington, Liverpool and Manchester.

#### **TENURE**

Freehold.

#### **COUNCIL TAX**

Band F. Cheshire West & Chester.

#### **EPC RATING**

Current C

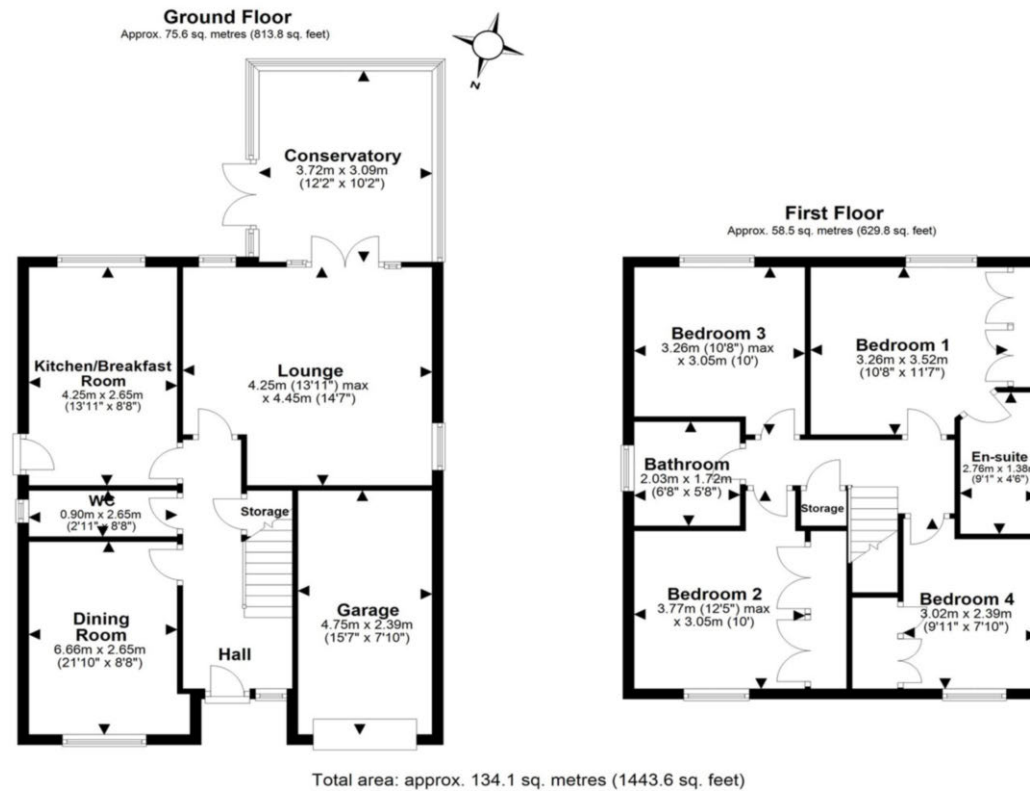

NOTICE Gascoigne Halman for themselves and for the vendors or lessors of this property whose agents they are give notice that: (i) the particulars are set out as a general outline only for the guidance of intending purchasers or lessees, and do not constitute, nor constitute part of, an offer or contract; (ii) all descriptions, dimensions, references to condition and necessary permissions for use and occupation, and other details are given in good faith and are believed to be correct but any intending purchasers or tenants should not rely on them as statements or representations of fact but must satisfy themselves by inspection or otherwise as to the correctness of each of them; (iii) no person in the employment of Gascoigne Halman has any authority to make or give any representation or warranty whatever in relation to this property.

**FRODSHAM OFFICE**

01928 739777

frodsham@gascoignehalman.co.uk

Pollards Building, Church Street, Frodsham, WA6 7DW

**GASCOIGNE  
HALMAN**