



**GASCOIGNE
HALMAN**

MERE RISE, ARBOUR WALK, HELSBY

THE AREAS LEADING ESTATE AGENT



| A STYLISH TOP FLOOR APARTMENT WITH
LOVELY BALCONY VIEWS

MERE RISE, ARBOUR WALK, HELSBY

£135,000

A stylish and spacious top floor (second floor) apartment within South facing balcony views set within a smart, popular development in a convenient area of Helsby.

Offered at a competitive asking price and with no onward chain, the sale of this spacious apartment is a great opportunity for first time buyers and downsizers alike.

The accommodation is well designed, enjoys excellent natural lighting and open views from the sunny balcony. The open plan living room/kitchen is a great size and is fitted with modern kitchen units and will be sold with appliances included.





There are two large double bedrooms, an en-suite shower room and separate bathroom. There are double glazed windows and gas fired central heating is installed.

Allocated parking is situated just outside the main entrance door and there are visitor spaces available together with communal garden areas and bin storage.

LEASE AND SERVICE CHARGE

The lease started in 2007 and has a remaining term of 108 years. A variable ground rent is payable, currently £300 per year.

A service charge of £1150 per year is currently payable to cover building insurance, maintenance of the exterior of the building, the communal areas and garden.

LOCATION

The property forms part of the popular Mere's Edge development in Helsby and is well placed for access to a range of local services and shops including a Tesco supermarket. Helsby lies close to open countryside whilst also being convenient for access to many other parts of the North West via the road, rail and motorway networks.

COUNCIL TAX

Band B. Cheshire West & Chester

EPC RATING

Current B.

GROUND FLOOR
747 sq.ft. (69.4 sq.m.) approx.

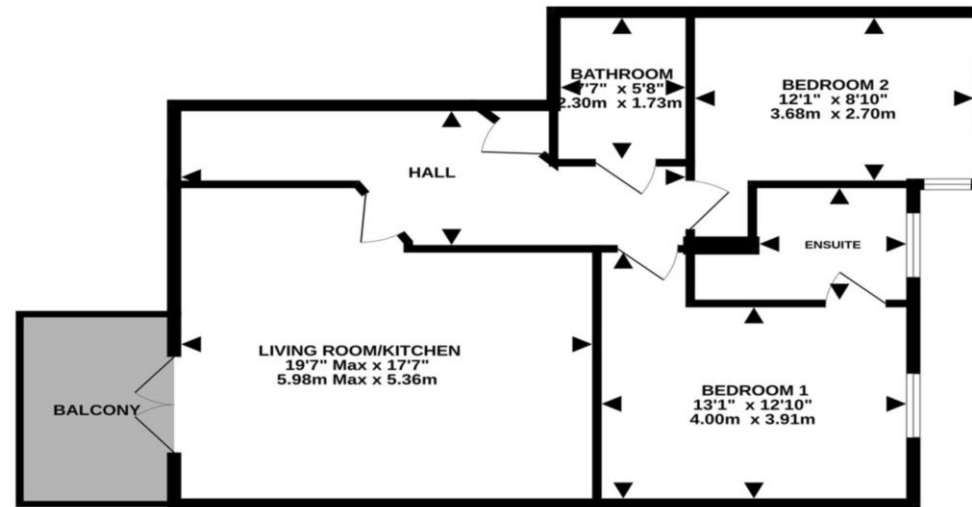

TOTAL FLOOR AREA: 747 sq.ft. (69.4 sq.m.) approx.
Whilst every attempt has been made to ensure the accuracy of the floorplan contained herein, measurements of doors, windows, rooms and any other items are approximate and no responsibility is taken for any error, omission or mis-statement. This plan is for illustrative purposes only and should be used as such by any prospective purchaser. The services, systems and appliances shown have not been tested and no guarantee as to their operability or efficiency can be given.
Made with Metropix ©2024

NOTICE Gascoigne Halman for themselves and for the vendors or lessors of this property whose agents they are give notice that: (i) the particulars are set out as a general outline only for the guidance of intending purchasers or lessees, and do not constitute, nor constitute part of, an offer or contract; (ii) all descriptions, dimensions, references to condition and necessary permissions for use and occupation, and other details are given in good faith and are believed to be correct but any intending purchasers or tenants should not rely on them as statements or representations of fact but must satisfy themselves by inspection or otherwise as to the correctness of each of them; (iii) no person in the employment of Gascoigne Halman has any authority to make or give any representation or warranty whatever in relation to this property.

FRODSHAM OFFICE

01928 739777

frodsham@gascoignehalman.co.uk

Pollard Building, Church Street, Frodsham, WA6 7DW

**GASCOIGNE
HALMAN**