



**GASCOIGNE
HALMAN**

LYNWOOD COTTAGE, FINGERPOST LANE, NORLEY,
FRODSHAM

THE AREAS LEADING ESTATE AGENT



LYNWOOD COTTAGE, FINGERPOST LANE, NORLEY, FRODSHAM

£325,000

A semi-detached house in a sought after rural village setting that is packed with potential for updating, improvement and possible extension.

Properties with potential at this price level are a rare find in Norley. This semi-detached cottage is in need of complete modernisation but also offers exciting potential for the new owners to improve, alter and potentially extend to create their own rural retreat.





The accommodation includes a spacious open plan lounge/dining room, kitchen and conservatory. The bathroom is currently on the ground floor. Upstairs are two double bedrooms. There is driveway parking a good sized rear garden with open views beyond.

LOCATION

The property is situated on the edge of Norley village with far reaching rural views to the rear and front. The area is surrounded by open Cheshire countryside with some lovely walks available on the doorstep including Delamere Forest. In contrast, both the A49 and A556 can be easily accessed and lead to the motorway networks from where many major commercial centres can be reached throughout the North West. Norley has a popular primary school, public house, village store and village hall with play area and bowling green.

TENURE

Freehold.

COUNCIL TAX

Band E. Cheshire West & Chester.

EPC RATING

Current F.

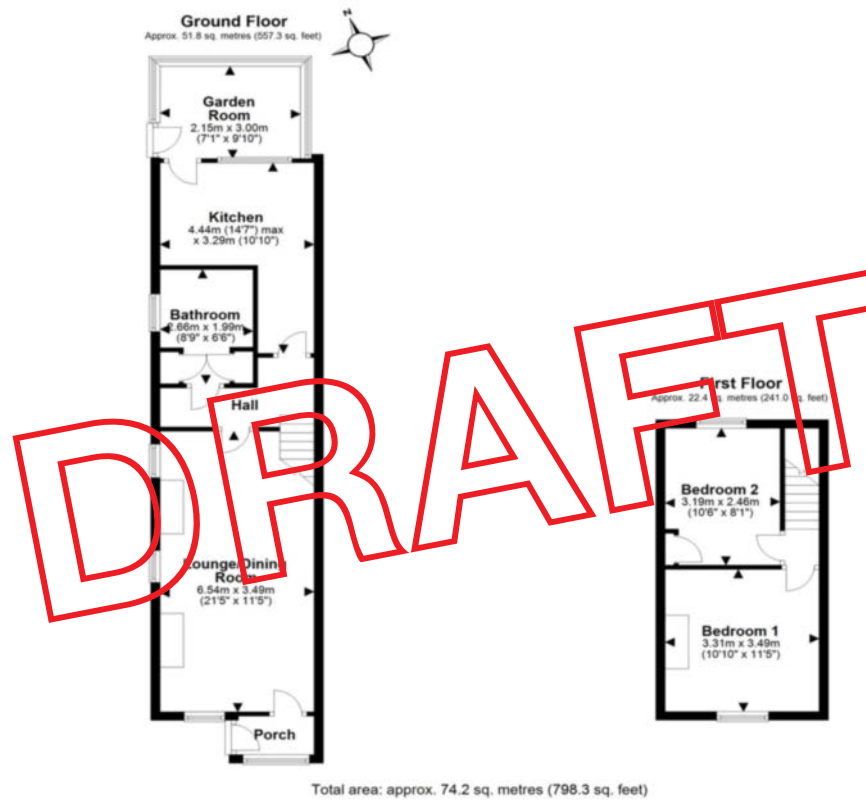

NOTICE Gascoigne Halman for themselves and for the vendors or lessors of this property whose agents they are give notice that: (i) the particulars are set out as a general outline only for the guidance of intending purchasers or lessees, and do not constitute, nor constitute part of, an offer or contract; (ii) all descriptions, dimensions, references to condition and necessary permissions for use and occupation, and other details are given in good faith and are believed to be correct but any intending purchasers or tenants should not rely on them as statements or representations of fact but must satisfy themselves by inspection or otherwise as to the correctness of each of them; (iii) no person in the employment of Gascoigne Halman has any authority to make or give any representation or warranty whatever in relation to this property.

FRODSHAM OFFICE

01928 739777

frodsham@gascoignehalman.co.uk

Pollard Building, Church Street, Frodsham, WA6 7DW

**GASCOIGNE
HALMAN**