



Townsend Street, Worcester, WR1 3JQ

**SHELDON
BOSLEY
KNIGHT**

LAND AND
PROPERTY
PROFESSIONALS

Property Description

A period terraced home offering well proportioned and versatile accommodation over three floors, situated within the popular and sought-after residential area of Barbourne, Worcester. The location provides easy access to local shopping facilities, the city centre, national road and rail networks.

The accommodation in brief comprises:

- Reception Hall
- Lounge
- Dining Room
- Kitchen
- Basement/Cellar
- Three Bedrooms, all doubles.
- Family Bathroom with bath and separate shower

Outside to the front of the property is a walled fore garden with a gated pathway leading to the front door. To the rear of the property is a mature private predominately lawned garden with shrub beds/borders, paved patio areas, outside WC and brick store room. Pedestrian rear access.

Services: All mains services are connected. Central heating is installed.





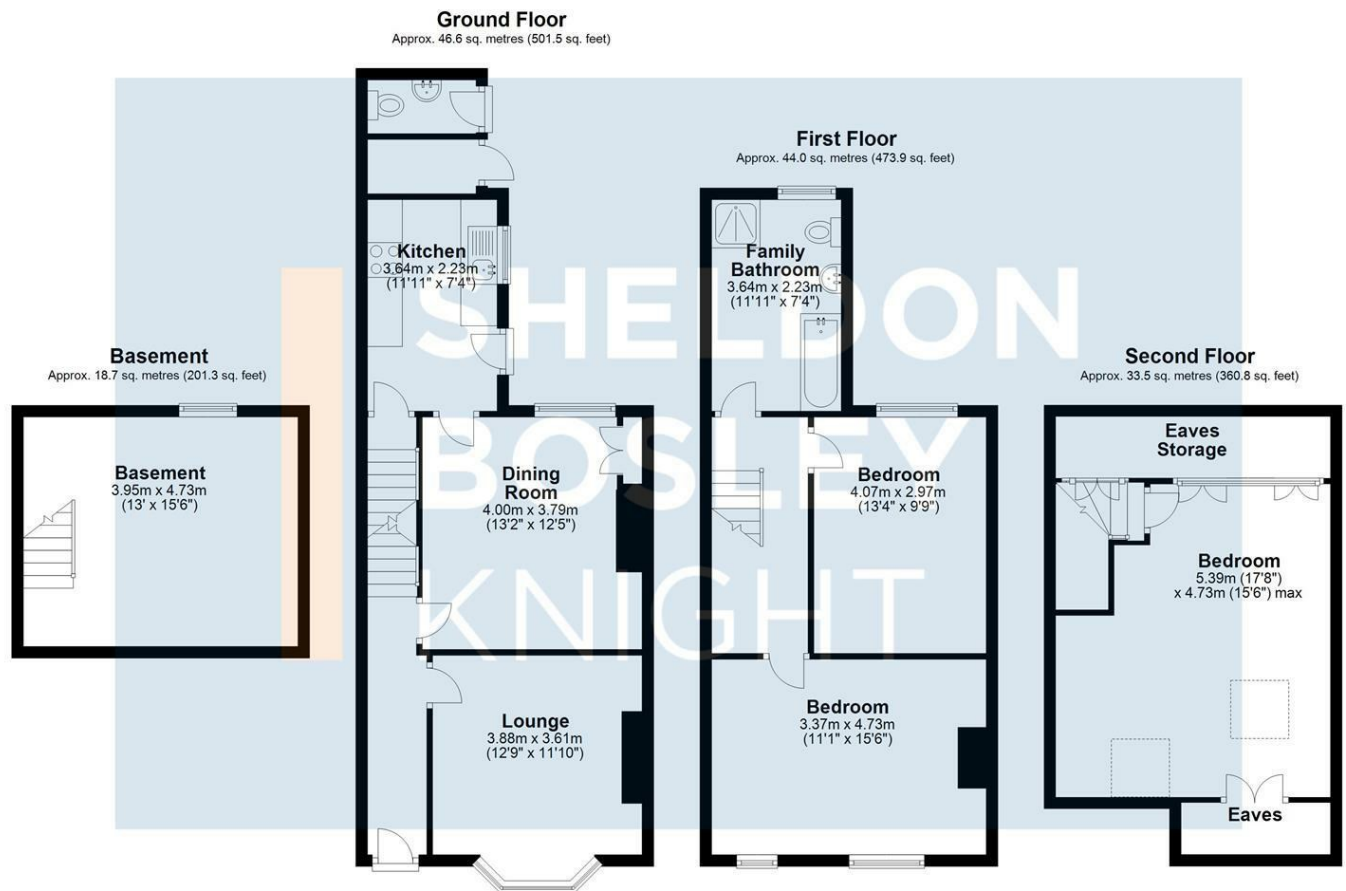

Total area: approx. 142.8 sq. metres (1537.5 sq. feet)

All efforts have been made to ensure that the measurements on this floorplan are accurate however these are for guidance purposes only. Plan produced using PlanUp.

Key Features

- A period terraced home with far reaching views
- Well proportioned, well presented and versatile accommodation
- Popular & sought after quiet residential area
- Period features
- Private mature garden
- Central heating
- Easy access to local shopping facilities & the city centre
- Viewing highly recommended

Guide Price
£325,000

EPC Rating - D

Tenure - Freehold

Council Tax Band - C

Local Authority -
Worcester City Council

We routinely refer clients to both our recommended Legal Firm and a panel of Financial Services Providers. It is your decision whether you choose to deal with these companies. In making that decision, you should know that we receive a referral fee